

## Construction Specifications

### Doors and Drawer Fronts:

Doors on the Value line are made of solid wood rails with a MDF/veneered center panel to reduce the possibility of shrinkage; drawer fronts differ by door style and are either solid wood rails with a veneered recessed panel or a solid wood slab.

### Hallmark Door Series:

The 5 piece Hallmark modified full overlay door has a 1/2" thick MDF/plywood veneered center panel captured in a 3/4" x 2 1/4" mortise and tenon solid wood frame and is complimented with a 5 piece recessed panel drawer front. The overlay on top of all wall cabinets has been modified to accept a crown moulding.

### Landmark Door Series:

The 5 piece Landmark traditional overlay door has a 1/2" thick MDF/plywood veneered raised center panel captured in a 3/4" x 2" solid frame and is complimented with a slab drawer front. All doors and drawer fronts are back beveled so no handles or knobs are necessary.

### Hinges:

6-way adjustable, concealed hinges open at 110° on all product lines. Compact Blumotion soft close hinges (Blum model #39C355B.20) supplied standard on Hallmark Frost only and available as an upgrade for other Hallmark lines.

### Drawers:

The Value line includes a 5/8" thick solid wood dovetail drawer box with a 3/8" plywood bottom, attached to under-mounted epoxy coated slides. Tandem plus Blumotion concealed drawer runners (Blum model #563H) supplied standard for Hallmark Frost only and available as an upgrade for other Hallmark lines.

### Shelving:

15mm (5/8") thick select veneered wood with matching wood edge-banding is used on all wall and base cabinetry where applicable. The adjustable shelves are supported by plastic self locking shelf clip.

### Backs, Tops and Bottoms:

1/2" thick veneered plywood with natural finished interiors. The backs are stapled and screwed into place for additional support.

### Face Frame:

3/4" x 1 1/2" solid wood stiles and rails jointed with glue and dowels. Back of face frames are grooved to accept side panels. The Hallmark face frame is engineered so that the bottom of all base and wall cabinets are flushed with the top inside edge of the face frame creating a custom look.

### Toe Kick:

1/2" x 4 1/2" select veneered plywood toe kick is added to each assembled cabinet and stained to match. Additional 8-foot lengths of 1/4" plywood toe kicks are available for those who do not wish to see the joints between cabinets.

### Panel Beams:

A panel beam is fastened into a dovetail groove at the top of each base cabinet to ensure a straight fully integrated side, and for use of support and mounting of a countertop.

Copyright © 2019 by Fabuwood Cabinetry Corp.

All rights reserved.

No part of this publication may be reproduced, distributed, or transmitted in any form or by any means, including photocopying, scanning, or other electronic or mechanical methods, including online sharing, without the prior written permission of Fabuwood Cabinetry Corp.

## Construction Specifications

- 1 Solid wood door and drawer front frames are mortise and tenon.
- 2 6-way adjustable concealed hinge with 110° opening capability.\*
- 3 5/8" solid wood dovetail drawer with a 3/8" plywood bottom with under mount epoxy coated slides.\*
- 4 2 1/2" interior drawer height.
- 5 3/4" x 1 1/2" solid wood face frame.
- 6 1/2" select veneered plywood back with a natural finished interior.
- 7 1/2" select veneered plywood side panels grooved into face frame.
- 8 15mm (5/8") select veneered plywood adjustable shelving with matching wood veneer edge banding.
- 9 1/2" x 4 1/2" select veneered plywood toe kick stained to match exterior finish and attached to cabinet.
- 10 1 1/2" x 1/2" plywood panel beams dovetailed into the side panels for strength and stability.
- 11 Base cabinet has 1 1/8" deep shelf.

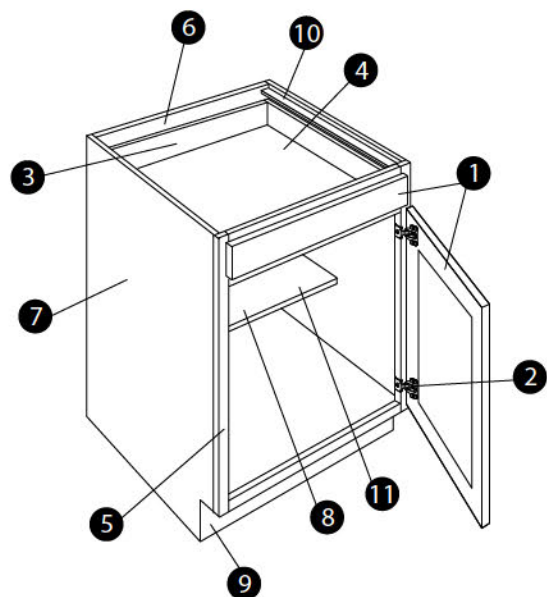
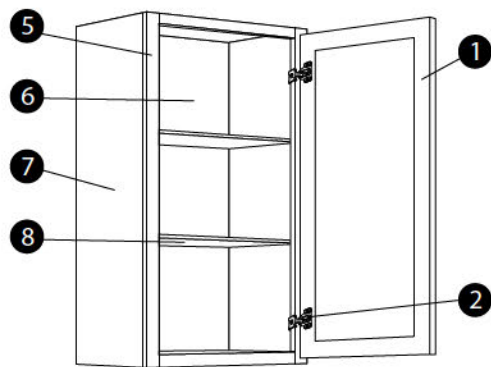

\* Hallmark Frost features:  
 Tandem plus Blumotion concealed drawer runners (Blum model #563H)  
 and Compact Blumotion soft close hinges (Blum model #39C355B.20)

## Door Style

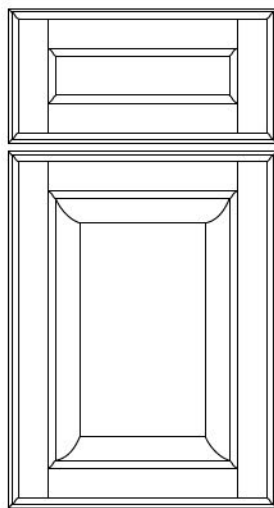

### HALLMARK

COLOR	FINISH	PRICE COLUMN
 Frost	Paint	N
Pecan	Stain	G
Brandy	Stain	G
Chestnut	Stain	M

- Full overlay door with modified overlay on wall cabinets.
- Frames are solid wood  $\frac{3}{4}$ " thick and  $2\frac{1}{4}$ " wide.
- Constructed with mortise and tenon joints.
- $\frac{1}{2}$ " thick MDF (Frost) or MDF/Plywood veneer (Pecan, Brandy & Chestnut) center panel.
- 5-piece recessed panel drawer front matches door design.
- Upgrade to Compact Blumotion Soft Close Hinges (Blum Model #39C355B.20) are available for a charge (comes standard in Hallmark Frost)
- Upgrade to Tandem Plus Blumotion Concealed Drawer Runners (Blum Model #563H) are available for a charge (comes standard in Hallmark Frost)

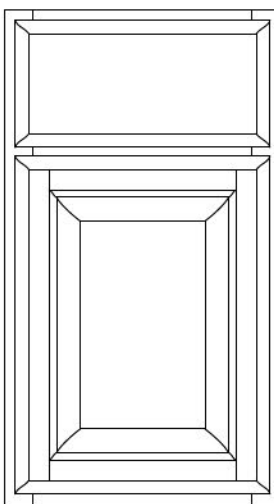

### LANDMARK

COLOR	FINISH	PRICE COLUMN
Natural	Stain	F
Brandy	Stain	F

- Traditional overlay door.
- Frames are solid wood  $\frac{3}{4}$ " thick and 2" wide.
- Constructed with mortise and tenon joints.
- MDF/Plywood veneered center panel is  $\frac{1}{2}$ " thick.
- Solid wood slab drawer front matches door edge design.
- Door and drawer fronts are back beveled to eliminate the need for a knob or handle.



## Order Information

Orders are accepted from accounts that are in good standing. We recommend placing your orders online for faster processing and delivery.

Orders may be submitted 24 hours a day via one of the following methods:

- 1) Online: Go to: <https://ezpricing.fabuwood.com/> to access Fabuwood's EZ Pricing Program. Orders exported from 20/20 & ProKitchen in an .xml file format can be uploaded directly into the EZ Pricing Program.
- 2) Email: [orders@fabuwood.com](mailto:orders@fabuwood.com)
- 3) Fax: 201-432-6055

Forms are processed in the order they were received. Fabuwood has a strict policy not to accept verbal orders at any time. Fabuwood customer service representatives will need your account number each time you contact us. Please have your information on hand.

### ORDER PLACEMENT:

- To place an order with Fabuwood, please use our interactive forms, found in the Dealer's Corner on our website. 20/20 & ProKitchen order forms are also accepted provided that Fabuwood nomenclature is used.
- Orders should be submitted with a cover page. Cover pages must include:
  - 1) Name of dealership
  - 2) Name of client/designer
  - 3) Purchase order number
  - 4) Total amount of pages in order
- According to your requested shipping timeframes, Fabuwood schedules orders based on when they were submitted. Should you have more than one order, it is best to batch them together and submit them to Fabuwood simultaneously.
- Please make sure to specify your shipment method at the time of purchase.
- Should your order need to be shipped to a location that differs from your usual delivery address, it must be noted at time of purchase along with a contact name and phone number for the location. Additional charges will apply.
- On average, orders are ready to leave Fabuwood's warehouse within 7 business days from confirmed and signed orders. For rush orders, please contact your customer service representative to discuss express fulfillment options. Rush orders will incur additional fees.
- For orders containing modifications or custom finishing, please expect additional business days for completion.
- Prices listed in latest spec book reflect Fabuwood's list price. Please contact your customer service representative for multiplier and freight pricing.

### ORDER PROCESSING:

- Upon receipt of your order, your assigned customer service representative will enter your request as a quote and will subsequently send it back for your approval.
- Please take the time to thoroughly proofread all Fabuwood quotes.

Make sure all information, including quantity, color, style, shipment method, and pricing are correct. Once quotes have been signed and resubmitted, Fabuwood is not responsible for typos or mistakes made.

- Should the order require any corrections or revisions, email them to [orders@fabuwood.com](mailto:orders@fabuwood.com) or fax to: 201.432.6055. Quotes are valid for 30 days only.
- Once revisions have been submitted, Fabuwood will send you a revised quote for a final approval. When we receive your signature we can begin processing your order.
- By signing the quote, the dealer takes full responsibility for any and all errors on order forms.
- Once quotes are signed and returned you will receive an order confirmation email which will include your order's ESD. ESD's are determined by the date the order will ship out or be available for pickup. For orders entered online, you can select an ESD based on your schedule. However, once an ESD is selected, the order will not be ready prior to the selected date.
- Order pickups must be scheduled one business day in advance by no later than 3pm EST. To schedule a pickup, please contact the pickup department at 201-432-6555 ext #372.
- Orders not picked up after 4 weeks will be stored at the dealer's expense. No additional orders will be released until storage fees have been paid, or order is picked up. Storage fees will accrue on a monthly basis at the rate of \$50 per palette.
- If you would like your order to be ready later than the regular ESD, please make a note on your order to avoid storage fees.

### ORDER REVISION PROCEDURES:

- Once a quote has been approved, any revisions or cancellations will result in restocking fees. Also, modified/custom items cannot be revised or canceled once approved.
- Verbal cancellations or revisions are not accepted at any time.
- Merchandise that has left Fabuwood's facilities cannot be returned or exchanged.

### SHIPPING SHORTAGES & DAMAGES:

Order shortages such as missing items and/or any visible shipping damages must be noted on the shipping receipt and signed by both the driver and the recipient. It is then the customer's responsibility to notify Fabuwood of any such issues within 24 hours of accepting the delivery. Any orders accepted and signed by the customer without any such note, will be considered complete. All other shipping damages must be claimed by the customer within 5 days. All items that have been installed and/or are not in their original packaging cannot be claimed as damaged.



# Order Form

## DOOR STYLE:

### HALLMARK

- ☐ FROST  
☐ PECAN  
☐ BRANDY  
☐ CHESTNUT

### LANDMARK

- ☐ NATURAL  
☐ BRANDY

## ORDER TYPE:

- ☐ DELIVERY ☐ ASSEMBLED  
☐ PICK UP ☐ KNOCK DOWN

## ACCOUNT INFO:

COMPANY NAME:

CONTACT:

PURCHASE ORDER #:

DATE:

REQUESTED SHIP DATE:

PHONE:

FAX:

E-MAIL:

SHIP TO:

SPECIAL INSTRUCTIONS:

☐ I WOULD LIKE THIS ORDER TO BE READY LATER THAN THE  
REGULAR ESD: \_\_\_\_\_ (DATE)

ORDERS THAT HAVE NOT BEEN ACCEPTED AFTER 4 WEEKS WILL BE STORED  
AT DEALERS EXPENSE.

If more than 35% of cabinet sides on the order are selected as  
exposed, a \$25 fee will be applied to each exposed side from the  
6th cabinet onward (fee does not apply to the first five cabinets)

	QTY	ITEM CODE	PRICE	HINGE		FINISH	
				L	R	L	R
1							
2							
3							
4							
5							
6							
7							
8							
9							
10							
11							
12							
13							
14							
15							
16							
17							
18							
19							
20							
21							
22							
23							
24							
25							
26							
27							
28							
29							
30							
31							
32							
33							
34							
35							
36							

TOTAL PIECE COUNT

TOTAL LIST

\$

MULTIPLIER

%

TOTAL COST

\$

## Sales Tools

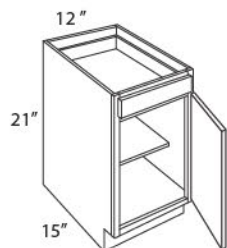
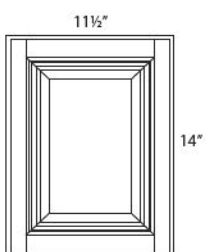
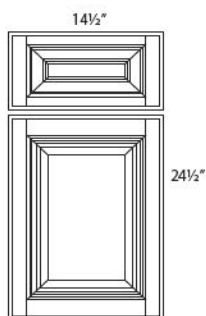

### DOOR SAMPLES WITH DRAWER FRONT

ITEM	DESCRIPTION	LIST PRICE
SDHF	HALLMARK FROST	65
SDHP	HALLMARK PECAN	65
SDHB	HALLMARK BRANDY	65
SDHC	HALLMARK CHESTNUT	65
SDLN	LANDMARK NATURAL	65
SDLB	LANDMARK BRANDY	65

### SMALL DOOR SAMPLES

ITEM	DESCRIPTION	LIST PRICE
SDHF-2	HALLMARK FROST	49
SDHP-2	HALLMARK PECAN	49
SDHB-2	HALLMARK BRANDY	49
SDHC-2	HALLMARK CHESTNUT	49
SDLN-2	LANDMARK NATURAL	49
SDLB-2	LANDMARK BRANDY	49

### MINI BASE & WALL SAMPLES

ITEM	DESCRIPTION	LIST PRICE
MBS	BASE SAMPLE 12"W X 21"H X 15"D	210

- Available in Hallmark Pecan finish only.

### SPECIFICATION

ITEM	DESCRIPTION	LIST PRICE
SPEC BOOK	SPEC BOOK - BINDER & INSERTS	81

### LITERATURE

ITEM	DESCRIPTION	LIST PRICE
TFB	ALL LINES TRI-FOLD BROCHURE (PACK OF 25)	25
SGB18	STYLE GUIDE BROCHURE (PACK OF 10)	25
ACCB	ACCESSORIES BROCHURE (PACK OF 20)	40



## Sales Tools



### MOLDING CHAIN

ITEM	DESCRIPTION	LIST PRICE
MLK-VALUE	COMPLETE CHAIN OF VALUE MOLDINGS	97

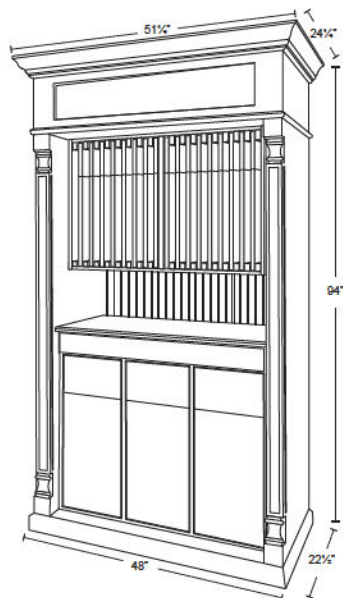

### SELLING CENTER

ITEM	DESCRIPTION	COST PRICE
FSC	FABUWOOD SELLING CENTER	1250



### COLOR BLOCKS

ITEM	DESCRIPTION	COST PRICE
COLOR BLOCK	BOX OF COLOR BLOCKS	25

## Modifications

### CUT ITEMS

ITEM	DESCRIPTION	LIST
CUT-BASE	Reduce depth of base cabinet (min. depth 12")	291
CUT-DBASE	Reduce depth of drawer base cabinet (min. depth 12")	405
CUT-SBASE	Reduce depth of sink base cabinet (no min.)	195
CUT-WALL	Reduce depth of wall cabinet (no min.)	243
CUT-TALL	Reduce depth of tall cabinet (no min.)	565
CUT-DOOR	Cut out center panel of door for glass insert (per door, glass not included)	163
CUT-COLUMN	Reduce depth of column (specify depth)	210
CUT-BASE HEIGHT	Reduce height of base cabinet by cutting off top drawer (total base height: 28½")	242
CUT-TK	Reduce toe kick height (no min.)	97
CUT-PANEL	Cut down a panel to any size	65/Pc.
CUT-ROD	Reduce depth of rollout drawer (specify depth of cabinet)	100

### PIPE CHASE

ITEM	DESCRIPTION	LIST
CHASE-BASE	Make chase in base cabinet	485
CHASE-DBASE	Make chase in drawer base cabinet	700
CHASE-WALL	Make chase in wall cabinet	259
CHASE-TALL	Make chase in tall cabinet	727
CHASE-CORNER	Make chase in corner cabinet (WDC, WPC & ERB only)	968

*Must supply a drawing for all chase modifications.*

### CUSTOMIZATIONS

ITEM	DESCRIPTION	LIST
CREATE-RETURN WALL	Create a return wall filler up to 6"W x 15"D x 42"H (materials incl.)	375
CREATE-RETURN TALL	Create a return tall filler up to 6"W x 30"D x 96"H (materials incl.)	693
CREATE-COLUMN BASE	Create a 3" column up to 30"D by 34½"H	645
CREATE-COLUMN WALL	Create a 3" column up to 15"D x 42"H	484
CREATE-COLUMN TALL	Create an oversized column	1161
HAMPER	Install door mounted pull out wood hamper in cabinet (cabinet not incl.)	565
BMC24	Create Base Microwave cabinet from a DB24 cabinet (cabinet not incl.)	439

### MODIFICATIONS

ITEM	DESCRIPTION	LIST
REMOVE-DRAWER	Remove cabinet drawer to create false drawer front	50
CLOSE-BLIND	Close open section of a blind wall or base cabinet	81
ATTACH-TK	Attach toe kick on wall cabinet	97
ATTACH-TK NO SEAM	Attach toe kick on wall cabinet finished side, with no seam on side panel	300



## Modifications

### MODIFICATIONS CONT.

ITEM	DESCRIPTION	LIST
RECESS-TK	Recess toe kick of base cabinet (must supply a drawing)	163
EDGE-BAND	Additional edge banding (price per linear foot)	7
PEN-CABINET	Create a peninsula cabinet from 2 cabinets (cabinets not incl.)	323
INCREASE-WALL	Increase depth on wall cabinet	QUOTE
MATCH-INTERIOR	Stain interior of cabinet to match exterior	QUOTE
SQ BOTTOM	Square bottom shelf for open end cabinet to enable light rail molding	81
FLUSH-BASE	Flush the side of a base cabinet (per side)	266
FLUSH-WALL	Flush the side of a wall cabinet (per side)	224
FLUSH-TALL	Flush the side of a tall cabinet (per side)	449
FLUSH-TOE KICK	Flush the toe kick of a base cabinet bringing the toe to front (sides not finished)	145
FULL-DOORS	Create a full height door base cabinet from 2 cabinets (cabinets not incl.)	100
FULL-DOORS (Hallmark B9-B21)	Create full height door base cabinet by cutting rail & adding full height door (door not incl.)	136

### UPGRADES

ITEM	DESCRIPTION	LIST
INSTALL-ACCES	Install any accessory in a cabinet (accessories not incl.)	QUOTE
GLAZE	Custom glazes available for a charge	20%
HIGH-SHEEN	Finish any cabinet with a high sheen	20%
BLUM-HINGE	Upgrade hinge to Blum soft close hinge, 1¼" overlay (per hinge)	10
BLUM-CORNER HINGE	Upgrade corner cabinet hinge to Blum soft close hinge, ¾" overlay (per hinge)	10
BLUM SLIDE 9"	Upgrade drawer slide to Blum soft close slide (per drawer)	123
BLUM SLIDE 12"	Upgrade drawer slide to Blum soft close slide (per drawer)	123
BLUM SLIDE 15"	Upgrade drawer slide to Blum soft close slide (per drawer)	123
BLUM SLIDE 18"	Upgrade drawer slide to Blum soft close slide (per drawer)	123
BLUM SLIDE 21"	Upgrade drawer slide to Blum soft close slide (per drawer)	123

### LOOSE PARTS

ITEM	DESCRIPTION	LIST
SHELF-WALL	Loose 12" deep shelf (specify cabinet size)	70
SHELF-BASE	Loose 24" deep shelf (specify cabinet size)	135
SHELF-DSB	Loose shelf (specify cabinet size)	246
SHELF-TALL	Loose 24" deep shelf (specify cabinet size)	135
SKIN-BASE*	¼" finished plywood to flush side of cabinet	165
SKIN-WALL	¼" finished plywood to flush side of cabinet	110
SKIN-TALL*	¼" finished plywood to flush side of cabinet	273

\* Toe kick to be cut at job site

Many more modifications available- please contact your customer service rep.



## 5 Year Limited Warranty

### COVERAGE OF WARRANTY

Fabuwood Cabinetry Corp ("Fabuwood") is pleased to provide the following limited warranty on all cabinets imported to and assembled and sold in the United States by Fabuwood. This warranty does not cover cabinets sold or shipped outside of the United States. This limited warranty is subject to all limitations, exclusions, disclaimers and procedures set forth herein. Fabuwood warrants to the original purchasing consumer that all cabinets purchased from Fabuwood will be free from all unnatural defects in material and workmanship in accordance with the Fabuwood quality standards sheet under normal residential use for 5 years from the date of the original purchase or as long as the original purchasing consumer owns the home in which such cabinets are installed, whichever is less. This warranty is non transferable to subsequent owners of the home.

### EXCLUSIONS

THIS WARRANTY SUPERSEDES ANY AND ALL PREVIOUS WARRANTIES BY FABUWOOD AND CONSTITUTES THE EXCLUSIVE REMEDY AGAINST FABUWOOD FOR ALL DEFECTS, DAMAGES AND WORKMANSHIP. THERE ARE NO IMPLIED WARRANTIES EXTENDING BEYOND THE TERMS OF THIS WARRANTY. FABUWOOD SHALL NOT BE LIABLE FOR ANY INDIRECT, SPECIAL, PUNITIVE, INCIDENTAL OR CONSEQUENTIAL COSTS, EXPENSES OR DAMAGES. THIS WARRANTY GIVES YOU SPECIFIC LEGAL RIGHTS, AND YOU MAY ALSO HAVE OTHER RIGHTS, WHICH VARY FROM STATE TO STATE. IT IS POSSIBLE THAT ONE OR MORE OF THE LIMITATIONS AND EXCLUSIONS IN THIS WARRANTY MAY NOT APPLY TO YOU. THIS WARRANTY APPLIES ONLY TO FABUWOOD PRODUCTS PURCHASED ON OR AFTER MARCH 15, 2014

### LIMITATIONS

This warranty shall become void if the cabinets, cabinetwork, drawer slides or hinges are modified from its original form, improperly installed or damaged prior to or during the installation, or used in any way other than for residential purposes. This warranty covers only parts and materials of the cabinets as supplied by Fabuwood. This warranty does not cover any products used or installed in connection with cabinets, such as gas or electric appliances, countertops, or plumbing fixtures. This warranty does not apply to products installed in locations that do not maintain year-round environmental controls. This warranty shall not apply to damages caused by transportation, storage, dirt, chemicals, exposure to moisture, humidity or excessive heat or cold, nor does it cover defects arising from normal wear and tear, misuse, neglect, accidents, alterations, improper use or failure to maintain properly, house settling, or acts of God. No installer, retailer, distributor, agent or employee of Fabuwood has the authority to alter the obligations or limitations in this warranty.

### QUALITY STANDARDS

This warranty covers all damages and unnatural defects that are deemed as such under the current Fabuwood Quality Standards sheet. The current Fabuwood Quality Standards sheet is available for download in the dealer login section of the Fabuwood website ([www.fabuwood.com](http://www.fabuwood.com)), which should be reviewed at each time a claim for warranty service is being considered. Fabuwood reserves the right to modify or change the Fabuwood Quality Standards sheet at any time without notice.

### DISCLAIMERS

The following is a brief recap of some of the characteristics of the wood and finishes on the cabinets you are about to purchase. Please read them carefully. If some of these characteristics concern you, please choose something else. We bring these characteristics to your attention so you will realize that Fabuwood will not be held responsible for these variations in your cabinetry. It is important

to note that wood products claimed as defective are most often the result of atmospheric conditions such as excess moisture and humidity. Fabuwood strongly recommends testing the intended location of the products for such conditions prior to installation.

**WOOD AND COLOR VARIATIONS:** Wood is a product of nature, and since no two trees are alike, cabinets may vary in color, texture and grain. Wood characteristics naturally occurring such as variations in color, grain, mineral streaks, pinholes and knots are not considered defects. Color variations in cabinets are also a natural occurrence due to species, age, character of cabinets, and exposure to UV light and sunlight. For these reasons, new and/or replacement cabinets may not match display samples and/or existing cabinets. This may result in overall color variations, but is not considered a defect.

**WOOD DOORS:** Wood by nature will undergo expansion and contraction movements year after year as it compensates and adjusts to ever changing atmospheric humidity and temperature conditions. It is very common for center panels on doors to shrink, expand or move during these transitions. Typically, the panel will return to its normal position within a year once it has adjusted to seasonal changes. It is for these same reasons that it is very common for doors to warp during these periods. Doors that are warped up to 1/4" are not considered defective. Note: It is advisable to check if the door was properly installed, since doors that appear warped are very often the result of improper installation.

**PAINTED FINISHES:** Plywood is a non-porous, smooth grained wood. Additionally, wood by nature undergoes periods of expansion and contraction while it adjusts to atmospheric conditions mentioned above. As such, finish stress lines may become visible on painted cabinets especially at the joints. Any such occurrence is not considered a defect.

**GLAZED FINISHES:** A glazed finish by character is an uneven finish. Some edges and profiles will have heavier hang up than others and glazing may vary cabinet to cabinet, door to drawer and item to item. This may result in overall color variations but is not considered a defect.

### WARRANTY PERFORMANCE

If a defect does occur within the terms and conditions of this warranty such defective part will be repaired or replaced by Fabuwood at its sole discretion. Fabuwood will not provide or pay for the cost of removal of defective product, transportation of defective, repaired or replaced product or installation of repaired or replaced product. Fabuwood will not be responsible for any shipping damages to the defective, replaced or repaired product. If defective item has been discontinued or is not available at the time, Fabuwood reserves the right to replace the item with the most similar item available in Fabuwood's inventory at that time. Fabuwood cannot guarantee that the finish of any replacement will exactly match the finish and appearance of the defective item due to the natural ageing process of the wood and finishes of the cabinets. Fabuwood may require at its discretion that the customer submit a clear photo, or that a company representative view the item being claimed before honoring this warranty.

### CLAIMS

To submit a claim covered under this warranty, the original proof of purchase or a copy must be provided. Please email all documents to [customerservice@fabuwood.com](mailto:customerservice@fabuwood.com).

### NOTE

Please do not send back any items to Fabuwood prior to receiving proper authorization from customer service. Fabuwood takes no responsibility on any items sent back to Fabuwood without proper return authorization.



---

## Dealer Product & Warranty Awareness Form

I have carefully read and understand the entire warranty provided by Fabuwood and have been provided the opportunity to ask questions of, and receive answers from Fabuwood concerning the terms and conditions set forth in the warranty, including, but not limited, to the extent of the coverage therein.

I hereby accept full responsibility (a) to truthfully and accurately represent Fabuwood, and (b) to make sure that anyone selling Fabuwood cabinets under my dealership will properly explain the terms and conditions to the consumer.

I understand that Fabuwood is not liable for any claims made by any consumer that are not covered under the warranty and that I will be solely responsible for any and all losses and expenses arising from such claims. I agree to indemnify, defend and hold Fabuwood harmless from and against such losses and expenses, including, but not limited to, reasonable attorney's fees and expenses.

---

Printed Name

---

Signature

---

Company Name

---

Company Address

---

Witness Printed Name

---

Witness Signature

---

Date

---

## Consumer Product & Warranty Awareness Form

I have read the entire warranty provided by Fabuwood and I understand the terms and conditions set forth by Fabuwood as well as the extent of the coverage of the warranty.

I understand and agree that (Dealer's name) \_\_\_\_\_ will not be liable for any defects and claims that are not covered under the warranty and that I will not hold (Dealer's name) \_\_\_\_\_ responsible for any such defects.

\_\_\_\_\_  
Printed Name

\_\_\_\_\_  
Signature

\_\_\_\_\_  
Company Name

\_\_\_\_\_  
Company Address

\_\_\_\_\_  
Witness Printed Name

\_\_\_\_\_  
Witness Signature

\_\_\_\_\_  
Date



## Wall Cabinets

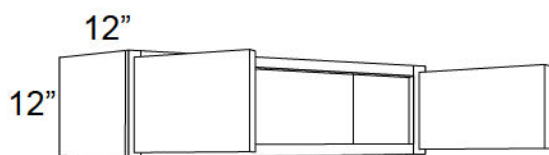

### 12" HIGH

ITEM	F	G	M	N
W3012	172	188	207	232
W3612	190	210	231	259

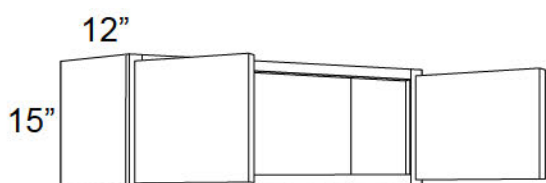

### 15" HIGH

ITEM	F	G	M	N
W2115*	158	173	190	213
W2415	166	183	201	225
W3015	168	185	204	228
W3315	190	208	229	256
W3615	201	221	243	272

\* One door only

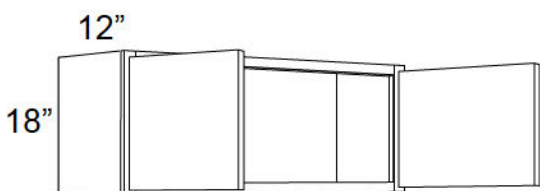

### 18" HIGH

ITEM	F	G	M	N
W2118*	176	194	213	239
W2418	181	200	220	246
W3018	183	202	222	249
W3318	208	229	252	282
W3618	215	237	261	292

\* One door only

## Wall Cabinets

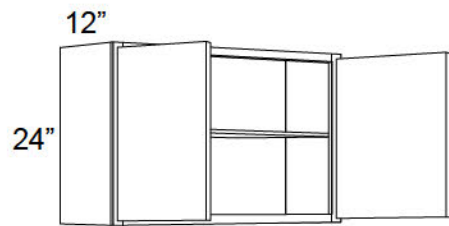

### 24" HIGH

ITEM	F	G	M	N
W2424	206	226	249	279
W3024	224	247	272	305
W3324	245	268	295	330
W3624	268	294	323	362

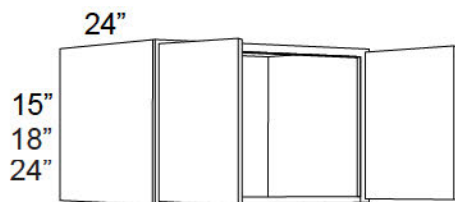

### 24" DEEP

ITEM	F	G	M	N
W301524	223	245	270	302
W331524	265	434	444	497
W361524	289	318	350	392
W301824*	265	288	317	355
W331824	289	471	518	580
W361824*	316	347	382	428
W302424♦	286	315	347	389
W332424♦	321	494	474	530
W362424♦	333	366	403	451

\* Not available in Landmark Brandy

♦ Has 1 shelf

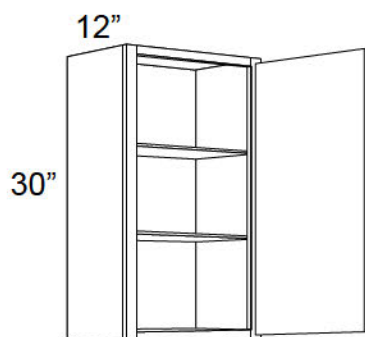

### 30" HIGH

ITEM	F	G	M	N
W0930	135	148	163	183
W1230	143	157	173	194
W1530	166	182	200	224
W1830	183	202	222	249
W2130	206	226	249	279

• Peninsula cabinet modification pg. VIII

## Wall Cabinets

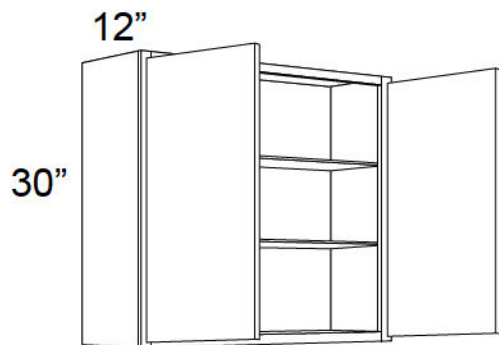

### 30" HIGH

ITEM	F	G	M	N
W2430	221	243	267	299
W2730	250	276	304	340
W3030	258	284	312	349
W3330	281	309	340	381
W3630	291	321	353	395

- Peninsula cabinet modification pg. VIII

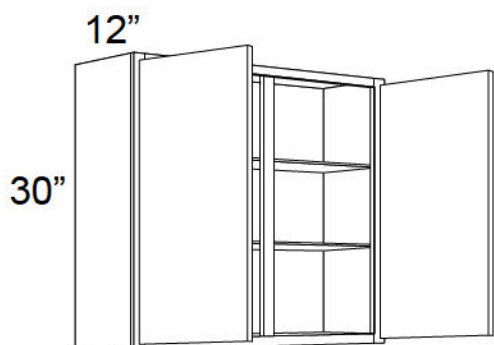

### 30" HIGH

ITEM	F	G	M	N
W3930	313	345	380	426
W4230	356	392	431	483
W4830♦	423	N/A	N/A	N/A

- ♦ Available only in Landmark
- 7/8" center stile
- Peninsula cabinet modification pg. VIII

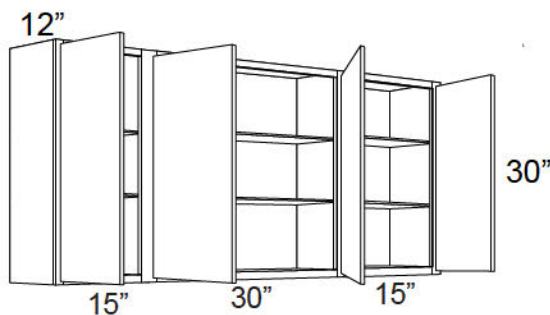

### 30" COMBINATION

ITEM	F	G	M	N
W6030♦	475	N/A	N/A	N/A

- ♦ Available only in Landmark



## Wall Cabinets

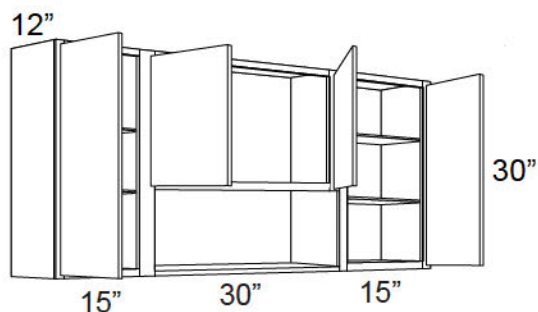

### 30" COMBINATION

ITEM	F	G	M	N
W6030-O♦	437	N/A	N/A	N/A

♦ Available only in Landmark

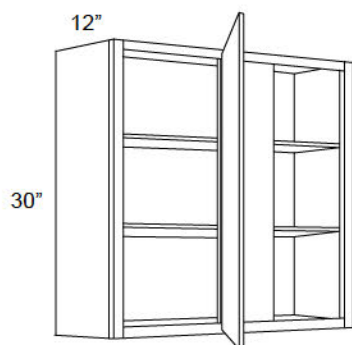

### 30" SINGLE DOOR BLIND

ITEM	F	G	M	N
WBC2430	255	280	308	345
WBC3030	298	327	360	403
WBC3630	353	388	427	478

- Must use filler on adjacent side (not supplied)
- Measurements are rounded off to closest 1/8"

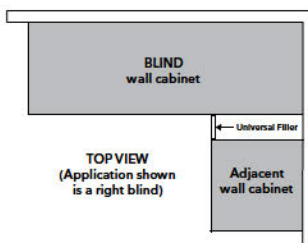

	Act.	Max	Hallmark Door	Landmark Door	Stile	Open
WBC2430	24"	27"	10 1/8"	8 3/4"	6"	7 3/4"
WBC3030	30"	33"	16 1/8"	14 1/2"	6"	13 3/4"
WBC3630	36"	39"	22 1/8"	20 1/2"	6"	19 3/4"

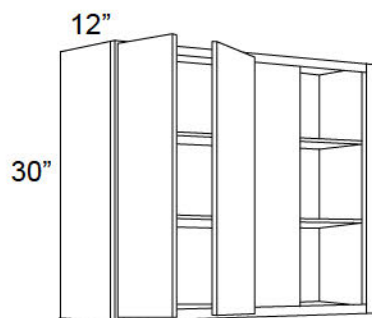

### 30" DOUBLE DOOR BLIND

ITEM	F	G	M	N
WBC4230	410	451	496	556

- Must use filler on adjacent side (not supplied)
- Measurements are rounded off to closest 1/8"

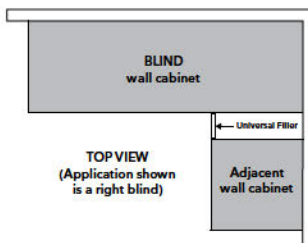

	Act.	Max	Hallmark Door	Landmark Door	Stile	Open
WBC4230	42"	45"	14 1/8"	13 3/4"	6"	25 1/2"

## Wall Cabinets

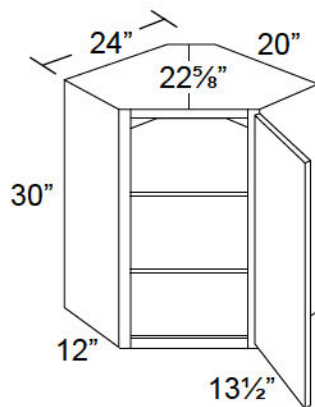

### 30" DIAGONAL CORNER

ITEM	F	G	M	N
WDC2430	327	360	396	444

- Uses  $\frac{3}{8}$ " overlay hinge
- Frame is flush with side panel
- For Lazy Susan see accessories on pg. 22

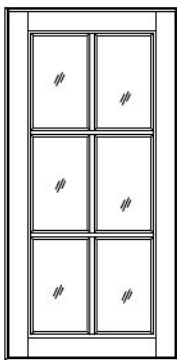

### 30" GLASS DOOR

ITEM	F	G	M	N
GD1230◇	N/A	N/A	N/A	95
GD1530	77	85	94	105
GD1830	92	100	110	123
GD2430◇	N/A	N/A	N/A	102
GDD2430*	81	90	99	111
GD3030◆	82	92	101	113
GD3630◆	100	104	114	128

- ◇ Available in Hallmark Frost only
- \*  $13\frac{1}{2}$ " wide for WDC2430 only
- ◆ Requires 2 per cabinet

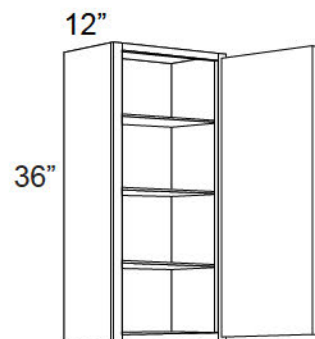

### 36" HIGH

ITEM	F	G	M	N
W0936	148	163	179	200
W1236	169	185	204	228
W1536	193	213	234	262
W1836	218	240	264	296
W2136	242	266	293	328

- Not available in Landmark Brandy
- Peninsula cabinet modification pg. VIII

## Wall Cabinets

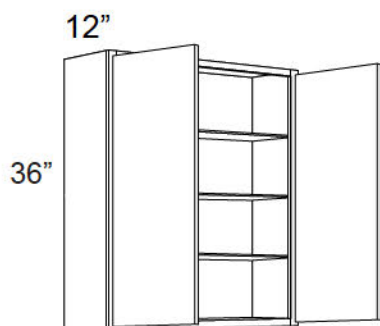

### 36" HIGH

ITEM	F	G	M	N
W2436	282	309	340	381
W2736	304	334	367	411
W3036	315	347	382	428
W3336	345	379	417	467
W3636	371	408	449	503

- Not available in Landmark Brandy
- Peninsula cabinet modification pg. VIII

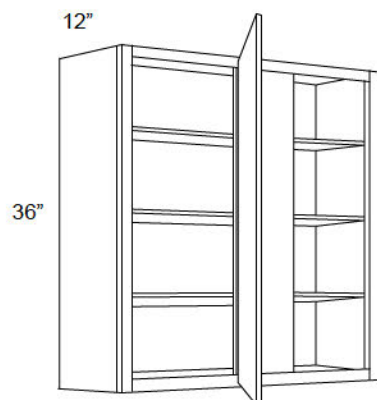

### 36" SINGLE DOOR BLIND

ITEM	F	G	M	N
WBC2436	340	374	411	460
WBC3636	392	431	474	531

- Not available in Landmark Brandy
- Must use filler on adjacent side (not supplied)
- Measurements are rounded off to closest 1/8"

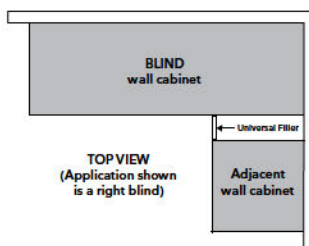

	Act.	Max	Hallmark Door	Landmark Door	Stile	Open
WBC2436	24"	27"	10 5/8"	8 3/4"	6"	7 3/4"
WBC3636	36"	39"	22 5/8"	20 1/2"	6"	19 3/4"

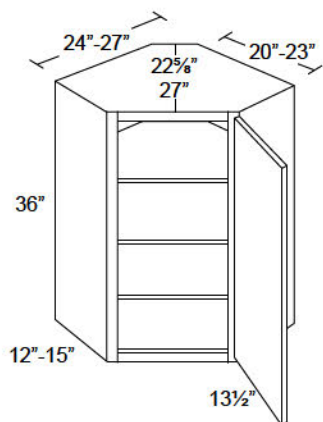

### 36" DIAGONAL CORNER

ITEM	F	G	M	N
WDC2436	402	441	485	543
WDC2736	482	514	565	633

- Not available in Landmark Brandy
- Uses 3/8" overlay hinge
- Frame is flush with side panel
- Lazy Susan pg. 28



## Wall Cabinets

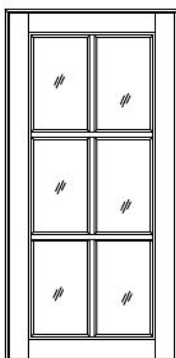

### 36" GLASS DOOR

ITEM	F	G	M	N
GD1236◇	N/A	N/A	N/A	116
GD1536	94	103	113	127
GD1836	112	122	134	150
GD2436◆◇	N/A	N/A	N/A	123
GDD2436*	99	109	120	134
GD3036◆	102	112	123	138
GD3636◆	120	127	140	157

- Not available in Landmark Brandy
- ◇ Available in Hallmark Frost only
- \* 13½" wide for WDC2436 & WDC2736 only
- ◆ Requires 2 per cabinet

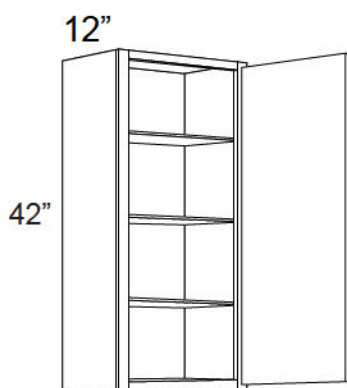

### 42" HIGH

ITEM	F	G	M	N
W0942	156	172	189	212
W1242	185	204	224	251
W1542	211	232	255	286
W1842	241	265	292	327
W2142	265	291	320	358

- Peninsula cabinet modification pg. VIII

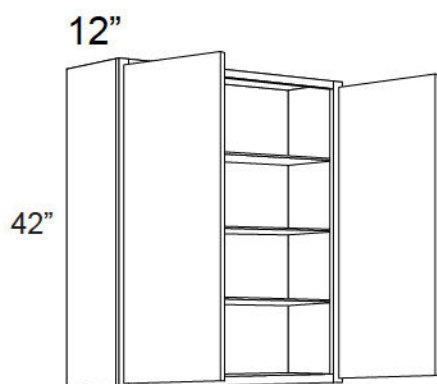

### 42" HIGH

ITEM	F	G	M	N
W2442	322	353	388	435
W2742	339	373	410	459
W3042	353	389	428	479
W3342	387	426	469	525
W3642	423	465	512	573

- Peninsula cabinet modification pg. VIII

## Wall Cabinets

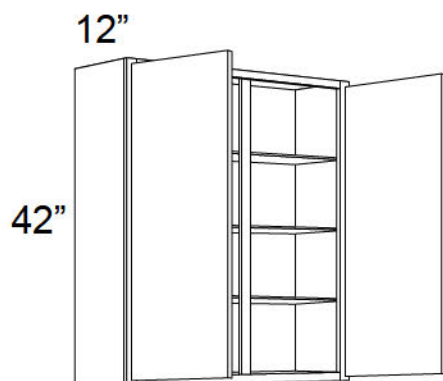

### 42" HIGH

ITEM	F	G	M	N
W3942	492	541	595	666

- $\frac{7}{8}$ " center stile
- Peninsula cabinet modification pg. VIII

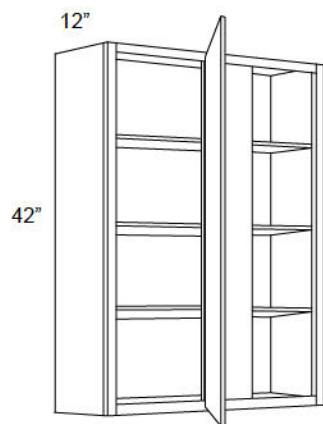

### 42" SINGLE DOOR BLIND

ITEM	F	G	M	N
WBC2442	396	436	480	538
WBC3642	417	458	504	564

- Must use filler on adjacent side (not supplied)
- Measurements are rounded off to closest  $\frac{1}{8}$ "

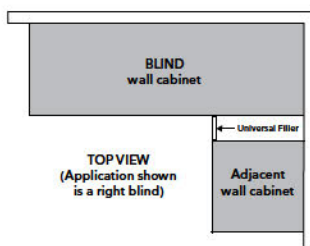

	Act.	Max	Hallmark Door	Landmark Door	Stile	Open
WBC2442	24"	27"	10 $\frac{1}{4}$ "	8 $\frac{3}{4}$ "	6"	7 $\frac{3}{4}$ "
WBC3642	36"	39"	22 $\frac{1}{2}$ "	20 $\frac{1}{2}$ "	6"	19 $\frac{1}{4}$ "

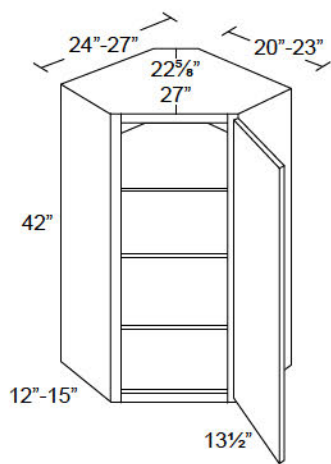

### 42" DIAGONAL CORNER

ITEM	F	G	M	N
WDC2442	451	496	546	612
WDC2742*	545	592	651	729

- \* Not available in Landmark Brandy
- Uses  $\frac{3}{8}$ " overlay hinge
- Frame is flush with side panel
- Lazy Susan pg. 28

## Wall Cabinets

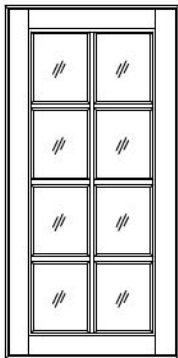

### 42" GLASS DOOR

ITEM	F	G	M	N
GD1242◇	N/A	N/A	N/A	141
GD1542	104	125	138	155
GD1842	124	137	151	169
GD2442◇◇	N/A	N/A	N/A	146
GDD2442*	111	121	133	149
GD3042◆	114	124	136	152
GD3642◆	132	142	156	175

◇ Available in Hallmark Frost only

\* 13½" wide for WDC2442 & WDC2742 only

◆ Requires 2 per cabinet

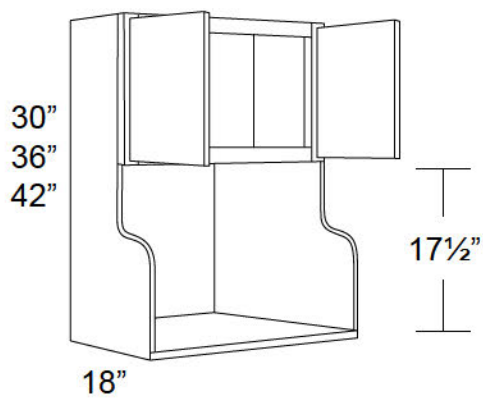

### MICROWAVE

ITEM	F	G	M	N
MW3030	391	432	475	532
MW3036*	403	445	490	549
MW3042	411	452	497	557

\* Not available in Landmark Brandy

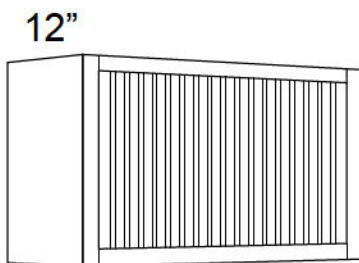

### PLATE RACK

ITEM	F	G	M	N
PR3018	425	425	468	500



## Wall Cabinets

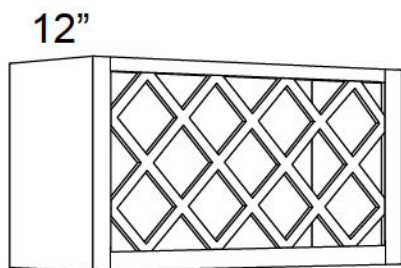

### WINE RACK

ITEM	F	G	M	N
WR3018	340	340	374	420

- Finished interior
- Cubes are 2¾" x 2¾" (fits 14 bottles)

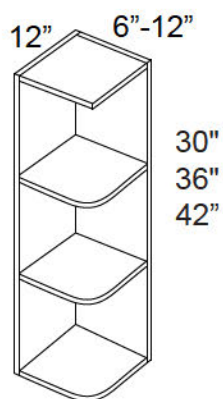

### OPEN END

ITEM	F	G	M	N
OE630	108	118	130	146
OE636*	130	143	157	176
OE642♦	144	159	175	196
OE1230	108	118	130	146
OE1236*	130	143	157	176
OE1242♦	144	159	175	196

- Comes as 12" (Fabuwood will cut to 6" at no charge)
- \* Not available in Landmark Brandy
- ♦ Has three shelves

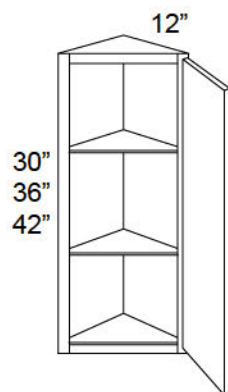

**HALLMARK FROST**

### ANGLE END

ITEM	F	G	M	N
WAE1230	N/A	N/A	N/A	288
WAE1236*	N/A	N/A	N/A	329
WAE1242*	N/A	N/A	N/A	378

- Can use glass door from a 30" wide wall cabinet - will require a 1" overlay hinge
- Blum soft close upgrade available
- Adjustable shelves
- \* Has three shelves

## Base Cabinets

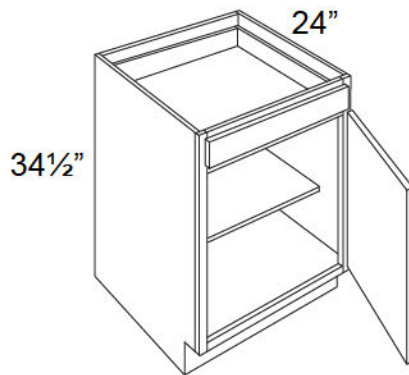

### SINGLE DOOR

ITEM	F	G	M	N
B09	194	213	234	262
B12	216	237	261	292
B15	228	251	276	309
B18	241	264	290	325
B21	266	292	321	360

- B09 accessories pg. 25
- Peninsula cabinet modification pg. VIII
- Roll Outs pg. 28

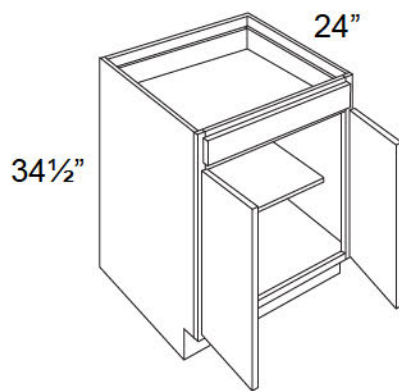

### DOUBLE DOOR

ITEM	F	G	M	N
B24	294	324	356	399
B27	327	360	396	444
B30	354	390	429	480

- Peninsula cabinet modification pg. VIII
- Roll Outs pg. 28

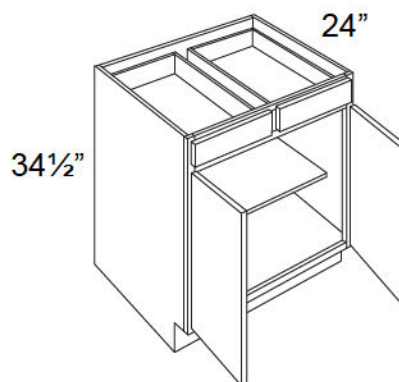

### DOUBLE DOOR & DRAWER

ITEM	F	G	M	N
B33	373	411	452	506
B36	392	432	475	532
B39*	415	457	503	563
B42*	455	499	549	615

- \* Has 3/8" center stile
- Roll Outs pg. 28

## Base Cabinets

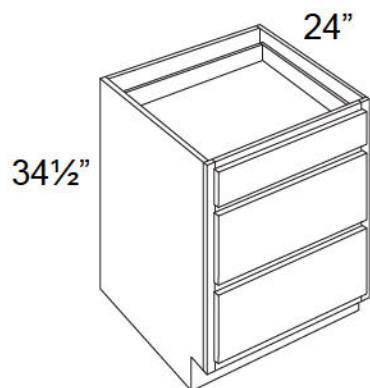

### DRAWER

ITEM	F	G	M	N
DB12	329	362	398	446
DB15	342	375	413	463
DB18	360	395	435	487
DB24	386	425	468	524
DB30♦	N/A	N/A	N/A	833
DB36♦	N/A	N/A	N/A	877

♦ Available in Hallmark Frost only

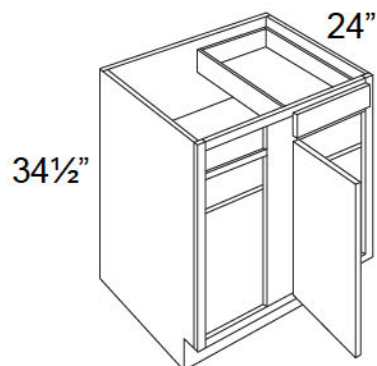

### BLIND

ITEM	F	G	M	N
BLB36/39	370	407	448	502
BLB42/45	418	460	506	567
BLB48/51	474	521	573	642

- Must use filler on adjacent side (not supplied)
- Measurements are rounded off to closest 1/8"

	Act.	Min.	Max.	Hallmark Door	Landmark Door	Stile	Open
BLB36/39	27"	36"	41 1/4"	10 1/2"	8 3/4"	8"	8"
BLB42/45	39"	42"	47 1/4"	15 1/4"	14 3/8"	9"	14"
BLB48/51	48"	48"	52"	21 1/4"	19 1/2"	7 1/4"	18 3/4"

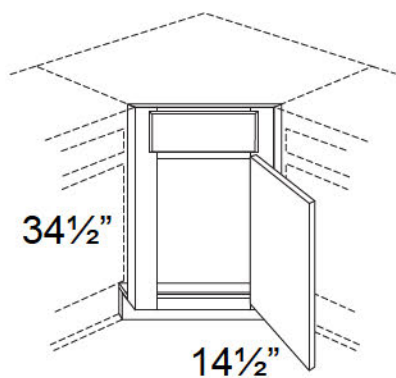

### DIAGONAL SINK FRONT

ITEM	F	G	M	N
DSF36*	127	140	154	172
DSFL36♦	64	103	103	103

- Uses 3/8" overlay hinge
- Tilt Out pg. 26
- \* DSF36 The sink front has a 17" face dimension.
- ♦ DSFL36 The floor must be ordered separately



## Base Cabinets

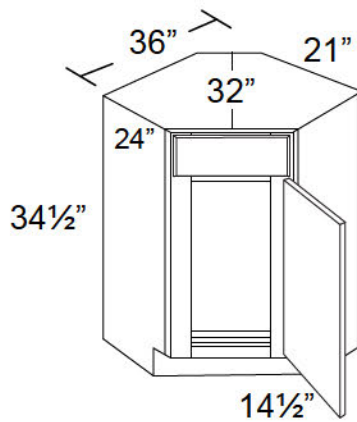

### DIAGONAL SINK

ITEM	F	G	M	N
DSB36	530	583	641	718

- Uses  $\frac{3}{8}$ " overlay hinge
- Tilt Out pg. 26

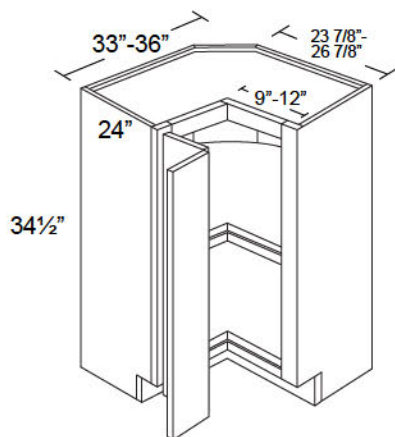

### LAZY SUSAN

ITEM	F	G	M	N
LSB33◇	N/A	N/A	N/A	826
LSB36	661	726	799	895

- ◇ Available in Hallmark Frost only
- HALLMARK: once assembled, door cannot be reversed
- Both wooden Lazy Susan trays rotate independently
- Center tray is mounted on 15mm ( $\frac{9}{16}$ ") adjustable shelf

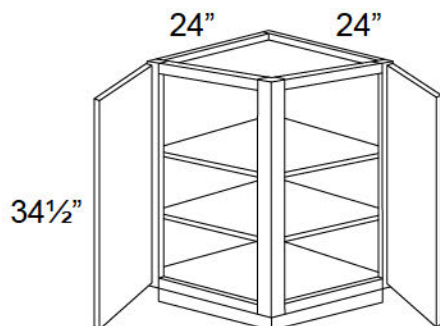

### RETURN ANGLE

ITEM	F	G	M	N
BRA24	347	384	422	473

- Hallmark door width: 17 1/2"
- Landmark door width: 15 5/8"
- Adjustable shelving

## Base Cabinets

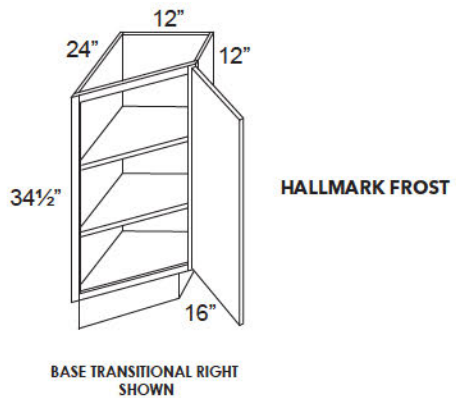

### TRANSITIONAL

ITEM	F	G	M	N
BTR12	N/A	N/A	N/A	336
BTL12	N/A	N/A	N/A	336

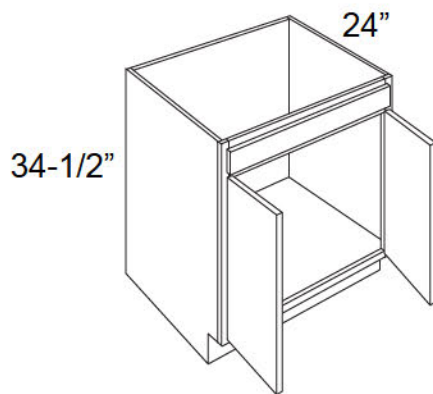

### SINK

ITEM	F	G	M	N
SB24◇	N/A	N/A	N/A	391
SB27	301	331	364	408
SB30	316	348	383	429
SB33	330	364	400	448

- ◇ Available in Hallmark Frost only  
 • Tilt Out pg. 26

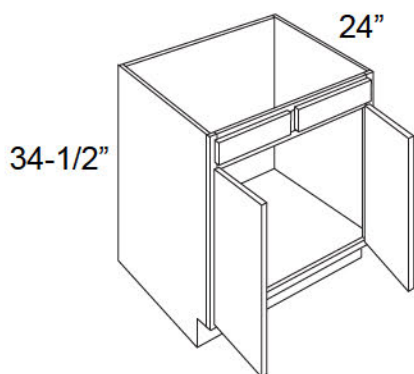

### SINK

ITEM	F	G	M	N
SB36	339	372	409	458
SB39	347	382	420	470
SB42	354	390	429	480
SB48*	428	N/A	N/A	N/A

- \* Only available in Landmark  
 • Tilt Out pg. 26

## Base Cabinets

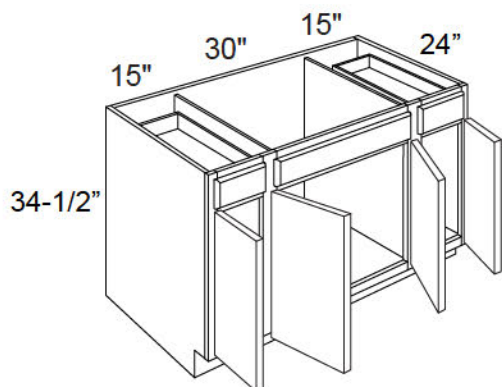

### COMBINATION SINK

ITEM	F	G	M	N
SB60	505	N/A	N/A	N/A

- Only available in Landmark
- Tilt Out pg. 26

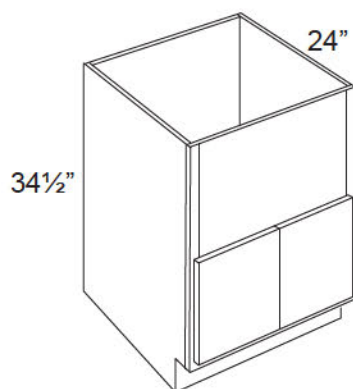

### FARM SINK

ITEM	F	G	M	N
FARM SINK 30	1081	1081	1081	1081
FARM SINK 33	1095	1095	1095	1095
FARM SINK 36	1107	1107	1107	1107

- Cut opening on job site
- Only sold assembled
- May have extended ETA
- Center panel is MDF material, slightly recessed from the frame.

*Note: To avoid damage please apply extra care when cutting the front panel.*



## Pantry Cabinets

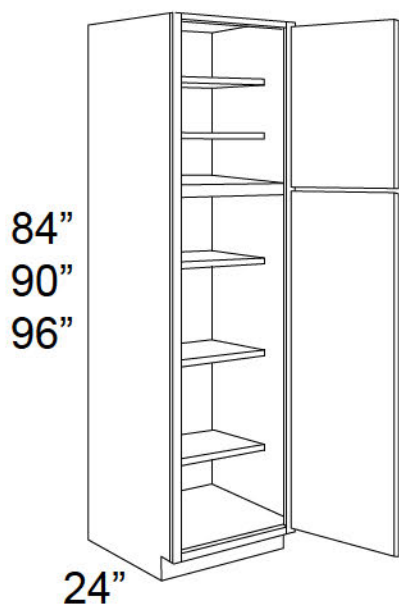

### SINGLE DOOR

ITEM	F	G	M	N
TP152484	671	739	813	911
TP182484	728	802	882	988
TP152490*	725	798	878	983
TP182490*	771	848	933	1045
TP152496	761	837	921	1032
TP182496	798	878	966	1082

- Upper cabinet height is equivalent to 30" high wall cabinet
- 84" high - 5 shelves
- 90" & 96" high - 6 shelves
- Shelves are 18" deep
- Roll Outs pg. 28
- \* Not available in Landmark Brandy

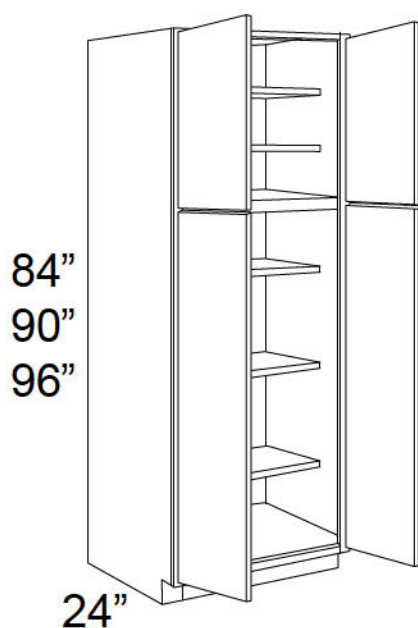

### DOUBLE DOOR

ITEM	F	G	M	N
TP242484	770	848	933	1045
TP302484◇	N/A	N/A	N/A	1118
TP242490*	818	900	990	1109
TP302490◇	N/A	N/A	N/A	1187
TP242496	850	935	1029	1152
TP302496◇	N/A	N/A	N/A	1233

- Upper cabinet height is equivalent to 30" high wall cabinet
- 84" high - 5 shelves
- 90" & 96" high - 6 shelves
- Shelves are 18" deep
- Roll Outs pg. 28
- ◇ Available in Hallmark Frost only
- \* Not available in Landmark Brandy

## Oven Cabinets

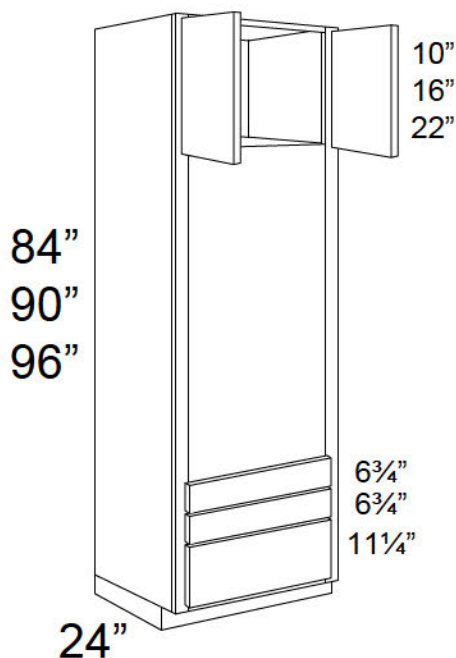

### OVEN CABINET

ITEM	F	G	M	N
OC3384	N/A	1363	1499	1679
OC3390	N/A	1389	1528	1711
OC3396*	N/A	1404	1544	1729

- \* Has 1 shelf in top cabinet.
- Not available in Landmark
- Center panel is MDF material, slightly recessed from the frame.

#### When using a Single Oven:

- Full panel face frame to be trimmed on site
- Maximum cut out width is 31"
- Maximum cut out height is 42½"
- Maximum overall oven height is 43"

#### When using a Double Oven:

- Full panel face frame to be trimmed on site
- Minimum cut out width is 27"
- Maximum cut out width is 31"
- Maximum cut out height is 56"
- Maximum overall oven height is 56½"

Please include size of oven cut out in your order.

Full panel face frame to be trimmed on site (not by Fabuwood).

**Note:** To avoid damage to the frame & side panels, please apply extra care when cutting the front panel.

### SPECIFICATION FOR OVEN CABINET

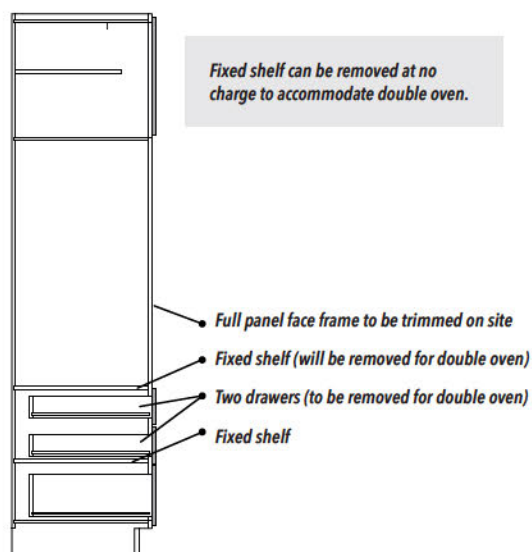

## Vanity Cabinets

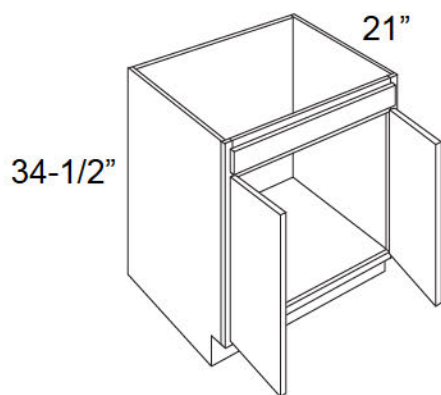

### 34½" HIGH VANITY SINK BASE

ITEM	F	G	M	N
VSB24-34	283	311	342	383
VSB30-34	302	331	364	408
VSB36-34	322	354	389	436

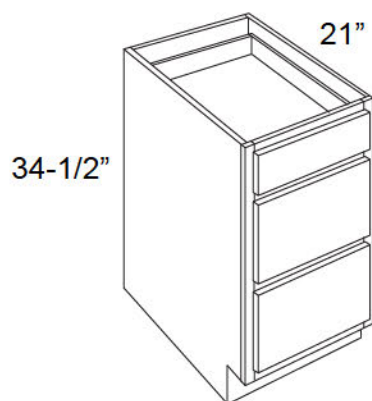

### 34½" HIGH VANITY DRAWER BASE

ITEM	F	G	M	N
VDB12-34	305	335	369	413
VDB15-34	318	349	384	430

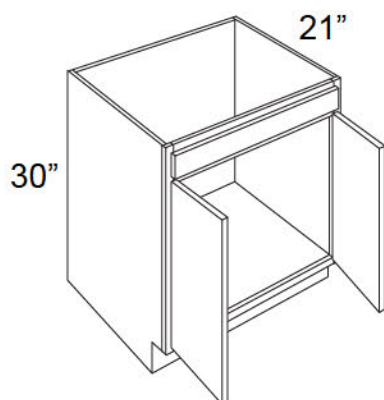

### 30" HIGH VANITY SINK BASE

ITEM	F	G	M	N
VSB24-30	224	247	272	305
VSB30-30	258	284	312	349
VSB36-30	295	325	358	401

## Vanity Cabinets

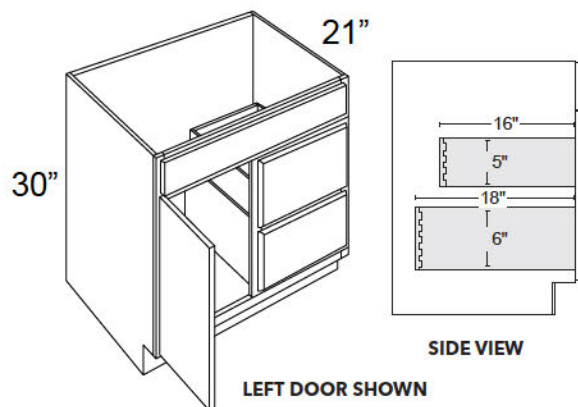

### 30" HIGH VANITY SINK & DRAWER BASE

ITEM	F	G	M	N
VSD24-30	347	382♦	N/A	N/A
VSD30-30	399	439♦	N/A	N/A
VSD36-30	445	489♦	N/A	N/A

- ♦ Available in Hallmark Brandy only
- Cabinet is reversible. Specify Left/Right.

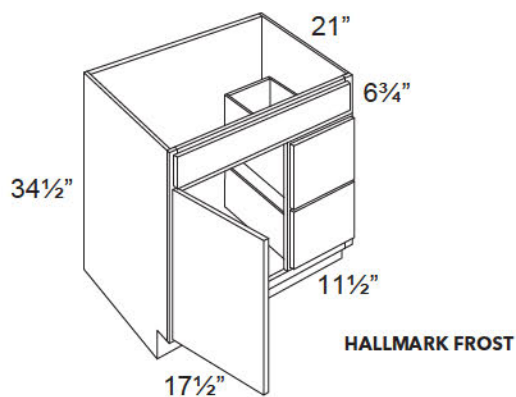

### VANITY SINK BASE COMBO

ITEM	F	G	M	N
VSD30-34	N/A	N/A	N/A	604

- Cabinet is reversible. Specify left/right.

*Note: once cabinet is assembled, door & drawers are not reversible.*

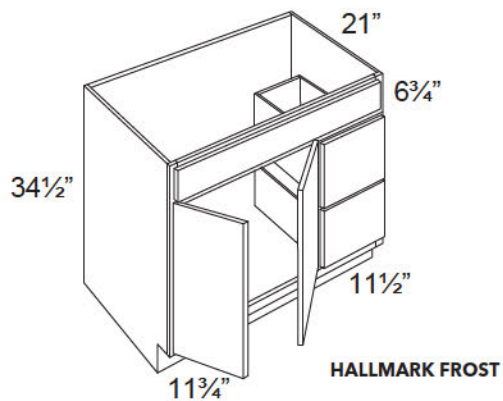

### VANITY SINK BASE COMBO

ITEM	F	G	M	N
VSD36-34	N/A	N/A	N/A	649

- Cabinet is reversible. Specify left/right.

*Note: once cabinet is assembled, door & drawers are not reversible.*



## Vanity Cabinets

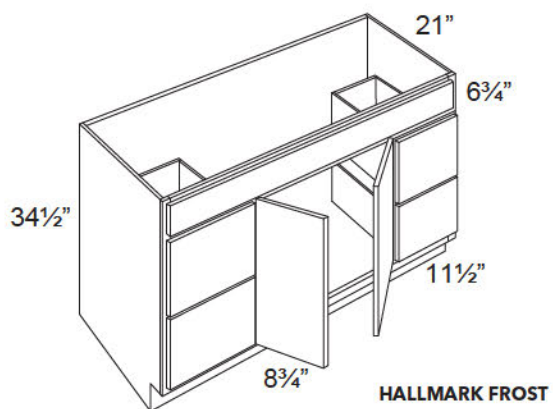

### VANITY SINK BASE COMBO

ITEM	F	G	M	N
VSD42-34	N/A	N/A	N/A	698

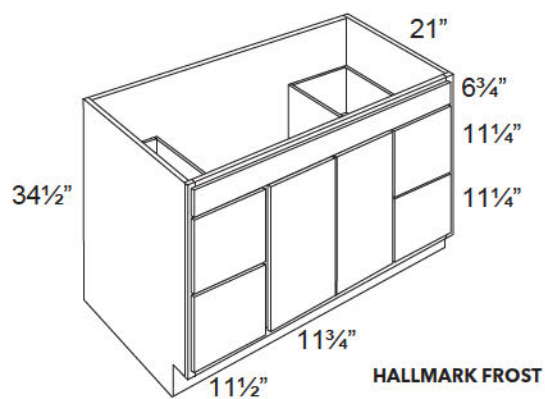

### VANITY SINK BASE COMBO

ITEM	F	G	M	N
VSD48-34	N/A	N/A	N/A	795

## ADA Cabinets (Landmark & Hallmark Pecan Only)

*All ADA cabinets have a 4½" toe kick*

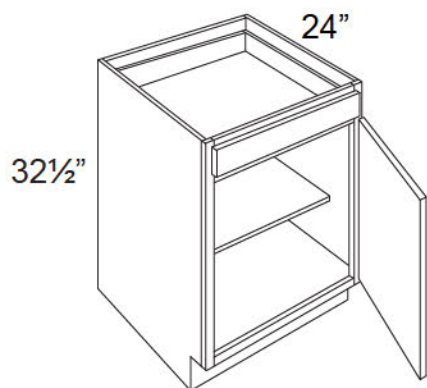

### SINGLE DOOR BASE

ITEM	F	G	M	N
ADA-B12	249	273♦	N/A	N/A
ADA-B15	263	289♦	N/A	N/A
ADA-B18	278	304♦	N/A	N/A

- ♦ Available in Hallmark Pecan only
- Peninsula cabinet modification pg. VIII
- Roll Outs pg. 28

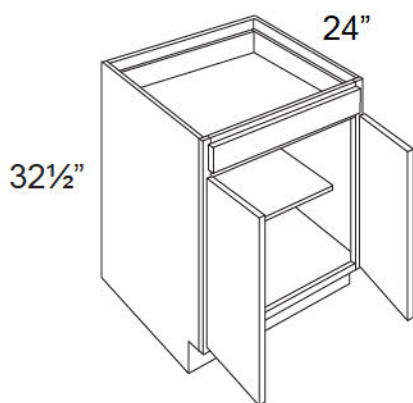

### DOUBLE DOOR BASE

ITEM	F	G	M	N
ADA-B24	339	373♦	N/A	N/A
ADA-B30	408	449♦	N/A	N/A

- ♦ Available in Hallmark Pecan only
- Peninsula cabinet modification pg. VIII
- Roll Outs pg. 28

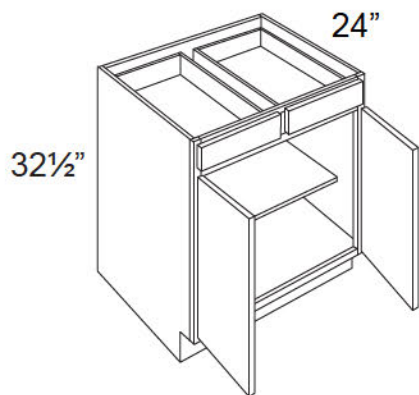

### DOUBLE DOOR & DRAWER BASE

ITEM	F	G	M	N
ADA-B36	451	497♦	N/A	N/A

- ♦ Available in Hallmark Pecan only
- Roll Outs pg. 28

## ADA Cabinets (Landmark & Hallmark Pecan Only)

*All ADA cabinets have a 4½" toe kick*

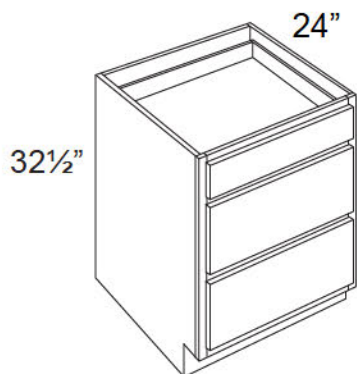

### DRAWER BASE

ITEM	F	G	M	N
ADA-DB15	394	432♦	N/A	N/A
ADA-DB24	444	432♦	N/A	N/A

- ♦ Available in Hallmark Pecan only
- Peninsula cabinet modification pg. VIII

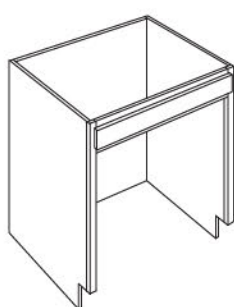
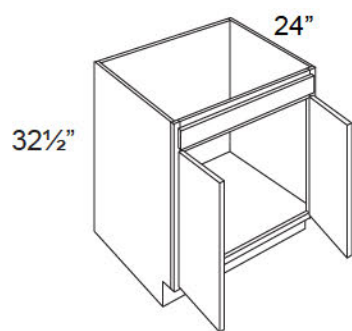

**AFTER DOORS, FLOOR &  
TOE KICK ARE REMOVED**

### SINK BASE -REMOVABLE FRONT

ITEM	F	G	M	N
ADA-SB30	411	453♦	N/A	N/A

- ♦ Available in Hallmark Pecan only
- Tilt Out pg. 26
- Matching interior

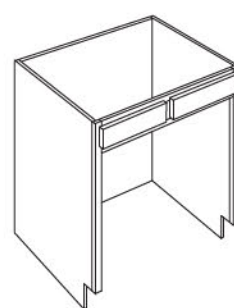
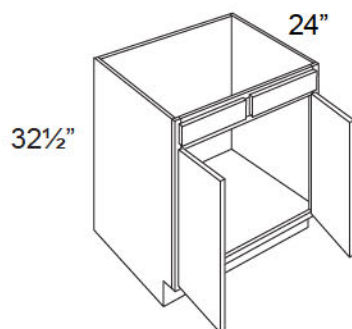

**AFTER DOORS, FLOOR &  
TOE KICK ARE REMOVED**

### SINK BASE - REMOVABLE FRONT

ITEM	F	G	M	N
ADA-SB36	441	484♦	N/A	N/A

- ♦ Available in Hallmark Pecan only
- Tilt Out pg. 26
- Matching interior

## ADA Cabinets (Landmark & Hallmark Pecan Only)

*All ADA cabinets have a 4½" toe kick*

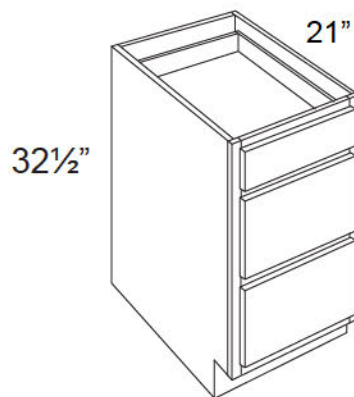

### VANITY DRAWER BASE

ITEM	F	G	M	N
ADA-VDB15	366	402♦	N/A	N/A

♦ Available in Hallmark Pecan only

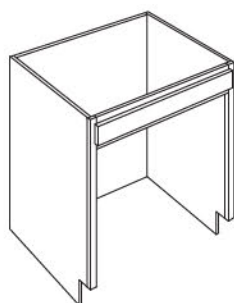
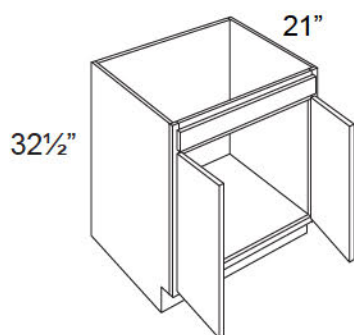

**AFTER DOORS, FLOOR &  
TOE KICK ARE REMOVED**

### VANITY SINK BASE - REMOVABLE FRONT

ITEM	F	G	M	N
ADA-VSB30	393	431♦	N/A	N/A
ADA-VSB36	419	461♦	N/A	N/A

♦ Available in Hallmark Pecan only  
• Matching interior



## Trash Cans

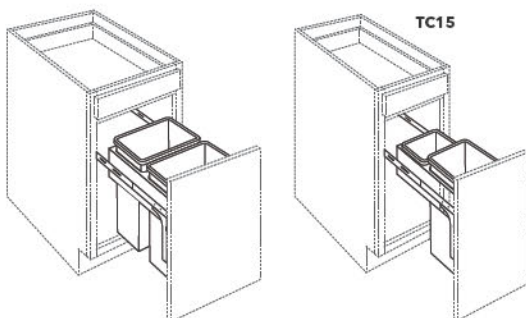

### TRASH CAN

ITEM	F	G	M	N
TC15*	441	441	441	441
TC18	657	657	657	657
TC21	708	708	708	708

- Cabinet not included, cabinet must be ordered separately
- Full extension slides (not soft-close)
- 35 qt. can(s) included
- Includes installation
- Not for ADA cabinet use
- \* One garbage can and one bags bin

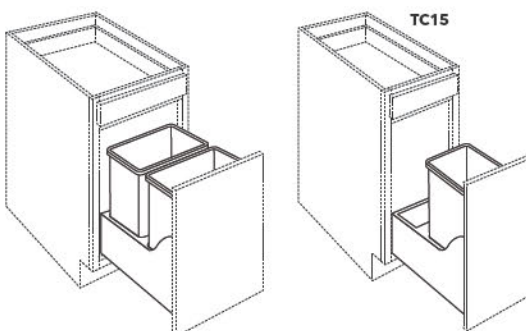

### TRASH CAN (W/ BLUM SLIDES)

ITEM	F	G	M	N
TC15 BLUM*	831	831	831	831
TC18 BLUM	891	891	891	891
TC21 BLUM	982	982	982	982
TCV15 BLUM♦	755	755	755	755

- Tandem plus Blumotion full extension concealed drawer runners
- Cabinet not included, cabinet must be ordered separately
- 2 - 35 qt. cans included
- Includes installation
- Not for ADA cabinet use
- \* Single 35 qt. can + one bags bin
- ♦ Smaller depth for vanity cabinets 21" deep

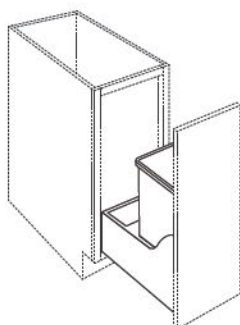

### TRASH CAN FULL HEIGHT DOOR (W/ BLUM SLIDES)

ITEM	F	G	M	N
TC15FHD BLUM*	831	831	831	831
TC21FHD BLUM	982	982	982	982

- Tandem plus Blumotion full extension concealed drawer runners
- Cabinet not included, cabinet must be ordered separately
- 2 - 50 qt. can included
- Includes installation
- Not for ADA cabinet use
- FULL-DOORS modification is required
- \* Single 50 qt. can + one bags bin

## Pull Outs

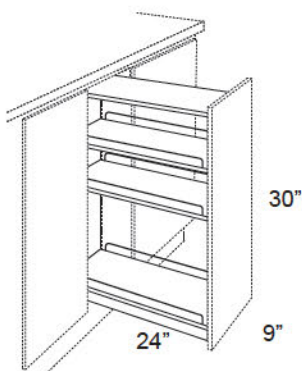

### SPICE PULL OUT BASE 9"

ITEM	F	G	M	N
SPO-B9*	580	580	580	580
SPO-B9 BLUM	861	861	861	861

- Cabinet not included, cabinet must be ordered separately
- FULL-DOORS modification is required
- Chrome rails
- Adjustable shelves
- UV coated maple wood
- Includes installation
- Not for ADA cabinet use
- \* Full extension ball-bearing slides (not soft-close)

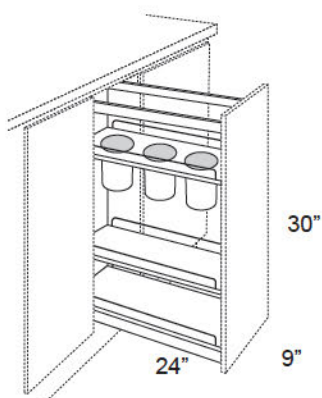

### UTENSIL PULL OUT BASE 9" (W/ BLUM SLIDES)

ITEM	F	G	M	N
UPO-B9 BLUM	937	937	937	937

- Cabinet not included, cabinet must be ordered separately
- FULL-DOORS modification is required
- Chrome rails
- Adjustable shelves
- UV coated maple wood
- Includes installation
- Not for ADA cabinet use
- Features Blumotion soft-close drawer slides

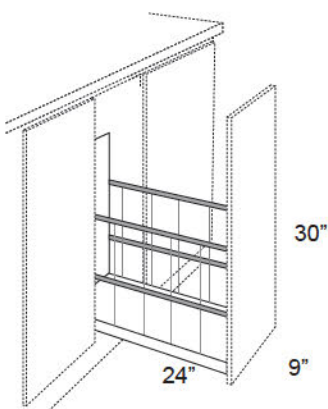

### TRAY DIVIDER PULL OUT BASE 9" (W/ BLUM SLIDES)

ITEM	F	G	M	N
TDPO-B9 BLUM	710	710	710	710

- Cabinet not included, cabinet must be ordered separately
- FULL-DOORS modification is required
- UV coated maple wood
- Includes installation
- Not for ADA cabinet use
- Features Blumotion soft-close drawer slides

## Pull Outs & Tilt Outs

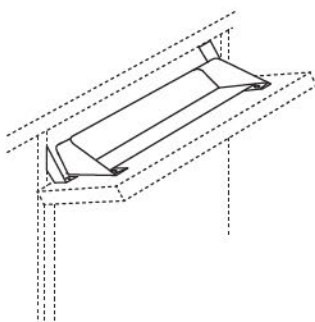
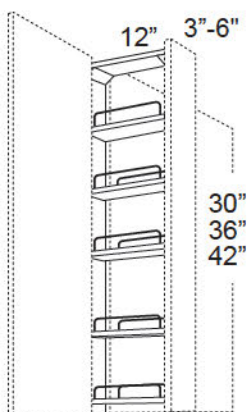
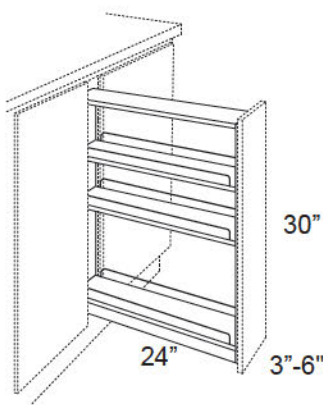

### SPICE PULL OUT BASE FILLER

ITEM	F	G	M	N
SPO-BF3*	354	354	354	354
SPO-BF6*	403	403	403	403
SPO-BF3 BLUM	620	620	620	620
SPO-BF6 BLUM	740	740	740	740

- Filler & Overlay Filler not included - must be ordered separately
- Chrome rails
- Adjustable shelves
- UV coated maple wood
- Installed on site
- Installed between two cabinets
- Not for ADA cabinet use
- \* Full extension ball-bearing slides (not soft-close)

### SPICE PULL OUT WALL FILLER

ITEM	F	G	M	N
SPO-WF330	403	403	403	403
SPO-WF336	428	428	428	428
SPO-WF342	457	457	457	457
SPO-WF630	460	460	460	460
SPO-WF636	499	499	499	499
SPO-WF642	531	531	531	531

- Filler & Overlay Filler not included - must be ordered separately
- Chrome rails
- Full extension ball-bearing slides (not soft-close - BLUM slides not available)
- Adjustable shelves
- UV coated maple wood
- Installed on-site
- Installed between two cabinets

### TILT OUT

ITEM	F	G	M	N
TILTOUT 11"	161	161	161	161
TILTOUT 14"	161	161	161	161
TILTOUT 24"	161	161	161	161

- White plastic tray
- Includes installation

## Cutlery Organizers

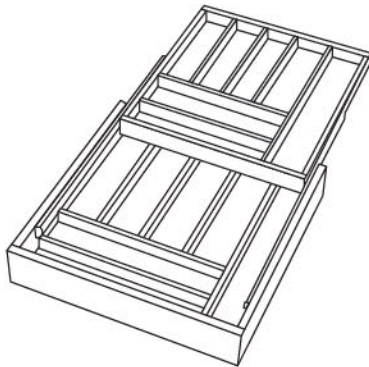

### 2-TIER CUTLERY DRAWER

ITEM	F	G	M	N
DCD-15 BLUM	375	375	375	375
DCD-18 BLUM	451	451	451	451
DCD-21 BLUM	498	498	498	498
DCD-24 BLUM	527	527	527	527

- UV coated maple wood
- Includes complete 3¾" high drawer box
- Requires upgrade to Blum soft-close slides

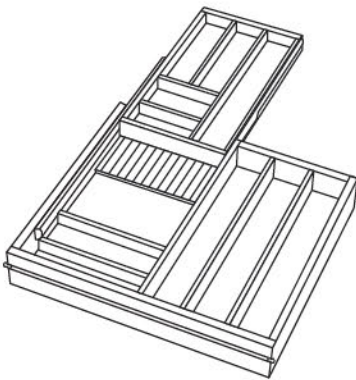

### 2-TIER CUTLERY COMBO DRAWER

ITEM	F	G	M	N
DCD-30 BLUM	616	616	616	616
DCD-36 BLUM*	N/A	N/A	N/A	710

- UV coated maple wood
- Includes complete 3¾" high drawer box
- Requires upgrade to Blum soft-close slides
- \* For DB36 only

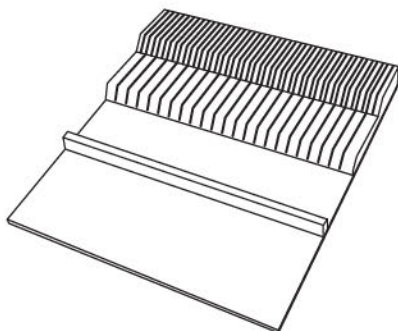

### TRIMMABLE KNIFE DIVIDER

ITEM	F	G	M	N
DKI-18/24	222	222	222	222

- UV coated maple wood
- Total height: 2"
- Includes installation
- ¾" plywood bottom



## Accessories

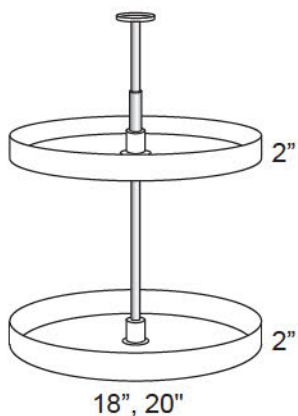

### LAZY SUSAN

	ITEM	F	G	M	N
PLASTIC	LSP24 30	232	232	232	232
	LSP24 36/42	361	361	361	361
WOOD	LSW24 30	451	451	451	451
	LSW24 42	708	708	708	708
	LSW27 30*	580	580	580	580
	LSW27 42*	908	908	908	908

- Adjustable metal post
- 42" lazy susan has 3 trays
- 42" poles can be cut to fit 36" high cabinet
- Includes installation
- \* 20" trays

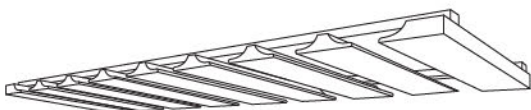

### STEMWARE RACK

ITEM	F	G	M	N
STEMWARE 30	425	425	425	425
STEMWARE 36	450	450	450	450

- Comes unfinished. Product finished per order. May have extended ETA.

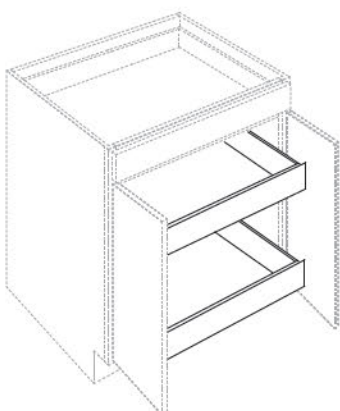

### ROLL-OUT

ITEM	F	G	M	N
ROD-B15*	123	123	123	123
ROD-B18*	135	135	135	135
ROD-B21	141	141	141	141
ROD-B24*	150	150	150	150
ROD-B27	156	156	156	156
ROD-B30*	162	162	162	162
ROD-B33	168	168	168	168
ROD-B36	175	175	175	175

- Cabinet not included
- Per drawer, sold separately (includes installation)
- Full extension ball-bearing slides  
Upgrade to soft close Blum slides = 125/drawer (assembled orders only)
- Drawers are adjustable
- \* Can be used for pantries

## Accessories

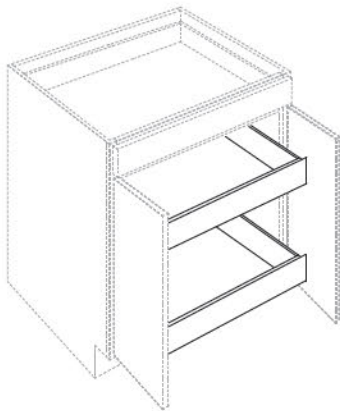

### ROLL OUT (W/ BLUM SLIDES)

ITEM	F	G	M	N
ROD-B15 BLUM	248	248	248	248
ROD-B18 BLUM	260	260	260	260
ROD-B21 BLUM	266	266	266	266
ROD-B24 BLUM	275	275	275	275
ROD-B27 BLUM	281	281	281	281
ROD-B30 BLUM	287	287	287	287
ROD-B33 BLUM	293	293	293	293
ROD-B36 BLUM	300	300	300	300

- Cabinet not included
- Per drawer, sold separately (includes installation)
- Sold assembled, not KD
- Blumotion full extension concealed drawer runners
- Drawers are adjustable
- Can be used for pantries

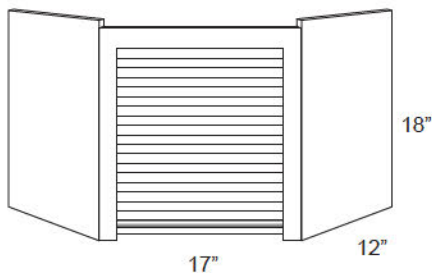

### CORNER APPLIANCE GARAGE

ITEM	F	G	M	N
APPLIANCE GARAGE	805	805	805	805

- Comes unfinished. Product finished per order. May have extended ETA.
- Designed to be installed under a diagonal corner wall 24".

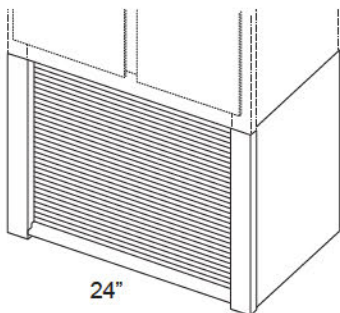

### STRAIGHT APPLIANCE GARAGE

ITEM	F	G	M	N
APPLIANCE GARAGE 24"	1036	1036	1036	1036

- Comes unfinished. Product finished per order. May have extended ETA.
- Designed to be placed under a 24" wide wall cabinet.



### TOUCH UP KIT

ITEM	F	G	M	N
TOUCH UP KIT	65	65	65	65

## Fillers

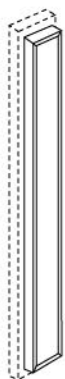
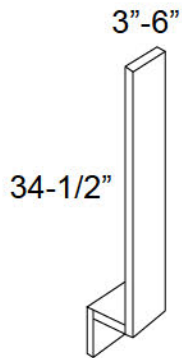
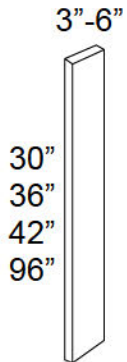

### WALL & TALL

ITEM	F	G	M	N
WF330	27	29	32	26
WF336*	35	37	41	35
WF630	52	57	63	50
WF342	39	42	46	42
TF396	66	72	79	84
TF696	122	134	147	158

- Not available in Landmark Brandy
- 2 sides of filler are finished

### BASE

ITEM	F	G	M	N
BF3	27	30	33	33
BF6	61	67	74	62

- 2 sides of filler are finished

### OVERLAY

ITEM	F	G	M	N
OLFBF3	N/A	76	83	80
OLFBF6	N/A	117	127	129
OLF330♦	N/A	69	76	73
OLF336	N/A	82	90	83
OLF342	N/A	91	100	97
OLF384*	N/A	202	N/A	N/A
OLF396*	N/A	225	N/A	N/A
OLF630♦	N/A	105	115	117
OLF636	N/A	130	143	146
OLF642	N/A	156	172	175

- Overlay Base Filler is 29½" high
- Sides of filler are finished
- ♦ Will not fit for a base cabinet
- \* Available in Hallmark Brandy only

## Valances

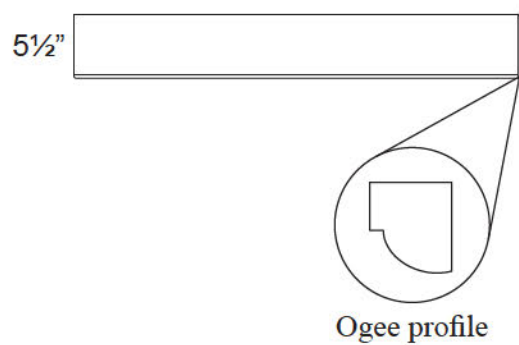

### STRAIGHT

ITEM	F	G	M	N
VST96	94	103	113	191

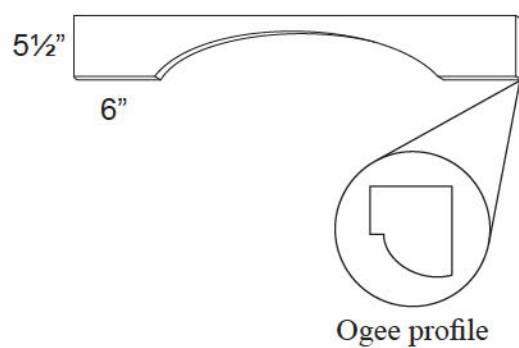

### ARCHED

ITEM	F	G	M	N
VAR54	N/A	95	105	101



## Pilasters, Posts & Corbels

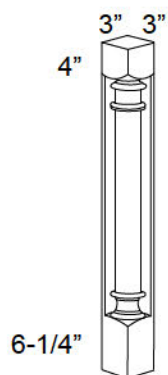

### CORNER POST

ITEM	F	G	M	N
CP36	N/A	288	317	324

- Must trim 2" from top or bottom

*Disclaimer: Pilasters are handmade and may therefore feature inconsistencies in shape or form. These are in no way considered defects.*

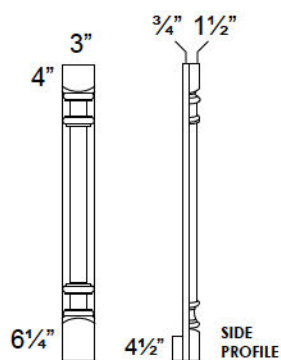

### PILASTER BASE

ITEM	F	G	M	N
PP-BASE	N/A	208	229	234

- Must trim 2" from top or bottom
- Features a toe kick block behind the pilaster

*Disclaimer: Posts are handmade and may therefore feature inconsistencies in shape or form. These are in no way considered defects.*

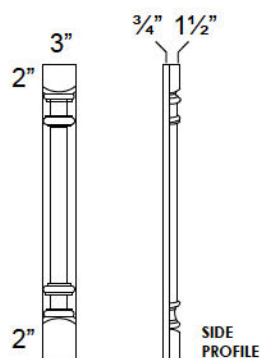

### PILASTER WALL

ITEM	F	G	M	N
PP-W30	N/A	184	202	207
PP-W36	N/A	208	229	229
PP-W42	N/A	224	246	251

*Disclaimer: Posts are handmade and may therefore feature inconsistencies in shape or form. These are in no way considered defects.*

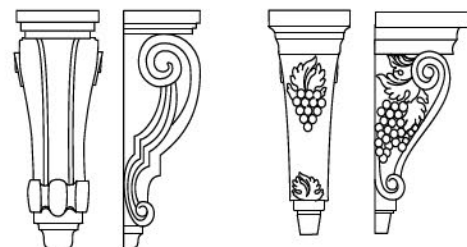

**CT**  
(H6 1/2" x W3 3/4" x D3 1/2")

**CG**  
(H10" x W4 5/8" x D5 1/4")

### CORBELS

ITEM	F	G	M	N
CTS	N/A	147	162	165
CGS	N/A	171	188	191

*Disclaimer: Corbels are handmade and may therefore feature inconsistencies in shape or form. These are in no way considered defects.*

## Moldings (8')

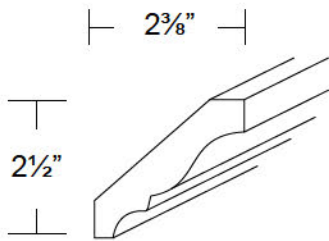

### SMALL CROWN

ITEM	F	G	M	N
CM-1	85	94	103	126

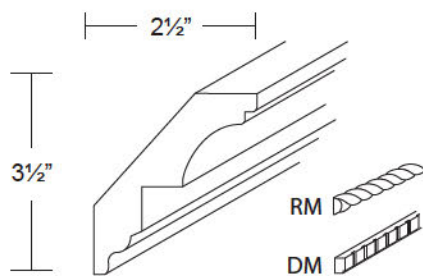

### ROYAL CROWN & INLAY

ITEM	F	G	M	N
TCM*	146	161	177	179
RM	57	62	68	74
DM	57	62	68	74

\* Back-mounting cleat included

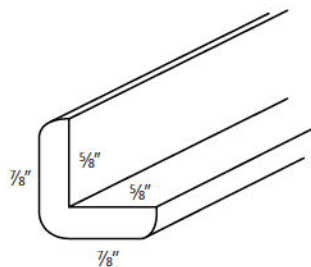
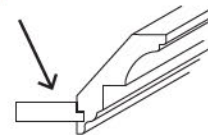

### OUTSIDE CORNER

ITEM	F	G	M	N
OCM8	33	36	40	65

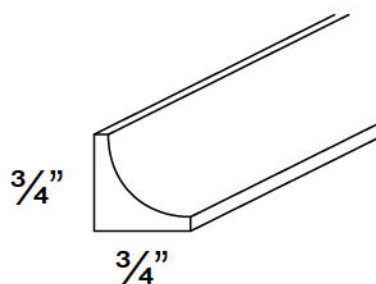

### INSIDE CORNER

ITEM	F	G	M	N
ICM8	33	36	40	62

## Moldings (8')

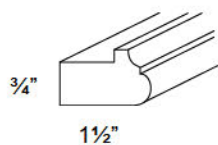

### LIGHT RAIL

ITEM	F	G	M	N
LRM	77	84	92	152

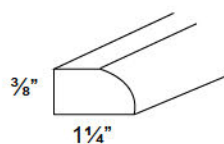

### SCRIBE

ITEM	F	G	M	N
SM8	33	36	40	40

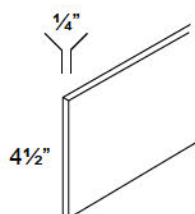

### TOE KICK

ITEM	F	G	M	N
TK8	36	40	44	58

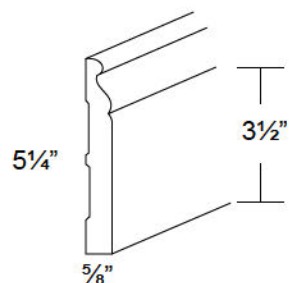

### BASE

ITEM	F	G	M	N
BBM	N/A	162	178	191

## Panels

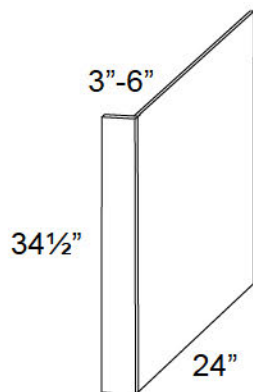

### DISHWASHER END PANEL

ITEM	F	G	M	N
DWR3	76	83	91	119
DWR6	114	125	138	210

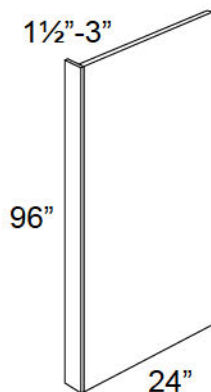

### REFRIGERATOR END PANEL WITH RETURN

ITEM	F	G	M	N
REP1-1/2	169	185	204	209
REP3	198	217	239	245

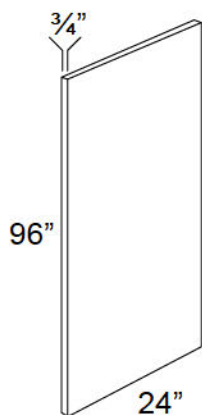

### REFRIGERATOR END PANEL

ITEM	F	G	M	N
REP96	154	168	185	231

- Edge banded on both 96" sides.
- To add a return on an REP, see pg. VIII



## Panels

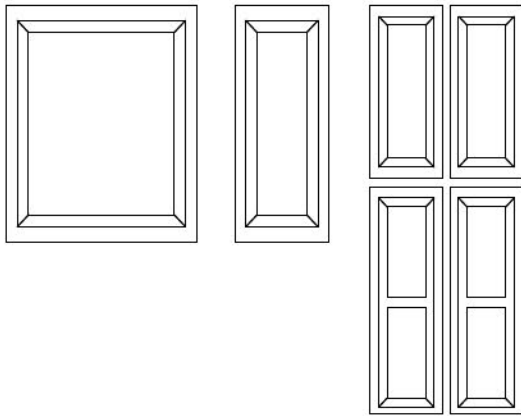

### WAINSCOT

ITEM	F	G	M	N
WP-BASE	189	199	219	202
WP-W30	100	104	114	106
WP-W36*	129	136	150	133
WP-W42	148	157	173	159
WP-T84	452	475	523	483
WP-T90*	514	552	607	530
WP-T96	554	583	641	592

\* Not available in Landmark Brandy

- **LANDMARK**

BASE - 22-1/2" X 27-13/16"

W30 - 10-1/2" X 27-13/16"

W36 - 10-1/2" X 33-13/16"

W42 - 10-1/2" X 39-13/16"

TALL WIDTH - 11-1/4" EACH DOOR

- **HALLMARK**

BASE - 23-1/2" X 29-1/2"

W30 - 11-1/2" X 28-5/8"

W36 - 11-1/2" X 34-5/8"

W42 - 11-1/2" X 40-5/8"

TALL WIDTH - 11-3/4" EACH DOOR

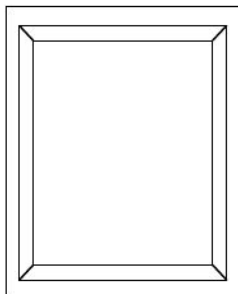

### DECO DOOR

ITEM	F	G	M	N
DD B09FD	N/A	85	94	95
DD B12FD	N/A	111	122	125
DD B15FD	N/A	131	144	147
DD B18FD	N/A	153	168	172
DD B21FD	N/A	172	189	193

- Door height is 29-1/2"
- Door width is same as door on cabinet
- Door is not pre-drilled for hinges

## Panels & Hood

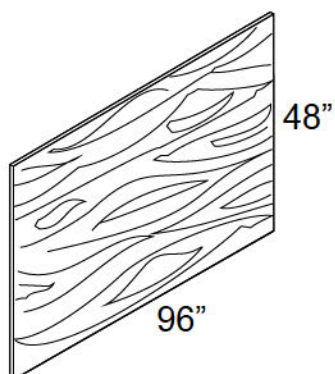

### PLYWOOD

ITEM	F	G	M	N
PLY-1/4	204	224	246	273
PLY-1/2	272	299	329	473
PLY-3/4	357	393	432	546

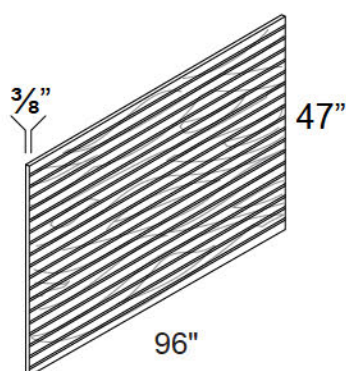

### BEADED PANEL

ITEM	F	G	M	N
BP4X8	281	308	339	659

- Beaded panel is designed with a 1" interlocking

[illegible]

# Order Form

## DOOR STYLE:

### HALLMARK

- ☐ FROST  
☐ PECAN  
☐ BRANDY  
☐ CHESTNUT

### LANDMARK

- ☐ NATURAL  
☐ BRANDY

## ORDER TYPE:

- ☐ DELIVERY ☐ ASSEMBLED  
☐ PICK UP ☐ KNOCK DOWN

## ACCOUNT INFO:

COMPANY NAME:

CONTACT:

PURCHASE ORDER #:

DATE:

REQUESTED SHIP DATE:

PHONE:

FAX:

E-MAIL:

SHIP TO:

SPECIAL INSTRUCTIONS:

☐ I WOULD LIKE THIS ORDER TO BE READY LATER THAN THE  
REGULAR ESD: \_\_\_\_\_ (DATE)

ORDERS THAT HAVE NOT BEEN ACCEPTED AFTER 4 WEEKS WILL BE STORED  
AT DEALERS EXPENSE.

If more than 35% of cabinet sides on the order are selected as  
exposed, a \$25 fee will be applied to each exposed side from the  
6th cabinet onward (fee does not apply to the first five cabinets)

	QTY	ITEM CODE	PRICE	HINGE		FINISH	
				L	R	L	R
1							
2							
3							
4							
5							
6							
7							
8							
9							
10							
11							
12							
13							
14							
15							
16							
17							
18							
19							
20							
21							
22							
23							
24							
25							
26							
27							
28							
29							
30							
31							
32							
33							
34							
35							
36							

TOTAL PIECE COUNT

TOTAL LIST

\$

MULTIPLIER

%

TOTAL COST

\$

[illegible]