

## Construction Specifications

### Doors and Drawer Fronts:

Doors and drawer fronts on the Classic line are made of solid wood with a stain and glazed finish.

The 5 piece Wellington full overlay door has a solid  $\frac{5}{8}$ " thick raised center panel captured in a  $\frac{3}{4}$ " x  $2\frac{1}{2}$ " mortise and tenon frame. It has an applied moulding and is complemented with a 5 piece recessed panel drawer front.

### Hinges:

Compact Blumotion soft-close mechanism integrated in concealed six-way adjustable hinges. Please note: Lazy Susan, Easy Reach and Pie Cut cabinets do not feature the soft-close mechanism.

### Drawers:

The Classic line includes a  $\frac{5}{8}$ " thick solid wood dovetail drawer box with a  $\frac{3}{8}$ " plywood bottom, attached to Tandem plus Blumotion full extension concealed drawer runners.

### Shelving:

18mm ( $\frac{3}{4}$ ") thick veneered plywood with matching wood veneer edge banding is used on all wall and base cabinetry where applicable. The adjustable shelves are supported by a bronze plated shelf clip. All base cabinetry includes an 18" deep adjustable shelf.

### Backs, Tops and Bottoms:

$\frac{1}{2}$ " thick veneered wood with natural finished interiors, dovetailed side panels engineered to create a solid integrated cabinet box. Backs are stapled and screwed into place for additional support.

### Face Frame:

$\frac{3}{4}$ " x  $1\frac{1}{2}$ " solid wood stiles and rails jointed with glue and dowels. Back of face frames are dovetail grooved to accept side panels. The face frame is engineered so that the bottom of all base and wall cabinets are flushed with the top inside edge of the face frame creating a custom look.

### Toe Kick:

$\frac{3}{4}$ " x  $4\frac{1}{2}$ " solid wood toe kick is added to each assembled cabinet and finished to match along with the edges. Additional 8-foot lengths of  $\frac{1}{4}$ " plywood toe kicks are available for those who do not wish to see the joints between cabinets.

### Corner Blocks and Panel Beams:

All four corners of the base cabinets are secured with a wooden block screwed into each end panel at a 45° angle for the support and mounting of a countertop. In addition a panel beam is glued and fastened into a dovetail groove at the top of each base cabinet to ensure a straight fully integrated side.

Copyright © 2019 by Fabuwood Cabinetry Corp.

All rights reserved.

No part of this publication may be reproduced, distributed, or transmitted in any form or by any means, including photocopying, scanning, or other electronic or mechanical methods, including online sharing, without the prior written permission of Fabuwood Cabinetry Corp.

## Construction Specifications

- 1 Solid wood door and draw front frames either doweled and glued or mortise and tenon, depending on door.
- 2 Compact Blumotion soft-close mechanism integrated in concealed six-way adjustable hinges.
- 3 5/8" solid wood dovetail drawer with a 3/8" plywood bottom with Tandem plus Blumotion full extension concealed drawer runners.
- 4 3" interior drawer height.
- 5 3/4" x 1 1/2" solid wood face frame.
- 6 1/2" veneered plywood back with a natural finished interior.
- 7 1/2" veneered plywood side panels dovetailed into face frame.
- 8 18mm (3/4") veneered plywood adjustable shelving with matching wood veneer edge banding.
- 9 3/4" x 4 1/2" solid wood toe kick finished to match exterior finish and attached to cabinet.
- 10 Wood corner blocks added for the support and mounting of a countertop.
- 11 1 1/2" x 1/2" plywood panel beams dovetailed into the side panels for strength and stability.
- 12 Base cabinet has 18" deep shelves.

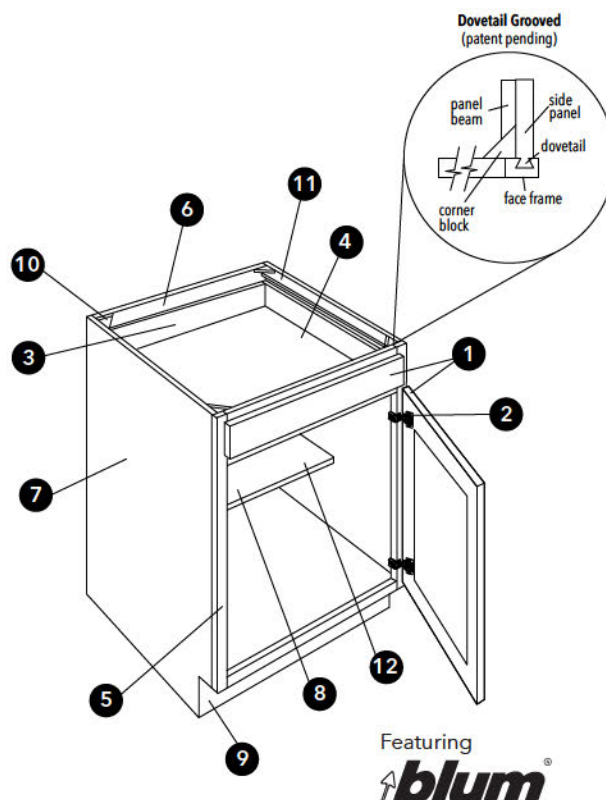
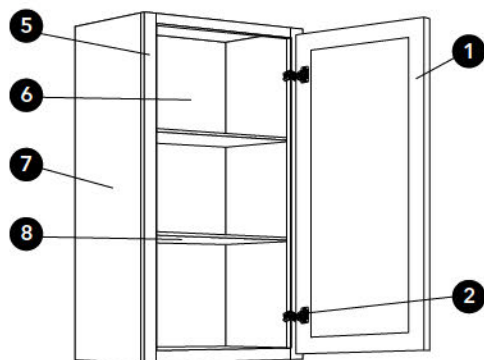





## What exactly defines a Q12 cabinet?

To fully achieve Q12 eligibility, a cabinet must encompass twelve unique standards of quality. Read below to learn more about the twelve fundamental pillars that establish the Q12 qualification:

### Q1: QUALITY SOURCED LUMBER

This Q12 standard requires the use of carefully selected top-grade lumber, guaranteeing the finest and most dependable kitchen cabinets. To meet this requirement, Fabuwood has implemented a rigorous inspection process to assure that only first-class products, free of irregularities leave the plant.

### Q2: PRO TOUCH TECHNIQUES

To fully permeate a Q12 assessment, expert finishing methods are required to heavily influence first impressions and assure a lasting finish that is easy to maintain. Fabuwood's own pro touch technique uses renowned brands to create a durable, simple to clean cabinet that will hold its beauty for years.

### Q3: DOVETAIL CONSTRUCTION

Another important facet of Q12 is the required use of dovetail construction. A process that involves plywood side panels to perfectly interlock with a solid wood face frame through corresponding dovetail grooves. This highly resilient technique that Fabuwood introduced to the market guarantees that Q12 cabinet lines are secure, strong, and long-lasting.

### Q4: ANTI-WARP STRUCTURES

The anti-warp component involves the use of plywood panels comprised of rigid reinforcement beams. By applying the beams with a dovetail construction technique to secure all components, Fabuwood meets this standard ensuring a strong, reliable build that is resistant to distortion.

### Q5: WOODEN CORNER BLOCKS

For a cabinet to receive complete Q12 entitlement, wood must be used to help maintain structural integrity. To ensure a unified and organic design build, Fabuwood manufactures robust cabinet lines with wooden corner blocks, which keep the purity of an all-wood cohesive construction.

### Q6: SOLID BACK BUILDS

For superior structural longevity, this Q12 feature requires that the back of a cabinet is constructed from one piece of solid half-inch plywood. Fabuwood fulfills this standard by manufacturing cabinet backs with a strong and single piece of plywood to ensure durable strength and dimensional stability.

### Q7: FLUSH FIT FRAMES

In order to be considered Q12 compliant, a cabinet must have flush inner frames that provide an attractive appearance while giving added dimension to the internal area. Fabuwood's Q12 lines display prime craftsmanship with their flat surface top and bottom interior planes that result in convenient and practical usage.

### Q8: FINISHED INTERIORS

Treated and finished cabinet interiors are another significant feature of Q12 as they produce a clear statement of quality and attention to detail. As opposed to manufacturing with an applied lining, Fabuwood's vigorous top treatment techniques create a refined and durable design that is free of bubbling, peeling and chipping.

### Q9: SOFT-CLOSING ACTION

Another great characteristic of the Q12 qualification is the use of compact hinges with built-in, soft-close mechanism. Fabuwood uses the smooth-running capability and soft closing action of Blum's tandem plus blumotion hinges, providing an impeccably gentle and fluid cabinet function.

### Q10: FLUID FULL-EXTENSION

Cabinets built with smooth full-extension glides guarantee an enhanced running action that maximizes a cabinet's storage to its full capacity and ensures Q12 eligibility. Fabuwood manufactures Q12 cabinets with Blum's tandem plus runners and soft-closing technology, precisely utilizing space while also preventing damage and depreciation.

### Q11: EZ LEVEL DRAWER FRONTS

To ensure proper door alignment and function, a Q12 cabinet requires an effortless system utilizing a degree of mechanical precision for installing perfectly positioned drawer faces. Fabuwood innovates with a unique technique using circular discs that allow for easy 3/8" adjustments in any direction, resulting in a Q12 cabinet that achieves an aesthetically graceful balance.

### Q12: SEALED SIGNATURE

The final Q12 metric requires a thorough review at each manufacturing stage to ensure the completed product meets the provisions specified in the quality assurance system. Upon factory exit, a stamp of approval is given to show Fabuwood's commitment to quality control from the very first level of Q1 to the final Q12 stage, thus guaranteeing a superior and immaculate end product.

## Door Styles

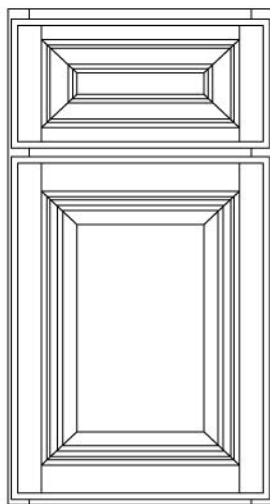

### WELLINGTON

COLOR	FINISH	PRICE COLUMN
Cinnamon	Stain + Glaze	B
Ivory	Paint + Glaze	E

- Full overlay door
- Frames are solid wood  $\frac{3}{4}$ " thick and  $2\frac{1}{2}$ " wide
- Constructed with mortise and tenon joints
- Solid wood (Cinnamon) / MDF (Ivory) center panel is  $\frac{5}{8}$ " thick and captured in a frame with rubber spacers
- An **applied moulding** is added to the inside edge of the door frame
- 5 piece recessed panel drawer front matches door design and moulding detail
- Cabinet installed next to a wall or deeper cabinet requires a  $\frac{1}{4}$ " filler for full door opening



## Order Information

Orders are accepted from accounts that are in good standing. We recommend placing your orders online for faster processing and delivery.

Orders may be submitted 24 hours a day via one of the following methods:

- 1) Online: Go to: <https://ezpricing.fabuwood.com/> to access Fabuwood's EZ Pricing Program. Orders exported from 20/20 & ProKitchen in an .xml file format can be uploaded directly into the EZ Pricing Program.
- 2) Email: [orders@fabuwood.com](mailto:orders@fabuwood.com)
- 3) Fax: 201-432-6055

Forms are processed in the order they were received. Fabuwood has a strict policy not to accept verbal orders at any time. Fabuwood customer service representatives will need your account number each time you contact us. Please have your information on hand.

### ORDER PLACEMENT:

- To place an order with Fabuwood, please use our interactive forms, found in the Dealer's Corner on our website. 20/20 & ProKitchen order forms are also accepted provided that Fabuwood nomenclature is used.
- Orders should be submitted with a cover page. Cover pages must include:
  - 1) Name of dealership
  - 2) Name of client/designer
  - 3) Purchase order number
  - 4) Total amount of pages in order
- According to your requested shipping timeframes, Fabuwood schedules orders based on when they were submitted. Should you have more than one order, it is best to batch them together and submit them to Fabuwood simultaneously.
- Please make sure to specify your shipment method at the time of purchase.
- Should your order need to be shipped to a location that differs from your usual delivery address, it must be noted at time of purchase along with a contact name and phone number for the location. Additional charges will apply.
- On average, orders are ready to leave Fabuwood's warehouse within 7 business days from confirmed and signed orders. For rush orders, please contact your customer service representative to discuss express fulfillment options. Rush orders will incur additional fees.
- For orders containing modifications or custom finishing, please expect additional business days for completion.
- Prices listed in latest spec book reflect Fabuwood's list price. Please contact your customer service representative for multiplier and freight pricing.

### ORDER PROCESSING:

- Upon receipt of your order, your assigned customer service representative will enter your request as a quote and will subsequently send it back for your approval.
- Please take the time to thoroughly proofread all Fabuwood quotes.

Make sure all information, including quantity, color, style, shipment method, and pricing are correct. Once quotes have been signed and resubmitted, Fabuwood is not responsible for typos or mistakes made.

- Should the order require any corrections or revisions, email them to [orders@fabuwood.com](mailto:orders@fabuwood.com) or fax to: 201.432.6055. Quotes are valid for 30 days only.
- Once revisions have been submitted, Fabuwood will send you a revised quote for a final approval. When we receive your signature we can begin processing your order.
- By signing the quote, the dealer takes full responsibility for any and all errors on order forms.
- Once quotes are signed and returned you will receive an order confirmation email which will include your order's ESD. ESD's are determined by the date the order will ship out or be available for pickup. For orders entered online, you can select an ESD based on your schedule. However, once an ESD is selected, the order will not be ready prior to the selected date.
- Order pickups must be scheduled one business day in advance by no later than 3pm EST. To schedule a pickup, please contact the pickup department at 201-432-6555 ext #372.
- Orders not picked up after 4 weeks will be stored at the dealer's expense. No additional orders will be released until storage fees have been paid, or order is picked up. Storage fees will accrue on a monthly basis at the rate of \$50 per palette.
- If you would like your order to be ready later than the regular ESD, please make a note on your order to avoid storage fees.

### ORDER REVISION PROCEDURES:

- Once a quote has been approved, any revisions or cancellations will result in restocking fees. Also, modified/custom items cannot be revised or canceled once approved.
- Verbal cancellations or revisions are not accepted at any time.
- Merchandise that has left Fabuwood's facilities cannot be returned or exchanged.

### SHIPPING SHORTAGES & DAMAGES:

Order shortages such as missing items and/or any visible shipping damages must be noted on the shipping receipt and signed by both the driver and the recipient. It is then the customer's responsibility to notify Fabuwood of any such issues within 24 hours of accepting the delivery. Any orders accepted and signed by the customer without any such note, will be considered complete. All other shipping damages must be claimed by the customer within 5 days. All items that have been installed and/or are not in their original packaging cannot be claimed as damaged.

## Order Form

### DOOR STYLE:

#### WELLINGTON

- ☐ IVORY  
☐ CINNAMON

### ORDER TYPE:

- ☐ DELIVERY      ☐ ASSEMBLED  
☐ PICK UP      ☐ KNOCK DOWN

### ACCOUNT INFO:

COMPANY NAME:

CONTACT:

PURCHASE ORDER #:

DATE:

REQUESTED SHIP DATE:

PHONE:

FAX:

E-MAIL:

SHIP TO:

SPECIAL INSTRUCTIONS:

☐ I WOULD LIKE THIS ORDER TO BE READY LATER THAN THE  
REGULAR ESD: \_\_\_\_\_ (DATE)

ORDERS THAT HAVE NOT BEEN ACCEPTED AFTER 4 WEEKS WILL BE STORED  
AT DEALERS EXPENSE.

If more than 35% of cabinet sides on the order are selected as  
exposed, a \$25 fee will be applied to each exposed side from the  
6th cabinet onward (fee does not apply to the first five cabinets)

	QTY	ITEM CODE	PRICE	HINGE		FINISH	
				L	R	L	R
1							
2							
3							
4							
5							
6							
7							
8							
9							
10							
11							
12							
13							
14							
15							
16							
17							
18							
19							
20							
21							
22							
23							
24							
25							
26							
27							
28							
29							
30							
31							
32							
33							
34							
35							
36							

TOTAL PIECE COUNT

TOTAL LIST

\$

MULTIPLIER

%

TOTAL COST

\$



## Return Merchandise Authorization & Claim Form

**PLEASE FILL OUT THE FOLLOWING FORM AND SUBMIT VIA:**
**Fax:** 201-432-6055    **E-mail:** rma@fabuwood.com

ORIGINAL ORDER # (REQUIRED-TO AVOID REPLACEMENT DELAY)		ORDER INFO	
RMA # (FABUWOOD WILL PROVIDE)		DATE	
COMPANY NAME		PHONE	
CONTACT PERSON		EMAIL	
RMA TYPE REQUESTED:		<input type="checkbox"/> DELIVERED <input type="checkbox"/> PICKED UP <input type="checkbox"/> KD <input type="checkbox"/> ASSEMBLED	
<input type="checkbox"/> REPAIR <input type="checkbox"/> REPLACEMENT <input type="checkbox"/> ISSUE A REFUND		FAX	

*sample:*

ITEM / SKU #	QTY	STYLE	COLOR	REASON CODE
W3030	1	Nexus	Frost	<input checked="" type="checkbox"/> 8 Door is scratched
				<input type="checkbox"/>
				<input type="checkbox"/>
				<input type="checkbox"/>
				<input type="checkbox"/>
				<input type="checkbox"/>
				<input type="checkbox"/>

**REASON FOR RETURN:**

- |                   |                         |                              |
|-------------------|-------------------------|------------------------------|
| 1) Not needed     | 5) Received wrong item* | 9) Instructions not followed |
| 2) Ordered wrong  | 6) Not received         | 10) Not satisfied            |
| 3) Change in plan | 7) Missing parts        | 11) Wrong item in box*       |
| 4) Broken         | 8) Damaged item         |                              |

\* Please send a photo of label (package &amp; back panel)

- ✓ Please place this form on every package being returned.
- ✓ Make sure the RMA# is filled in as Fabuwood will refuse any package without RMA#.
- ✓ Return all merchandise to Fabuwood Cabinetry Corp. 69 Blanchard Street, Newark NJ 07105.
- ✓ If returning the items with the Fabuwood truck, an authorized form will be required.  
The driver will not accept any merchandise without this form.



## Sales Tools

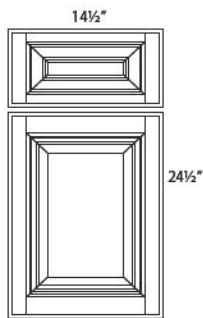

### DOOR SAMPLES WITH DRAWER FRONT

ITEM	DESCRIPTION	LIST PRICE
SDWC	WELLINGTON CINNAMON	65
SDWI	WELLINGTON IVORY	65

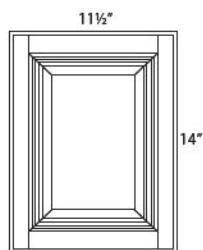

### SMALL DOOR SAMPLES

ITEM	DESCRIPTION	LIST PRICE
SDWC-2	WELLINGTON CINNAMON	49
SDWI-2	WELLINGTON IVORY	49

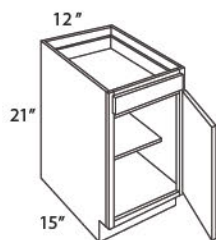

### MINI BASE & WALL SAMPLES

ITEM	DESCRIPTION	LIST PRICE
MBS	BASE SAMPLE 12"W X 21"H X 15"D	210

- Available in Wellington Cinnamon finish only.



### SPECIFICATION

ITEM	DESCRIPTION	LIST PRICE
SPEC BOOK	SPEC BOOK - BINDER & INSERTS	81

## Sales Tools



### LITERATURE

ITEM	DESCRIPTION	LIST PRICE
TFB	ALL LINES TRI-FOLD BROCHURE (PACK OF 25)	25
SGB18	STYLE GUIDE BROCHURE (PACK OF 10)	25
ACCB	ACCESSORIES BROCHURE (PACK OF 20)	40



### MOLDING CHAIN

ITEM	DESCRIPTION	LIST PRICE
MLK-CLASSIC	COMPLETE CHAIN OF CLASSIC MOLDINGS	97

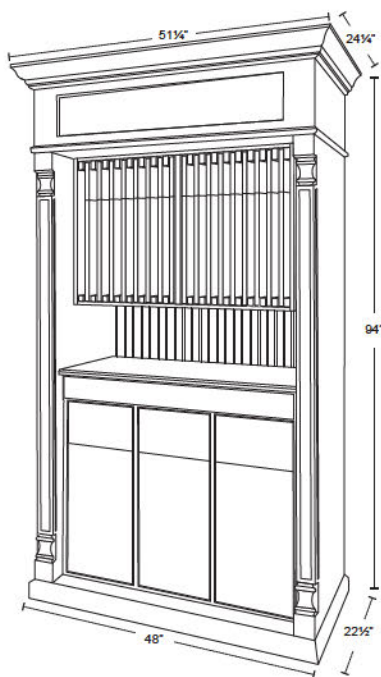

### SELLING CENTER

ITEM	DESCRIPTION	COST PRICE
FSC	FABUWOOD SELLING CENTER	1250

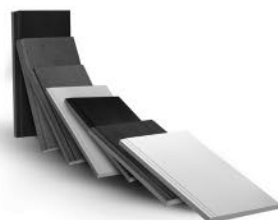

### COLOR BLOCKS

ITEM	DESCRIPTION	COST PRICE
COLOR BLOCK	BOX OF COLOR BLOCKS	25

## Modifications

### CUT ITEMS

ITEM	DESCRIPTION	LIST
CUT-BASE	Reduce depth of base cabinet (min. depth 12")	291
CUT-DBASE	Reduce depth of drawer base cabinet (min. depth 12")	405
CUT-SBASE	Reduce depth of sink base cabinet (no min.)	195
CUT-WALL	Reduce depth of wall cabinet (no min.)	243
CUT-TALL	Reduce depth of tall cabinet (no min.)	565
CUT-DOOR	Cut out center panel of door for glass insert (per door, glass not included)	163
CUT-COLUMN	Reduce depth of column (specify depth)	210
CUT-BASE HEIGHT	Reduce height of base cabinet by cutting off top drawer (total base height: 28½")	242
CUT-TK	Reduce toe kick height (no min.)	97
CUT-PANEL	Cut down a panel to any size	65/Pc.
CUT-ROD	Reduce depth of rollout drawer (specify depth of cabinet)	100

### PIPE CHASE

ITEM	DESCRIPTION	LIST
CHASE-BASE	Make chase in base cabinet	485
CHASE-DBASE	Make chase in drawer base cabinet	700
CHASE-WALL	Make chase in wall cabinet	259
CHASE-TALL	Make chase in tall cabinet	727
CHASE-CORNER	Make chase in corner cabinet (WDC, WPC & ERB only)	968

- *Must supply a drawing for all chase modifications.*

### CUSTOMIZATIONS

ITEM	DESCRIPTION	LIST
CREATE-RETURN WALL	Create a return wall filler up to 6"W x 15"D x 42"H (materials incl.)	375
CREATE-RETURN TALL	Create a return tall filler up to 6"W x 30"D x 96"H (materials incl.)	693
CREATE-COLUMN BASE	Create a 3" column up to 30"D by 34½"H (material incl.)	645
CREATE-COLUMN WALL	Create a 3" column up to 15"D x 42"H (material incl.)	484
CREATE-COLUMN TALL	Create an oversized column	1161
CUSTOM DOOR	Order a custom size door	QUOTE
HAMPER	Install door mounted pull out wood hamper in cabinet (cabinet not incl.)	565
BMC24	Create Base Microwave cabinet from a DB24 cabinet (cabinet not incl.)	439



## Modifications

### MODIFICATIONS

ITEM	DESCRIPTION	LIST
REMOVE-DRAWER	Remove cabinet drawer to create false drawer front	50
CLOSE-BLIND	Close open section of a blind wall or base cabinet	81
ATTACH-TK	Attach toe kick on wall cabinet	97
ATTACH-TK NO SEAM	Attach toe kick on wall cabinet finished side, with no seam on side panel	300
RECESS-TK	Recess toe kick of base cabinet (must supply a drawing)	163
EDGE-BAND	Additional edge banding (price per linear foot)	7
PEN-CABINET	Create a peninsula cabinet from 2 cabinets (cabinets not incl.)	323
INCREASE-WALL	Increase depth on wall cabinet	QUOTE
MATCH-INTERIOR	Stain interior of cabinet to match exterior	QUOTE
SQ BOTTOM	Square bottom shelf for open end cabinet to enable light rail molding	81
FLUSH-BASE	Flush the side of a base cabinet (per side)	266
FLUSH-WALL	Flush the side of a wall cabinet (per side)	224
FLUSH-WALL BOTTOM	Flush the bottom of a wall cabinet	242
FLUSH-TALL	Flush the side of a tall cabinet (per side)	449
FLUSH-TOE KICK	Flush the toe kick of a base cabinet bringing the toe to front (sides not finished)	145
FULL-DOORS	Create a full height door base cabinet from 2 cabinets (cabinets not incl.)	100

### UPGRADES

ITEM	DESCRIPTION	LIST
INSTALL-ACCES	Install any accessory in a cabinet (accessories not incl.)	QUOTE
GLAZE	Custom glazes available for a charge	20%
HIGH-SHEEN	Finish any cabinet with a high sheen	20%

### LOOSE PARTS

ITEM	DESCRIPTION	LIST
SHELF-WALL	Loose 12" deep shelf (specify cabinet size)	70
SHELF-BASE	Loose 24" deep shelf (specify cabinet size)	135
SHELF-DSB	Loose shelf (specify cabinet size)	246
SHELF-TALL	Loose 24" deep shelf (specify cabinet size)	135
SKIN-BASE*	¼" finished plywood to flush side of cabinet	165
SKIN-WALL	¼" finished plywood to flush side of cabinet	110
SKIN-TALL*	¼" finished plywood to flush side of cabinet	273

\* Toe kick to be cut at job site

Many more modifications available- please contact your customer service rep.



## 5 Year Limited Warranty

### COVERAGE OF WARRANTY

Fabuwood Cabinetry Corp ("Fabuwood") is pleased to provide the following limited warranty on all cabinets imported to and assembled and sold in the United States by Fabuwood. This warranty does not cover cabinets sold or shipped outside of the United States. This limited warranty is subject to all limitations, exclusions, disclaimers and procedures set forth herein. Fabuwood warrants to the original purchasing consumer that all cabinets purchased from Fabuwood will be free from all unnatural defects in material and workmanship in accordance with the Fabuwood quality standards sheet under normal residential use for 5 years from the date of the original purchase or as long as the original purchasing consumer owns the home in which such cabinets are installed, whichever is less. This warranty is non transferable to subsequent owners of the home.

### EXCLUSIONS

THIS WARRANTY SUPERSEDES ANY AND ALL PREVIOUS WARRANTIES BY FABUWOOD AND CONSTITUTES THE EXCLUSIVE REMEDY AGAINST FABUWOOD FOR ALL DEFECTS, DAMAGES AND WORKMANSHIP. THERE ARE NO IMPLIED WARRANTIES EXTENDING BEYOND THE TERMS OF THIS WARRANTY. FABUWOOD SHALL NOT BE LIABLE FOR ANY INDIRECT, SPECIAL, PUNITIVE, INCIDENTAL OR CONSEQUENTIAL COSTS, EXPENSES OR DAMAGES. THIS WARRANTY GIVES YOU SPECIFIC LEGAL RIGHTS, AND YOU MAY ALSO HAVE OTHER RIGHTS, WHICH VARY FROM STATE TO STATE. IT IS POSSIBLE THAT ONE OR MORE OF THE LIMITATIONS AND EXCLUSIONS IN THIS WARRANTY MAY NOT APPLY TO YOU. THIS WARRANTY APPLIES ONLY TO FABUWOOD PRODUCTS PURCHASED ON OR AFTER MARCH 15, 2014

### LIMITATIONS

This warranty shall become void if the cabinets, cabinetwork, drawer slides or hinges are modified from its original form, improperly installed or damaged prior to or during the installation, or used in any way other than for residential purposes. This warranty covers only parts and materials of the cabinets as supplied by Fabuwood. This warranty does not cover any products used or installed in connection with cabinets, such as gas or electric appliances, countertops, or plumbing fixtures. This warranty does not apply to products installed in locations that do not maintain year-round environmental controls. This warranty shall not apply to damages caused by transportation, storage, dirt, chemicals, exposure to moisture, humidity or excessive heat or cold, nor does it cover defects arising from normal wear and tear, misuse, neglect, accidents, alterations, improper use or failure to maintain properly, house settling, or acts of God. No installer, retailer, distributor, agent or employee of Fabuwood has the authority to alter the obligations or limitations in this warranty.

### QUALITY STANDARDS

This warranty covers all damages and unnatural defects that are deemed as such under the current Fabuwood Quality Standards sheet. The current Fabuwood Quality Standards sheet is available for download in the dealer login section of the Fabuwood website ([www.fabuwood.com](http://www.fabuwood.com)), which should be reviewed at each time a claim for warranty service is being considered. Fabuwood reserves the right to modify or change the Fabuwood Quality Standards sheet at any time without notice.

### DISCLAIMERS

The following is a brief recap of some of the characteristics of the wood and finishes on the cabinets you are about to purchase. Please read them carefully. If some of these characteristics concern you, please choose something else. We bring these characteristics to your attention so you will realize that Fabuwood will not be held responsible for these variations in your cabinetry. It is important

to note that wood products claimed as defective are most often the result of atmospheric conditions such as excess moisture and humidity. Fabuwood strongly recommends testing the intended location of the products for such conditions prior to installation.

**WOOD AND COLOR VARIATIONS:** Wood is a product of nature, and since no two trees are alike, cabinets may vary in color, texture and grain. Wood characteristics naturally occurring such as variations in color, grain, mineral streaks, pinholes and knots are not considered defects. Color variations in cabinets are also a natural occurrence due to species, age, character of cabinets, and exposure to UV light and sunlight. For these reasons, new and/or replacement cabinets may not match display samples and/or existing cabinets. This may result in overall color variations, but is not considered a defect.

**WOOD DOORS:** Wood by nature will undergo expansion and contraction movements year after year as it compensates and adjusts to ever changing atmospheric humidity and temperature conditions. It is very common for center panels on doors to shrink, expand or move during these transitions. Typically, the panel will return to its normal position within a year once it has adjusted to seasonal changes. It is for these same reasons that it is very common for doors to warp during these periods. Doors that are warped up to 1/4" are not considered defective. Note: It is advisable to check if the door was properly installed, since doors that appear warped are very often the result of improper installation.

**PAINTED FINISHES:** Plywood is a non-porous, smooth grained wood. Additionally, wood by nature undergoes periods of expansion and contraction while it adjusts to atmospheric conditions mentioned above. As such, finish stress lines may become visible on painted cabinets especially at the joints. Any such occurrence is not considered a defect.

**GLAZED FINISHES:** A glazed finish by character is an uneven finish. Some edges and profiles will have heavier hang up than others and glazing may vary cabinet to cabinet, door to drawer and item to item. This may result in overall color variations but is not considered a defect.

### WARRANTY PERFORMANCE

If a defect does occur within the terms and conditions of this warranty such defective part will be repaired or replaced by Fabuwood at its sole discretion. Fabuwood will not provide or pay for the cost of removal of defective product, transportation of defective, repaired or replaced product or installation of repaired or replaced product. Fabuwood will not be responsible for any shipping damages to the defective, replaced or repaired product. If defective item has been discontinued or is not available at the time, Fabuwood reserves the right to replace the item with the most similar item available in Fabuwood's inventory at that time. Fabuwood cannot guarantee that the finish of any replacement will exactly match the finish and appearance of the defective item due to the natural ageing process of the wood and finishes of the cabinets. Fabuwood may require at its discretion that the customer submit a clear photo, or that a company representative view the item being claimed before honoring this warranty.

### CLAIMS

To submit a claim covered under this warranty, the original proof of purchase or a copy must be provided. Please email all documents to [customerservice@fabuwood.com](mailto:customerservice@fabuwood.com).

### NOTE

Please do not send back any items to Fabuwood prior to receiving proper authorization from customer service. Fabuwood takes no responsibility on any items sent back to Fabuwood without proper return authorization.



---

## Dealer Product & Warranty Awareness Form

I have carefully read and understand the entire warranty provided by Fabuwood and have been provided the opportunity to ask questions of, and receive answers from Fabuwood concerning the terms and conditions set forth in the warranty, including, but not limited, to the extent of the coverage therein.

I hereby accept full responsibility (a) to truthfully and accurately represent Fabuwood, and (b) to make sure that anyone selling Fabuwood cabinets under my dealership will properly explain the terms and conditions to the consumer.

I understand that Fabuwood is not liable for any claims made by any consumer that are not covered under the warranty and that I will be solely responsible for any and all losses and expenses arising from such claims. I agree to indemnify, defend and hold Fabuwood harmless from and against such losses and expenses, including, but not limited to, reasonable attorney's fees and expenses.

---

Printed Name

---

Signature

---

Company Name

---

Company Address

---

Witness Printed Name

---

Witness Signature

---

Date



---

## Consumer Product & Warranty Awareness Form

I have read the entire warranty provided by Fabuwood and I understand the terms and conditions set forth by Fabuwood as well as the extent of the coverage of the warranty.

I understand and agree that (Dealer's name) \_\_\_\_\_ will not be liable for any defects and claims that are not covered under the warranty and that I will not hold (Dealer's name) \_\_\_\_\_ responsible for any such defects.

\_\_\_\_\_  
Printed Name

\_\_\_\_\_  
Signature

\_\_\_\_\_  
Company Name

\_\_\_\_\_  
Company Address

\_\_\_\_\_  
Witness Printed Name

\_\_\_\_\_  
Witness Signature

\_\_\_\_\_  
Date

# Account Application

## Part 1

### CUSTOMER IS PURCHASING A:

- ☐ FULL DISPLAY  
☐ SELLING CENTER (\$1,250 \$625 + FREIGHT)  
☐ 30-DAY DISPLAY AGREEMENT

FABUWOOD SALES REP
--------------------

FULL LEGAL NAME OF BUSINESS /DBA NAME (APPLICANT)					DATE	E-MAIL ADDRESS	
ADDRESS					PHONE	FAX	
CITY	STATE	ZIP	COUNTY	WEBSITE	RESALE CERTIFICATE NUMBER		
SHIPPING ADDRESS			CITY	STATE	ZIP	SHIPPING CONTACT	

### APPLICATION MUST BE ACCOMPANIED BY A SIGNED RESALE CERTIFICATE FOR THE APPLICABLE STATE

NATURE OF BUSINESS		ACCOUNTS PAYABLE CONTACT		CREDIT AMOUNT REQUESTED \$	
EST. ANNUAL PURCHASE \$		FEDERAL TAX ID NO. EIN#		YEARS AT LOCATION	
OFFICER/OWNER	TITLE	SSN	RESIDENTIAL ADDRESS		PHONE
OFFICER/OWNER	TITLE	SSN	RESIDENTIAL ADDRESS		PHONE
HAVE YOU DONE BUSINESS WITH FABUWOOD, DIRECTLY, OR WITH A DESIGNER IN THE PAST?					

### BANK REFERENCE

BANK NAME		PHONE		FAX	
ADDRESS		CITY		STATE	ZIP
TYPE OF BANK ACCOUNT	ACCOUNT NUMBER	PERSON TO CONTACT		PHONE	

THE ABOVE INFORMATION IS BEING SUBMITTED FOR THE PURPOSES OF ALLOWING FABUWOOD CABINETRY CORP. ("FABUWOOD") TO COMPLY WITH APPLICABLE MONEY LAUNDERING LAWS. THE APPLICANT HEREBY REPRESENTS AND WARRANTS THAT THE INFORMATION CONTAINED HEREIN, OR SUBMITTED IN CONNECTION HERewith, IS TRUE AND COMPLETE AS OF THE DATE HEREOF AND AGREES TO UPDATE THE INFORMATION WHEN NEEDED. THE APPLICANT HEREBY AUTHORIZES FABUWOOD TO CONTACT AND INVESTIGATE THE REFERENCES, INCLUDING THE BANKS LISTED ABOVE, AND HEREBY AUTHORIZES THE REFERENCES TO RELEASE THE REQUESTED INFORMATION.

IF YOU ARE APPLYING FOR CREDIT, FABUWOOD WILL USE THE ABOVE INFORMATION TO ASSESS AND/OR CONTINUE TO ASSESS CREDIT, SOLELY FOR BUSINESS PURPOSES OF THE APPLICANT. THE APPLICANT HEREBY AGREES TO REMIT PAYMENT WITHIN THE TERMS SPECIFIED ON THE FACE OF EACH INVOICE. IF PAYMENT IS NOT RECEIVED WHEN DUE, THE APPLICANT ALSO AGREES TO PAY A MONTHLY FINANCE CHARGE EQUAL TO ONE AND ONE-HALF PERCENT (1½%) OR THE MAXIMUM AMOUNT ALLOWABLE UNDER THE APPLICABLE STATE OR FEDERAL LAW, OF THE UNPAID DELINQUENT BALANCE UNTIL THE ACCOUNT IS PAID IN FULL. IF THE ACCOUNT IS PLACED IN COLLECTION, THE APPLICANT AGREES TO PAY ALL COSTS AND EXPENSES OF COLLECTION, INCLUDING REASONABLE ATTORNEYS' FEES AND EXPENSES. THE UNDERSIGNED ACKNOWLEDGES THAT NOTHING IN THIS APPLICATION SHALL REQUIRE FABUWOOD TO EXTEND CREDIT OR TO DO BUSINESS IN ANY MANNER WITH THE UNDERSIGNED. THE TERMS OF CREDIT MAY BE CHANGED OR DENIED WITH OR WITHOUT CAUSE AND WITH OR WITHOUT NOTICE, WITHOUT OBLIGATION OR PENALTY, SUBJECT TO APPLICABLE STATE OR FEDERAL LAW.

NAME (PLEASE PRINT)	AUTHORIZED OFFICER'S SIGNATURE REQUIRED	TITLE
---------------------	---	-------



## Account Application

### Part 2 (Credit Application)

COMPANY NAME	ADDRESS (OPTIONAL)	ACCOUNT # (OPTIONAL)
--------------	--------------------	----------------------

#### BANK REFERENCE

BANK NAME	PHONE	FAX	
ADDRESS	CITY	STATE	ZIP
TYPE OF BANK ACCOUNT	ACCOUNT NUMBER	PERSON TO CONTACT	PHONE

#### TRADE REFERENCES

NAME	PHONE	FAX		
ADDRESS	CITY	STATE	ZIP	PERSON TO CONTACT
NAME	PHONE	FAX		
ADDRESS	CITY	STATE	ZIP	PERSON TO CONTACT
NAME	PHONE	FAX		
ADDRESS	CITY	STATE	ZIP	PERSON TO CONTACT

THE ABOVE INFORMATION IS BEING SUBMITTED FOR THE PURPOSES OF ALLOWING FABUWOOD CABINETRY CORP. ("FABUWOOD") TO COMPLY WITH APPLICABLE MONEY LAUNDERING LAWS. THE APPLICANT HEREBY REPRESENTS AND WARRANTS THAT THE INFORMATION CONTAINED HEREIN, OR SUBMITTED IN CONNECTION HERewith, IS TRUE AND COMPLETE AS OF THE DATE HEREOF AND AGREES TO UPDATE THE INFORMATION WHEN NEEDED. THE APPLICANT HEREBY AUTHORIZES FABUWOOD TO CONTACT AND INVESTIGATE THE REFERENCES, INCLUDING THE BANKS LISTED ABOVE, AND HEREBY AUTHORIZES THE REFERENCES TO RELEASE THE REQUESTED INFORMATION.

IF YOU ARE APPLYING FOR CREDIT, FABUWOOD WILL USE THE ABOVE INFORMATION TO ASSESS AND/OR CONTINUE TO ASSESS CREDIT, SOLELY FOR BUSINESS PURPOSES OF THE APPLICANT. THE APPLICANT HEREBY AGREES TO REMIT PAYMENT WITHIN THE TERMS SPECIFIED ON THE FACE OF EACH INVOICE. IF PAYMENT IS NOT RECEIVED WHEN DUE, THE APPLICANT ALSO AGREES TO PAY A MONTHLY FINANCE CHARGE EQUAL TO ONE AND ONE-HALF PERCENT (1½%) OR THE MAXIMUM AMOUNT ALLOWABLE UNDER THE APPLICABLE STATE OR FEDERAL LAW, OF THE UNPAID DELINQUENT BALANCE UNTIL THE ACCOUNT IS PAID IN FULL. IF THE ACCOUNT IS PLACED IN COLLECTION, THE APPLICANT AGREES TO PAY ALL COSTS AND EXPENSES OF COLLECTION, INCLUDING REASONABLE ATTORNEYS' FEES AND EXPENSES. THE UNDERSIGNED ACKNOWLEDGES THAT NOTHING IN THIS APPLICATION SHALL REQUIRE FABUWOOD TO EXTEND CREDIT OR TO DO BUSINESS IN ANY MANNER WITH THE UNDERSIGNED. THE TERMS OF CREDIT MAY BE CHANGED OR DENIED WITH OR WITHOUT CAUSE AND WITH OR WITHOUT NOTICE, WITHOUT OBLIGATION OR PENALTY, SUBJECT TO APPLICABLE STATE OR FEDERAL LAW.

NAME (PLEASE PRINT)	AUTHORIZED OFFICER'S SIGNATURE REQUIRED	TITLE
---------------------	---	-------

TO SUPPORT THIS APPLICATION FOR CREDIT, PLEASE ATTACH LATEST FISCAL YEAR END INCOME SHEET AND BALANCE STATEMENT AND SUBMIT TO YOUR SALES REP FOR PROCESSING.

CREDIT DEPARTMENT: T: (201) 432-6555 F: (201) 326-5133 E: [CREDIT@FABUWOOD.COM](mailto:CREDIT@FABUWOOD.COM)  
ALL FIELDS MUST BE FILLED OUT PROPERLY IN ORDER FOR THIS APPLICATION TO BE PROCESSED



## 12" - 27" High & 24" Deep Wall Cabinets

12"

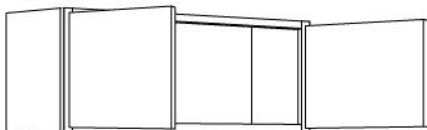

12"

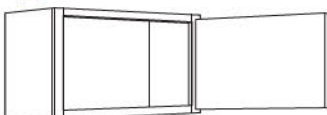

\* single door cabinet

12"

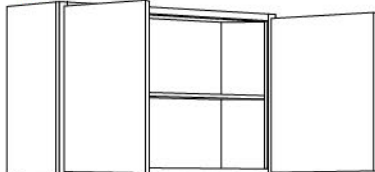

24"

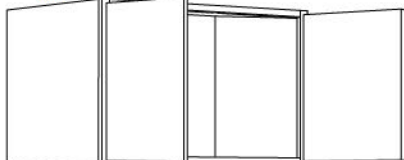

\*\* has one shelf

### 12" - 21" HIGH

ITEM	B	E
W3012	256	301
W3312	265	312
W3612	276	324
W4212	410	482
W4812	473	557
W2115*	243	285
W2415	247	291
W3015	265	312
W3315	274	324
W3615	285	335
W2418	274	323
W3018	276	324
W3318	285	335
W3618	294	347
W3021**	298	350

### 24" - 27" HIGH

ITEM	B	E
W2424	295	350
W3024	344	405
W3324	378	437
W3624	393	462
W3027	408	480

### 24" DEEP

ITEM	B	E
W301524	385	453
W301824	406	478
W302424*	555	654
W331224	528	575
W331524	537	586
W331824	547	598
W332424*	641	700
W361224	406	478
W361524	442	521
W361824	456	537
W362424*	639	752
W481224**	577	662

\* has 1 shelf    \*\* has a center stile

## 30" High Wall Cabinets

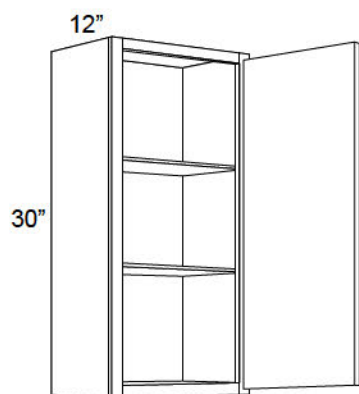

### SINGLE DOOR

ITEM	B	E
W0930	226	266
W1230	246	289
W1530	256	301
W1830	294	347
W2130	324	382

- Peninsula cabinet modification available on pg. XI

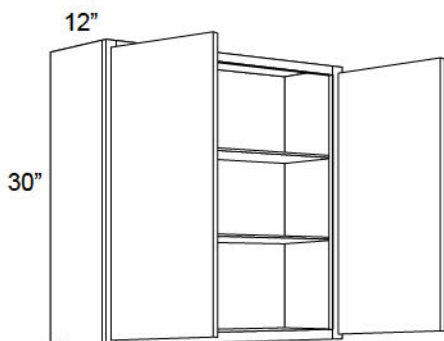

### DOOR WALL

ITEM	B	E
W2430	395	466
W2730	413	487
W3030	423	498
W3330	442	521
W3630	461	544
W3930*	582	686
W4230*	630	743

- Peninsula cabinet modification available on pg. XI
- \* Has 1½" center stile

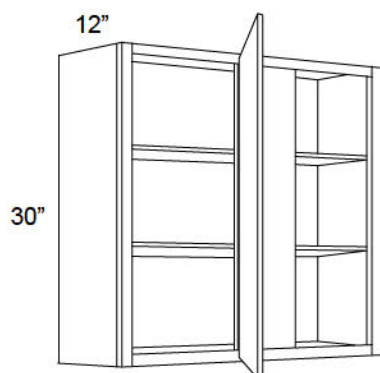

### SINGLE DOOR BLIND

ITEM	B	E
WBC3630	442	521

- Must use filler on adjacent side (not supplied)
- Measurements are rounded off to closest ⅛"

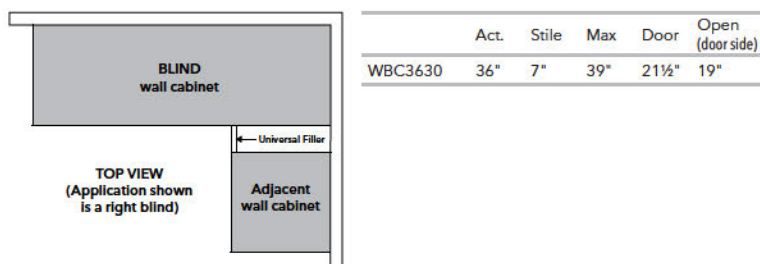

## 30" High Wall Cabinets

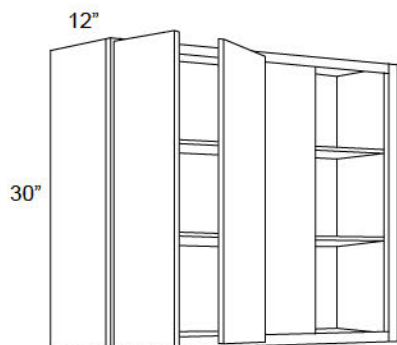

### DOUBLE DOOR BLIND

ITEM	B	E
WBC3930	521	614
WBC4230	648	764

- Must use filler on adjacent side (not supplied)
- Measurements are rounded off to closest 1/8"

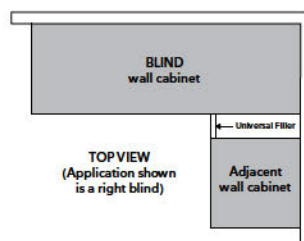

	Act.	Stile	Max	Door	Open
WBC3930	39"	7"	42"	12 1/4"	10 1/4"
WBC4230	42"	7"	45"	13 1/2"	11 1/4"

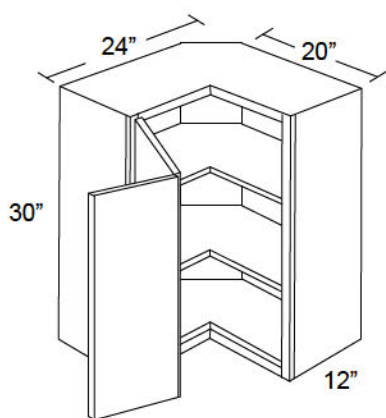

### PIE CUT CORNER

ITEM	B	E
WPC2430	599	705

- Soft close hinge not available

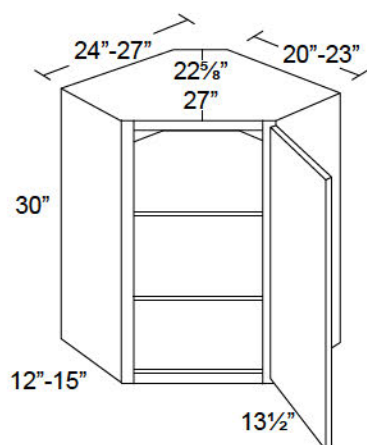

### DIAGONAL CORNER

ITEM	B	E
WDC2430	504	594
WDC2730	597	703

- Uses 3/8" overlay hinge
- Frame is flush with side panel
- Lazy Susan available on pg. 30



## 36" High Wall Cabinets

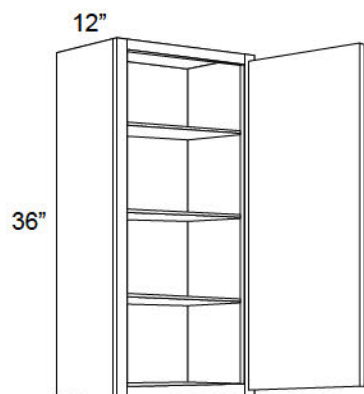

### SINGLE DOOR

ITEM	B	E
W0936	265	312
W1236	290	342
W1536	305	358
W1836	344	405
W2136	388	457

- Peninsula cabinet modification available on pg. XI

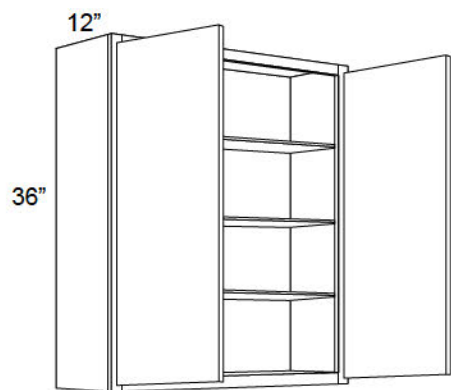

### DOUBLE DOOR

ITEM	B	E
W2436	473	557
W2736	492	579
W3036	501	591
W3336	540	637
W3636	575	677
W3936*	630	743
W4236*	725	854

- Peninsula cabinet modification available on pg. XI

\* Has 1½" center stile

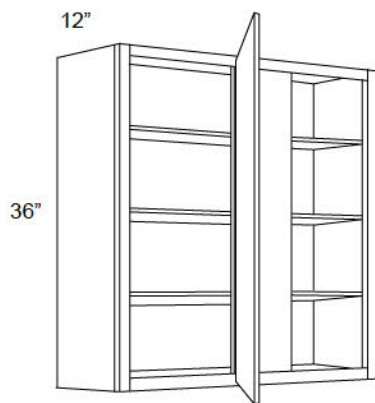

### SINGLE DOOR BLIND

ITEM	B	E
WBC3636	516	607

- Must use filler on adjacent side (not supplied)
- Measurements are rounded off to closest ⅛"

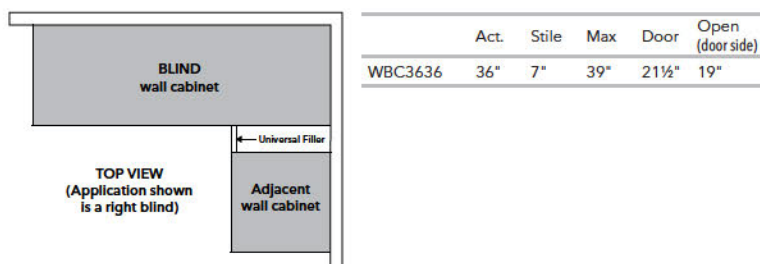

## 36" High Wall Cabinets

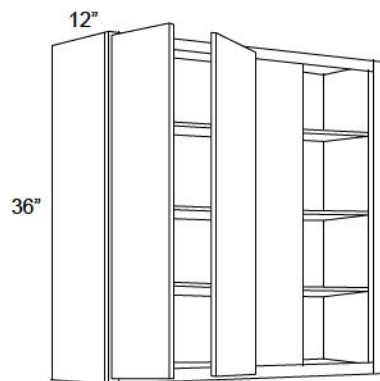

### DOUBLE DOOR BLIND

ITEM	B	E
WBC3936	584	688
WBC4236	688	810

- Must use filler on adjacent side (not supplied)
- Measurements are rounded off to closest 1/8"

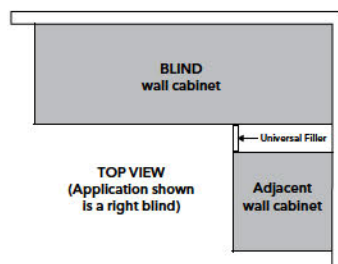

	Act.	Stile	Max	Door	Open
WBC3936	39"	7"	42"	12 1/8"	10 1/4"
WBC4236	42"	7"	45"	13 1/2"	11 1/4"

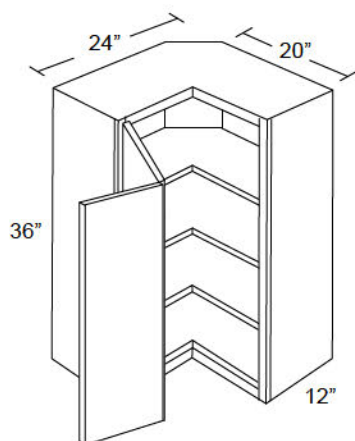

### PIE CUT CORNER

ITEM	B	E
WPC2436	704	729

- Soft close hinge not available

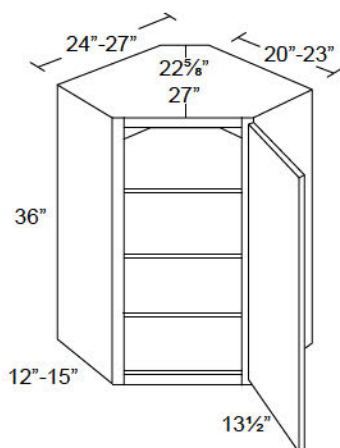

### DIAGONAL CORNER

ITEM	B	E
WDC2436	540	636
WDC2736	644	759

- Uses 3/8" overlay hinge
- Frame is flush with side panel
- Lazy Susan available on pg. 30

## 42" High Wall Cabinets

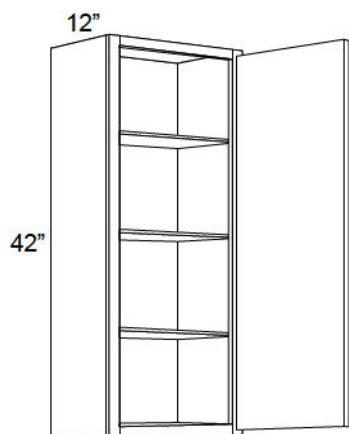

### SINGLE DOOR

ITEM	B	E
W0942	305	358
W1242	332	391
W1542	353	416
W1842	393	462
W2142	452	533

- Peninsula cabinet modification available on pg. XI

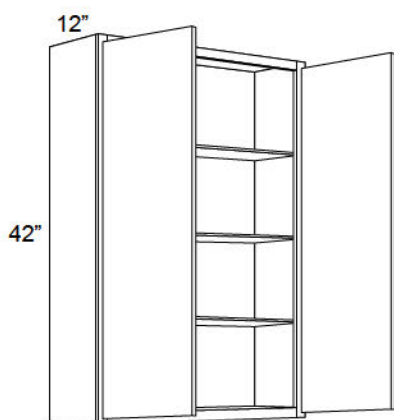

### DOUBLE DOOR

ITEM	B	E
W2442	521	614
W2742	570	671
W3042	580	683
W3342	639	752
W3642	688	810
W3942*	803	945
W4242*	851	1002

- Peninsula cabinet modification available on pg. XI

\* Has 1½" center stile

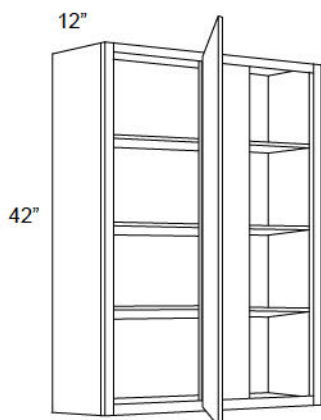

### SINGLE DOOR BLIND

ITEM	B	E
WBC3642	589	694

- Must use filler on adjacent side (not supplied)
- Measurements are rounded off to closest ⅛"

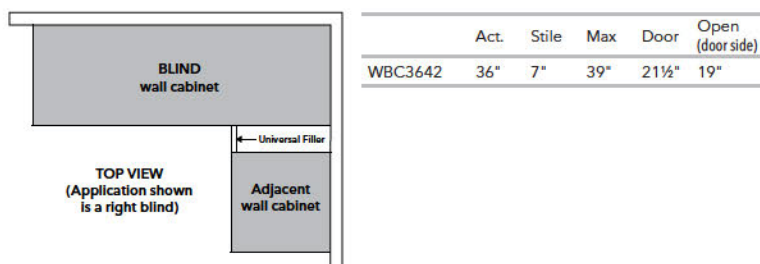



## 42" & 48" High Wall Cabinets

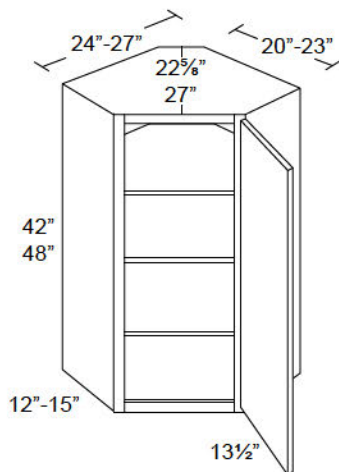
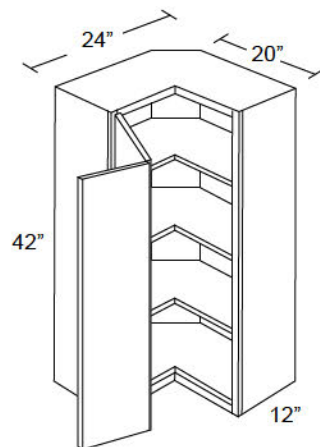
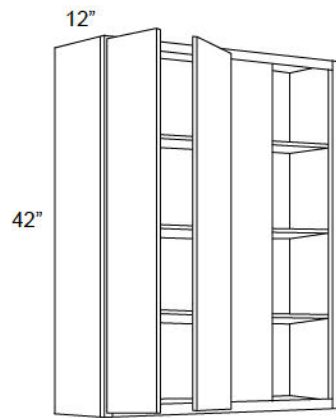

### DOUBLE DOOR BLIND

ITEM	B	E
WBC3942	648	764
WBC4242	727	856

- Must use filler on adjacent side (not supplied)
- Measurements are rounded off to closest 1/8"

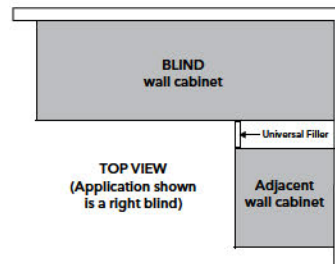

	Act.	Stile	Max	Door	Open
WBC3942	39"	7"	42"	12 1/8"	10 1/4"
WBC4242	42"	7"	45"	13 1/2"	11 3/4"

### PIE CUT CORNER

ITEM	B	E
WPC2442	807	951

- Soft close hinge not available

### DIAGONAL CORNER

ITEM	B	E
WDC2442	643	757
WDC2742	756	891
WDC2748	836	985

- Uses 3/8" overlay hinge
- Frame is flush with side panel
- Lazy Susan available on pg. 30

## Specialty Wall Cabinets

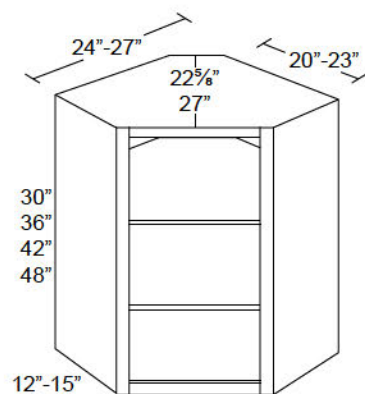
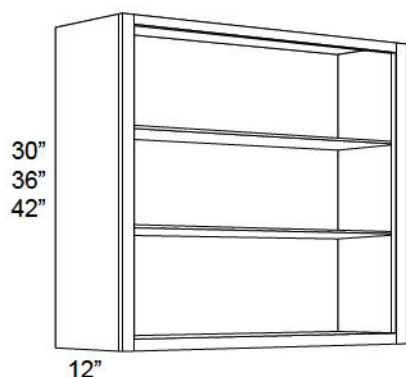

### NO DOOR

ITEM	B	E
NDW1530	290	342
NDW1830	328	386
NDW3030	416	490
NDW3630	423	497
NDW1536*	345	406
NDW1836*	376	444
NDW3036*	490	577
NDW3636*	544	641
NDW1542*	399	471
NDW1842*	425	500
NDW3042*	563	663
NDW3642*	668	787

- Door not included. Designed to use with glass doors. See glass doors listed on pages 11-13
- Has hinges installed
- Cabinet comes pre-drilled for hinges. Fabuwood can fill up hinge holes for additional charge.
- Finished interior
- Adjustable 1/4" thick tempered glass shelves
- Increased or decreased depth cabinets will come with matching interior wood shelves instead of glass shelves.
- \* Has three shelves

### DIAGONAL CORNER NO DOOR

ITEM	B	E
NDWDC2430	687	809
NDWDC2730	720	849
NDWDC2436*	807	951
NDWDC2736*	833	977
NDWDC2442*	853	1004
NDWDC2742*	895	1054
NDWDC2748*	981	1155

- Door not included. Designed to use with glass doors. See glass doors listed on pages 11-13
- Comes with 3/8" overlay hinge installed
- Cabinet comes pre-drilled for hinges. Fabuwood can fill up hinge holes for additional charge.
- Finished interior
- Frame is flush with side panel
- Adjustable 1/4" thick tempered glass shelves
- Increased or decreased depth cabinets will come with matching interior wood shelves instead of glass shelves.
- \* Has three shelves

## Specialty Wall Cabinets

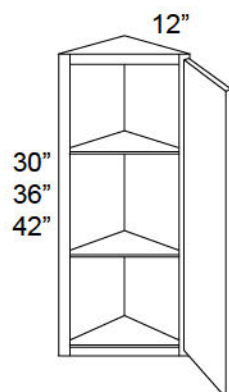

### ANGLE END

ITEM	B	E
WAE1230	301	354
WAE1236*	343	404
WAE1242*	393	462

- Can use glass door from a 30" wide wall cabinet
- will require a 1" overlay hinge
- Adjustable shelves
- \* Has three shelves

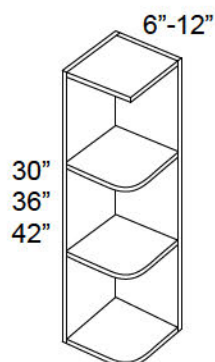

### OPEN END

ITEM	B	E
OE630	381	381
OE1230	381	381
OE636	449	449
OE1236	449	449
OE642*	486	486
OE1242*	486	486

- Comes as 12" (Fabuwood will cut to 6" at no charge)
- For square-bottom shelf, see modifications page X
- \* Has three shelves

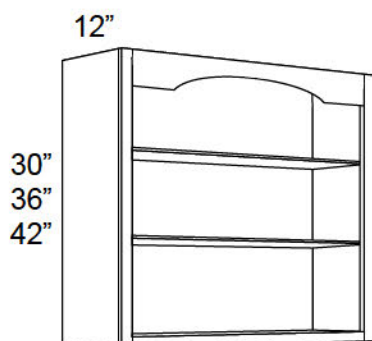

### OPEN SHELF

ITEM	B	E
WOS1830	357	420
WOS3030	509	599
WOS1836*	404	475
WOS3036*	605	712
WOS1842*	452	532
WOS3042*	687	809

- Finished interior
- Arch valance
- Adjustable shelves
- Ogee edge on shelves
- \* Has three shelves



## Specialty Wall Cabinets

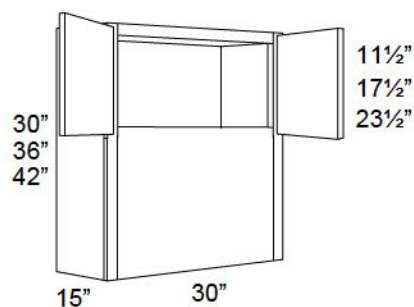

### MICROWAVE

ITEM	B	E
MC303015	630	743
MC303615	791	932
MC304215	859	1012

- Side panels are 3/4" thick flush with face frame.
- Cut opening on job site
- Max. cut-out 28"x16 1/4"
- Center panel is MDF material, slightly recessed from the frame.

*Note: To avoid damage to the frame & side panels, please apply extra care when cutting the front panel.*

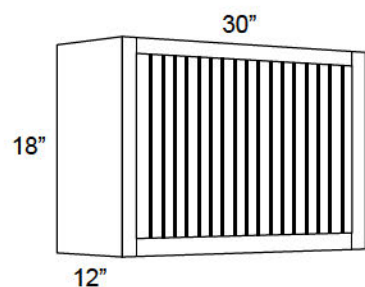

### PLATE RACK

ITEM	B	E
PR3018	425	500

- Finished interior
- 2" space between dividers (fits 11 plates)
- Cabinet can be modified

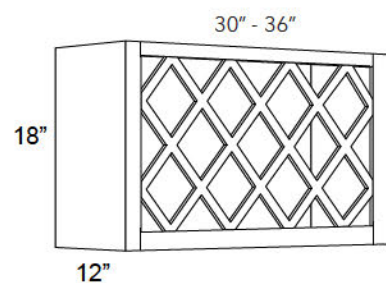

### WINE RACK

ITEM	B	E
WR3018*	357	420
WR3618**	387	455

- Finished interior
- Cabinet can be modified
- \* Cubes are 2 3/4" X 2 3/4" (fits 14 bottles)
- \*\* Cubes are 2 3/4" X 2 3/4" (fits 18 bottles)

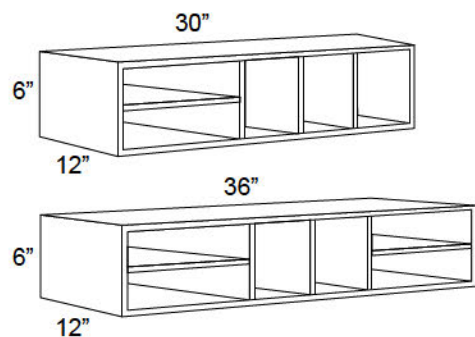

### ORGANIZER

ITEM	B	E
WO306	139	163
WO366	171	201

- Wood veneer edge banding
- Finished interior

## 30" Specialty Doors

Glass doors are pre-installed with clear glass.

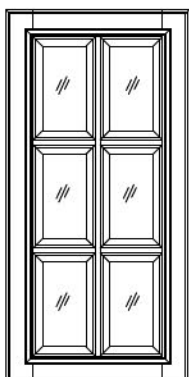

**STYLE-A**

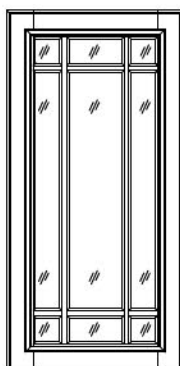

**STYLE-B**

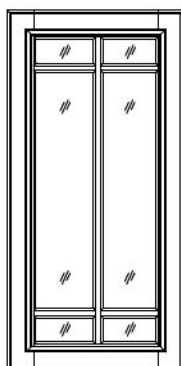

**MDW1530B**

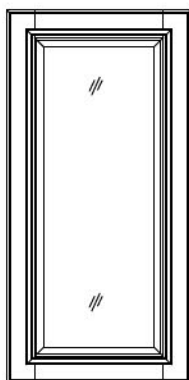

**STYLE-D**

### TRUE DIVIDED LITES

ITEM	B	E
MDWDC2430A*	208	222
MDWDC2730A*	219	234
MDW1530A	219	234
MDW1830A	263	281
MDW3030A**	222	237
MDW3630A**	265	283

- Beveled glass
- Glass held in place by wood moulding
- \* 13½" wide
- \*\* Requires two per cabinet

### SINGLE PANE

ITEM	B	E
MDWDC2430B*	142	152
MDWDC2730B*	150	159
MDW1530B	148	158
MDW1830B	173	184
MDW3030B**	150	160
MDW3630B**	175	186

- Glass held in place by wood moulding
- \* 13½" wide
- \*\* Requires two per cabinet

### SINGLE BEVEL GLASS

ITEM	B	E
BGWDC2430D*	99	105
BGWDC2730D*	104	112
BGW1530D	103	111
BGW1830D	121	130
BGW3030D**	104	112
BGW3630D**	122	131

- Glass held in place by wood moulding
- \* 13½" wide
- \*\* Requires two per cabinet

## 36" Specialty Doors

Glass doors are pre-installed with clear glass.

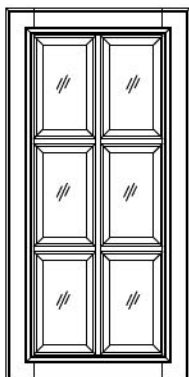

**STYLE-A**

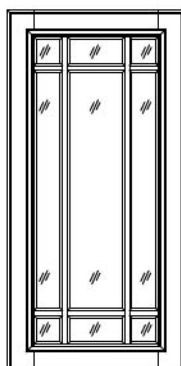

**STYLE-B**

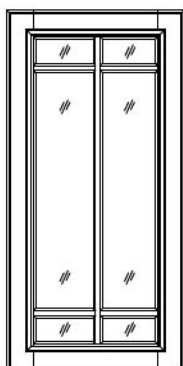

**MDW1536B**

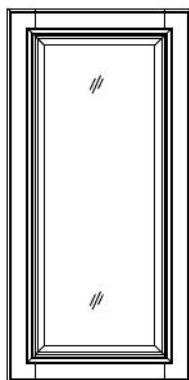

**STYLE-D**

### TRUE DIVIDED LITES

ITEM	B	E
MDWDC2436A*	249	266
MDWDC2736A*	262	280
MDW1536A	263	281
MDW1836A	315	336
MDW3036A**	266	284
MDW3636A**	319	340

- Beveled glass
- Glass held in place by wood moulding
- \* 13½" wide
- \*\* Requires two per cabinet

### SINGLE PANE

ITEM	B	E
MDWDC2436B*	168	180
MDWDC2736B*	177	188
MDW1536B	176	188
MDW1836B	205	219
MDW3036B**	178	189
MDW3636B**	206	221

- Glass held in place by wood moulding
- \* 13½" wide
- \*\* Requires two per cabinet

### SINGLE BEVEL GLASS

ITEM	B	E
BGWDC2436D*	118	125
BGWDC2736D*	123	132
BGW1536D	123	132
BGW1836D	143	153
BGW3036D**	124	133
BGW3636D**	144	155

- Glass held in place by wood moulding
- \* 13½" wide
- \*\* Requires two per cabinet



## 42" & 48" Specialty Doors

Glass doors are pre-installed with clear glass.

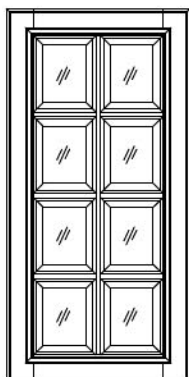

**STYLE-A**

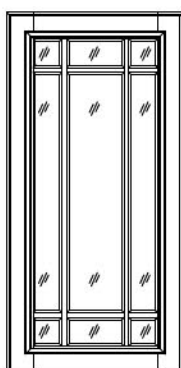

**STYLE-B**

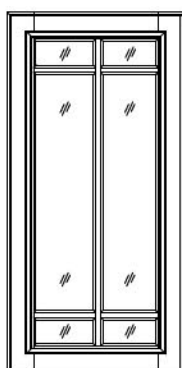

**MDW1542B**

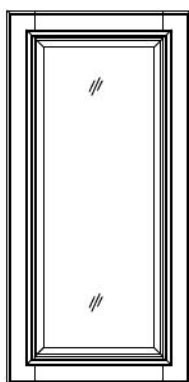

**STYLE-D**

### TRUE DIVIDED LITES

ITEM	B	E
MDWDC2442A*	291	310
MDWDC2742A*	306	326
MDWDC2748A*	327	368
MDW1542A	307	327
MDW1842A	368	392
MDW3042A**	311	332
MDW3642A**	371	396

- Beveled glass
- Glass held in place by wood moulding
- \* 13½" wide
- \*\* Requires two per cabinet

### SINGLE PANE

ITEM	B	E
MDWDC2442B*	195	208
MDWDC2742B*	204	218
MDWDC2748B*	218	247
MDW1542B	204	218
MDW1842B	237	252
MDW3042B**	206	220
MDW3642B**	239	255

- Glass held in place by wood moulding
- \* 13½" wide
- \*\* Requires two per cabinet

### SINGLE BEVEL GLASS

ITEM	B	E
BGWDC2442D*	136	145
BGWDC2742D*	143	153
BGWDC2748D*	153	184
BGW1542D	142	152
BGW1842D	165	177
BGW3042D**	144	154
BGW3642D**	167	178

- Glass held in place by wood moulding
- \* 13½" wide
- \*\* Requires two per cabinet

## Wood Hoods

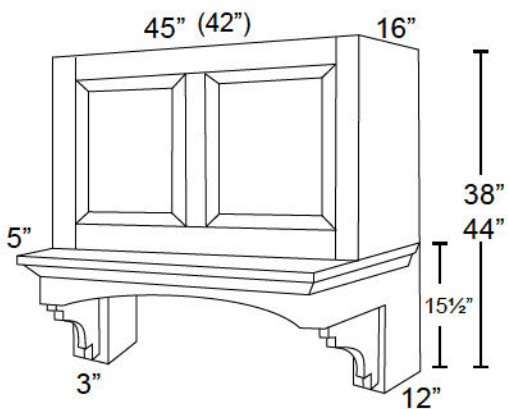
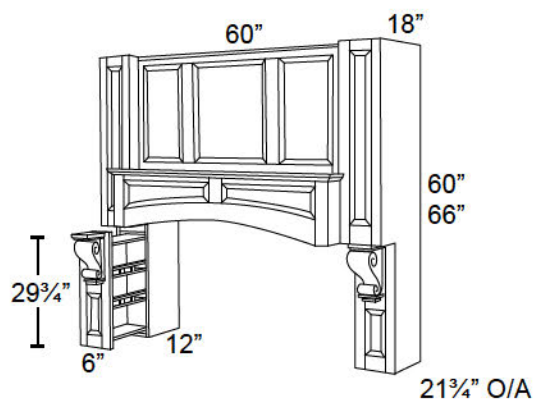
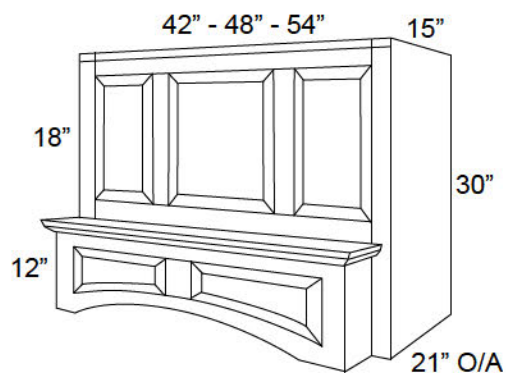

### ARCHED HOOD

ITEM	B	E
RHA423018*	2285	2745
RHA483018	2454	2802
RHA543018	2633	3090

- Hood depth can be increased
- \* Not available in Shaker Natural

Interior Dimensions of hood liner:

RHA423018 40 3/8"	RHA483018 46 7/8"	RHA543018 52 3/8"
max. fan size: 40 3/8" x 13 3/4"	max. fan size: 46 7/8" x 13 3/4"	max. fan size: 52 3/8" x 13 3/4"
36"	42"	48"

### ARCHED HOOD WITH SPICE RACKS

ITEM	B	E
RHS6060	3339	4012
RHS6066	3458	4057

- Hood cannot be modified

Interior Dimensions of hood liner:

47"
max. fan size: 47" x 14 3/4"
19 7/8"

### CAMBRIDGE HOOD

ITEM	B	E
RHC4238	1634	1875
RHC4244	1705	2049

- Must use 1 1/2" filler on each side
- Hood can not be modified

Interior Dimensions of hood liner:

36"
max. fan size: 36" x 14 3/4"
18 3/4"

## Wood Hoods

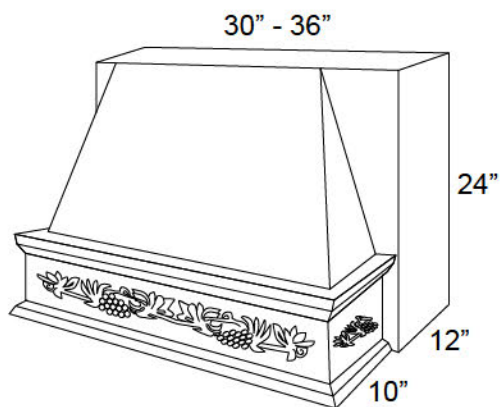

### ENGLISH HOOD

ITEM	B	E
RHE3024	1268	1352
RHE3624	1420	1595

- Hood depth can be increased
- Flower can be removed for additional charge

Interior Dimensions of hood liner:

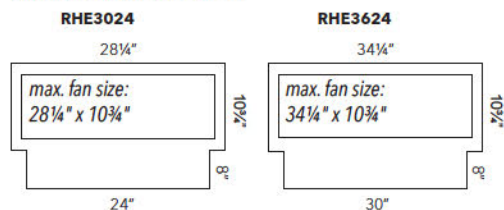

### TOP HOOD LINER

ITEM	B	E
HOOD LINER	158	158

- Top hood liner comprised of plywood lined with stainless steel
- Available for any Fabuwood hood

### CUSTOM FULL HOOD LINER

ITEM	B	E
CUSTOM HOOD LINER-30/36	317	317
CUSTOM HOOD LINER-42	392	392
CUSTOM HOOD LINER-48/54/60	452	452

- Hood interior is covered with stainless liner



## Base Cabinets

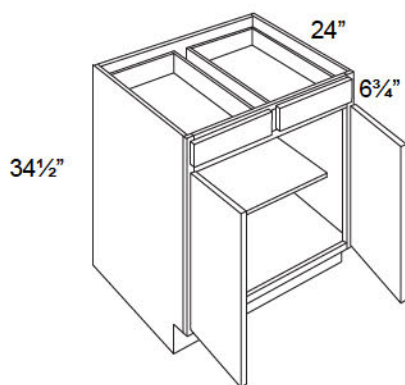
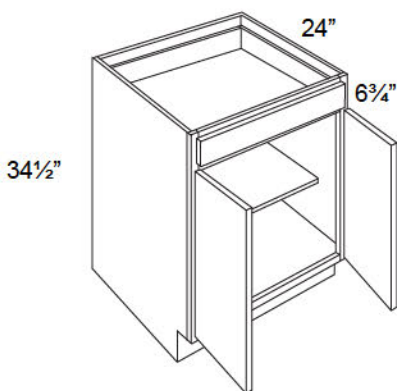
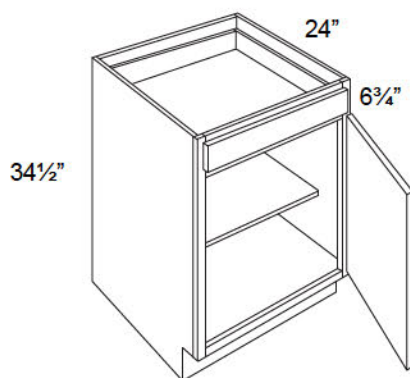

### SINGLE DOOR

ITEM	B	E
B09FD*	294	347
B12	397	468
B15	416	491
B18	446	525
B21	476	560

- \* Has a full height door without a drawer and shelf
- \* B09 accessories available on pg. 27
- Trash can available on pg. 26
- Cutlery divider available on pg. 29
- Peninsula cabinet modification available on pg. XI
- Roll Out available on pg. 31

### DOUBLE DOOR

ITEM	B	E
B24	524	618
B27	574	676
B30	614	722

- Cutlery divider available on pg. 29
- Peninsula cabinet modification available on pg. XI
- Roll Out available on pg. 31

### DOUBLE DOOR & DRAWER

ITEM	B	E
B33	706	831
B36	745	877
B39*	794	935
B42*	844	993
B48*	902	1066

- \* Has 2 5/8" center stile
- Cutlery divider available on pg. 29
- Peninsula cabinet modification available on pg. XI
- Roll Out available on pg. 31

## Base Cabinets

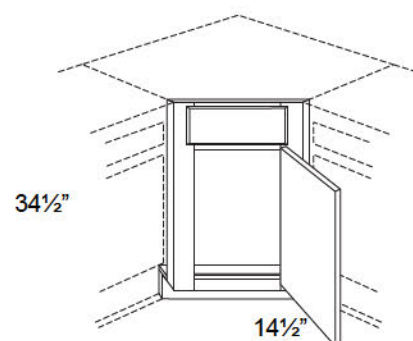
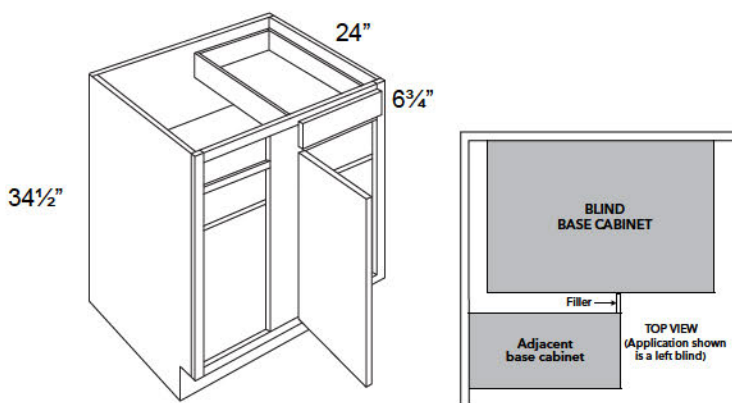
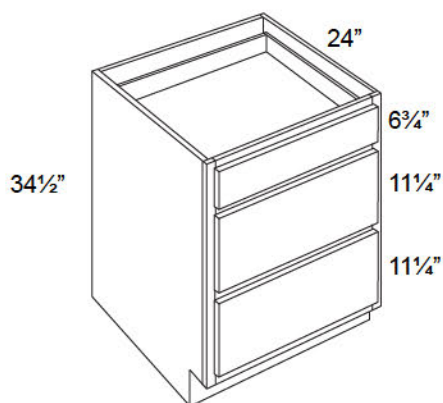

### DRAWER

ITEM	B	E
DB12	693	765
DB15	701	785
DB18	721	809
DB21	742	832
DB24	783	878
DB30	941	1055
DB36	1151	1291

- Cutlery divider available on pg. 29

### BLIND

ITEM	B	E
BLB36/39	682	804
BLB39/42	761	896
BLB42/45	849	1000
BLB48/51	850	1003

- Must use filler on adjacent side (not supplied)
- Measurements are rounded off to closest 1/8"

	Act.	Min.	Max	Door	Stile	Open
BLB36/39	26 1/2"	36"	41 1/2"	9 3/4"	9"	7 1/4"
BLB39/42	32 1/2"	39"	45"	12 1/4"	9 3/4"	9 3/4"
BLB42/45	38 1/2"	42"	48"	15 1/8"	9 3/4"	12 3/4"
BLB48/51	48"	48"	51"	21 1/4"	7 3/8"	18 3/4"

### DIAGONAL SINK FRONT

ITEM	B	E
DSF36*	158	186
DSFL36**	103	103

\* DSF36 The sink front has a 17" face dimension

\*\* DSFL36 The floor must be ordered separately

- Uses 3/8" overlay hinge
- Tilt Out available on pg. 28

## Base Cabinets

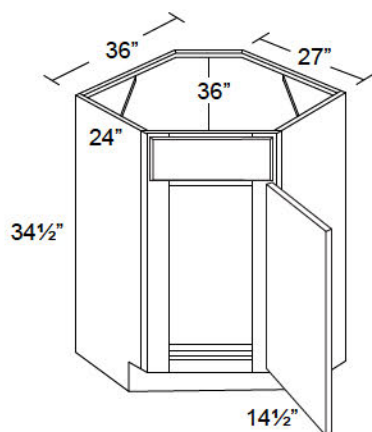

### DIAGONAL SINK

ITEM	B	E
DSB36	682	806

- Uses  $\frac{3}{8}$ " overlay hinge
- Tilt Out available on pg. 28

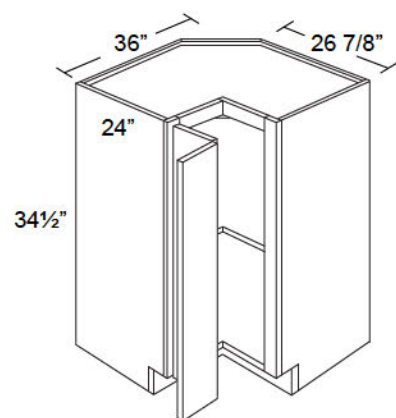

### EASY REACH

ITEM	B	E
ERB36	943	1110

- Center shelf is adjustable
- Soft close hinge not available
- Once assembled, doors cannot be reversed

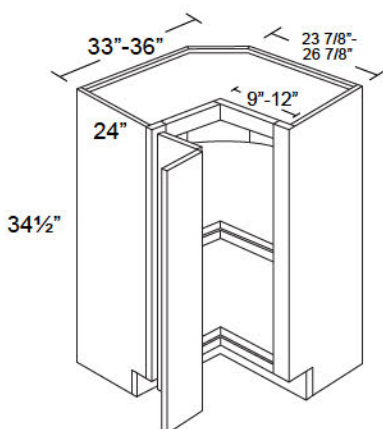

### LAZY SUSAN

ITEM	B	E
LSB33	1149	1356
LSB36	1164	1371

- Both wooden Lazy Susan trays rotate independently, center tray is mounted on 18mm ( $\frac{3}{4}$ ") adjustable shelf
- Soft close hinge not available
- Once assembled, doors cannot be reversed

## Base Cabinets

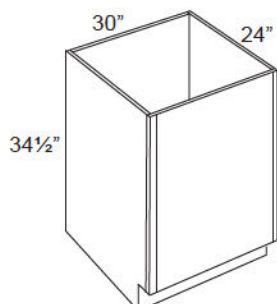
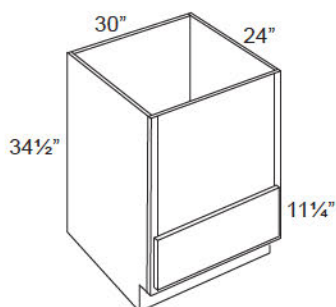
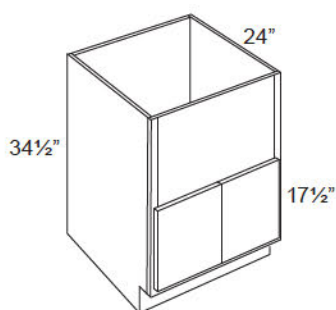
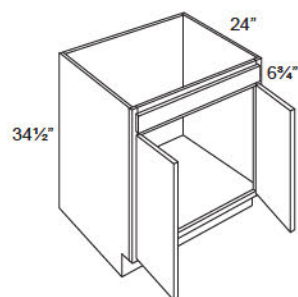

### SINK

ITEM	B	E
SB24	442	524
SB27	482	571
SB30	511	602
SB33	521	614
SB36	540	637
SB39*	582	686
SB42*	630	743
SB48*	784	923

- \* Has two drawer fronts
- Tilt Out available on pg. 28

### FARM SINK

ITEM	B	E
FARM SINK 30	1081	1081
FARM SINK 33	1095	1095
FARM SINK 36	1107	1107

- Cut opening on job site
- Only sold assembled
- May have extended ETA
- Center panel is MDF material, slightly recessed from the frame.

Note: To avoid damage please apply extra care when cutting the front panel.

### MICROWAVE

ITEM	B	E
BMC	771	909

- Cut opening on job site
  - Center panel is MDF material, slightly recessed from the frame.
  - One functioning bottom drawer
  - BMC24" available on pg. X
  - Maximum cut out size
- is 28 1/2"x16 1/4"
- Space from shelf to top of cabinet is 17 3/4"
- Note: To avoid damage to the frame & side panels, please apply extra care when cutting the front panel.

### OVEN

ITEM	B	E
BOC	677	797

- Cut opening on job site
- Center panel is MDF material, slightly recessed from the frame.
- Maximum cut out size is 28 1/2"x28"

Note: To avoid damage to the frame & side panels, please apply extra care when cutting the front panel.



## Base End & Angle Cabinets

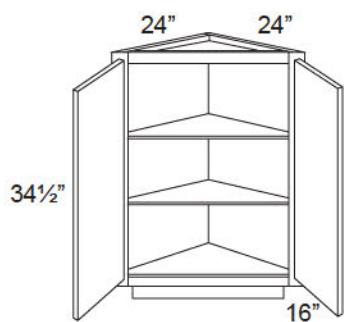

### ANGLE END

ITEM	B	E
BEC24	614	723

- 45° - Two butted doors
- Adjustable shelves

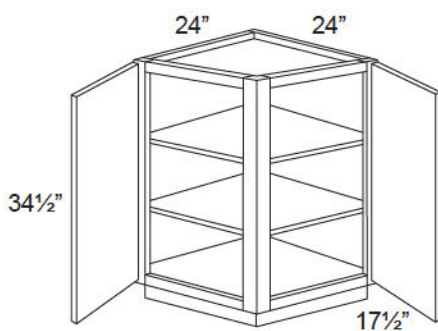

### RETURN ANGLE

ITEM	B	E
BRA24	664	759

- Adjustable shelves

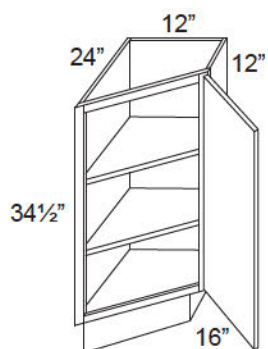

BASE TRANSITIONAL RIGHT  
SHOWN

### TRANSITIONAL

ITEM	B	E
BTR12	457	538
BTL12	457	538

## Pantry Cabinets

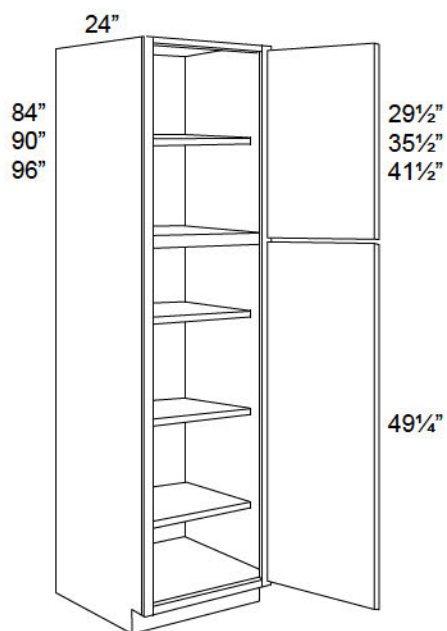

### SINGLE DOOR

ITEM	B	E
TP152484	1002	1181
TP182484	1176	1385
TP152490	1048	1234
TP182490	1233	1453
TP152496	1097	1292
TP182496	1290	1519

- 21" deep shelves  
84" high - 5 shelves  
90" & 96" high - 6 shelves
- Roll Out available on pg. 31

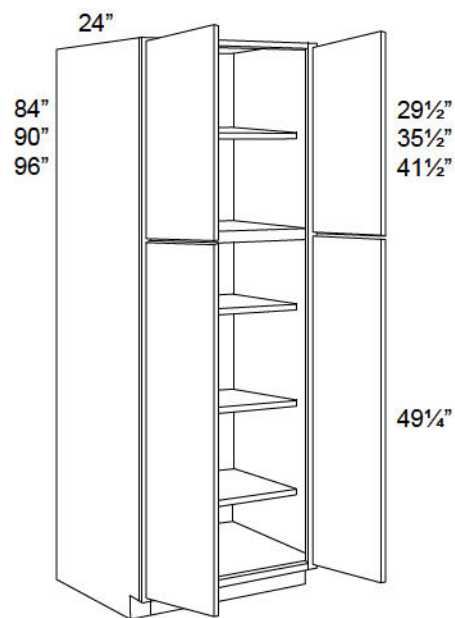

### DOUBLE DOOR

ITEM	B	E
TP242484	1414	1665
TP302484	1647	1940
TP242490	1487	1752
TP302490	1838	2164
TP242496	1561	1838
TP302496	2029	2390

- 21" deep shelves  
84" high - 5 shelves  
90" & 96" high - 6 shelves
- Roll Out available on pg. 31

## Oven Cabinets

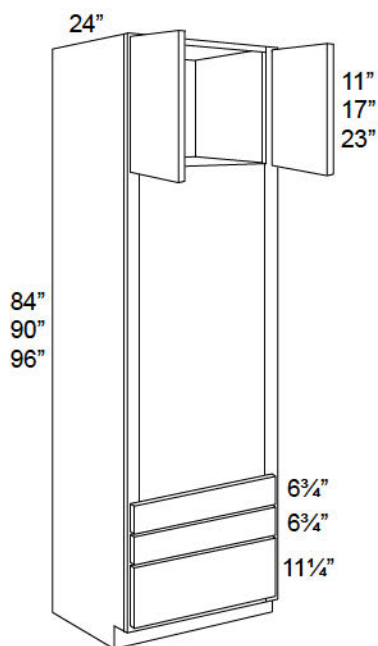

### OVEN CABINET

ITEM	B	E
OC3384	2241	2639
OC3390	2348	2766
OC3396*	2457	2894

- \* Has 1 shelf in top cabinet.
- Center panel is MDF material, slightly recessed from the frame.

#### When using a Single Oven:

- Full panel face frame to be trimmed on site
- Maximum **cut out** width is 31"
- Maximum **cut out** height is 42½"
- Maximum **overall** oven height is 43"

#### When using a Double Oven:

- Full panel face frame to be trimmed on site
- Minimum **cut out** width is 27"
- Maximum **cut out** width is 31"
- Maximum **cut out** height is 56"
- Maximum **overall** oven height is 56½"

Please include size of oven cut out in your order.

Full panel face frame to be trimmed on site (not by Fabuwood).

**Note:** To avoid damage to the frame & side panels, please apply extra care when cutting the front panel.

### SPECIFICATION FOR OVEN CABINET

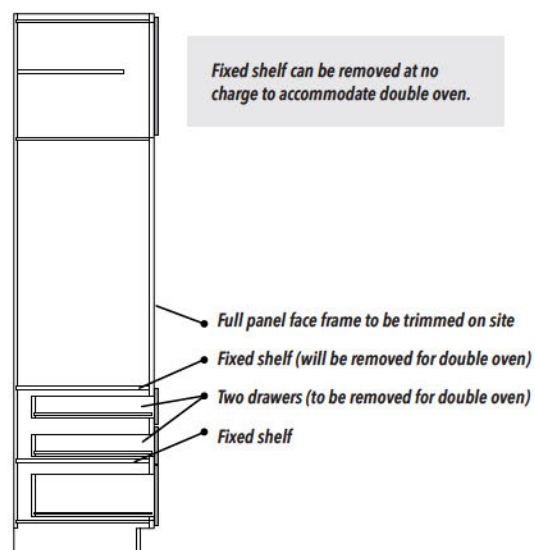

## 34½" High Vanities

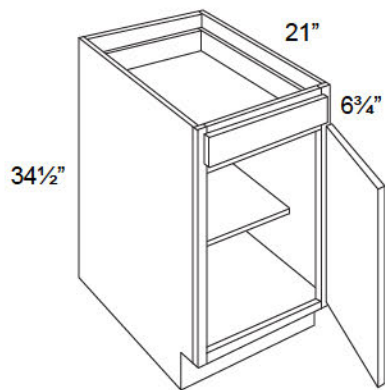

### VANITY BASE

ITEM	B	E
VB12-34	397	468
VB15-34	416	491

- 2" Clearance between drawer and back panel
- Shelf depth: 15"

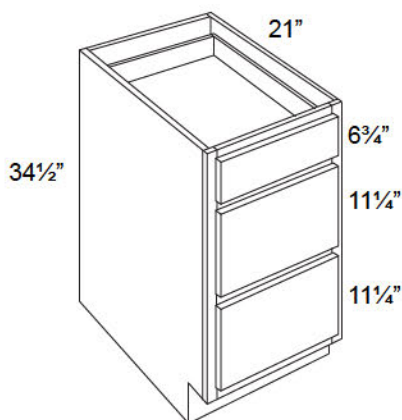

### VANITY DRAWER BASE

ITEM	B	E
VDB12-34	666	784
VDB15-34	701	826

- 2" Clearance between drawer and back panel

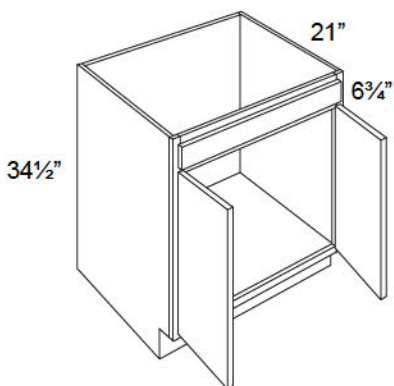

### VANITY SINK BASE

ITEM	B	E
VS24-34	480	565
VS30-34	511	602
VS36-34	540	637



## 34½" High Vanities

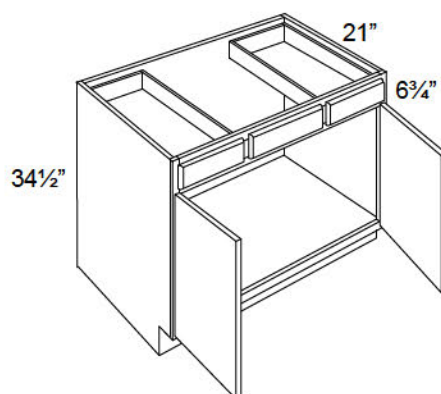

### VANITY SINK BASE COMBO

ITEM	B	E
VSD36-34	668	788
VSD42-34	732	863

- 2" Clearance between drawer and back panel
- 20½" Clearance between the 2 drawers

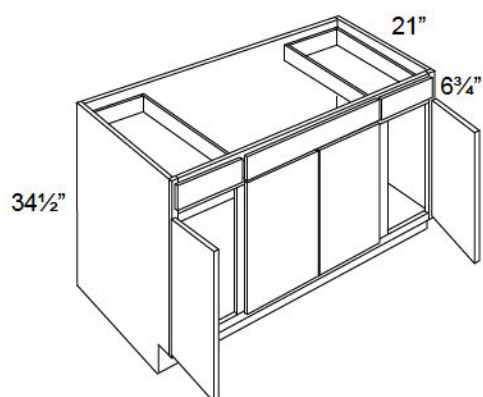

### VANITY SINK BASE COMBO

ITEM	B	E
VSD48-34	772	909

- 2" Clearance between drawer and back panel
- 24" Clearance between the 2 drawers

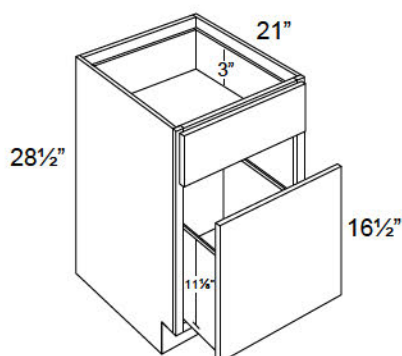

### FILE DRAWER BASE

ITEM	B	E
FD18	617	727

- NOTE: Cabinet height is 28½"
- File rack not included

## Vanity Accessories

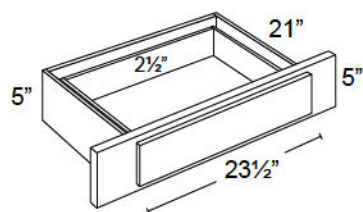

### VANITY KNEE DRAWER

ITEM	B	E
KD30	185	218

- Can be trimmed up to 3" on both sides
- Side mounted ball-bearing slides (not soft close)

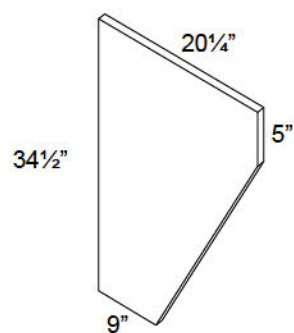

### VANITY DESK LEG

ITEM	B	E
VDL	80	95

- Plywood veneer 3/4" thick
- Wood edge banding

## Trash Cans

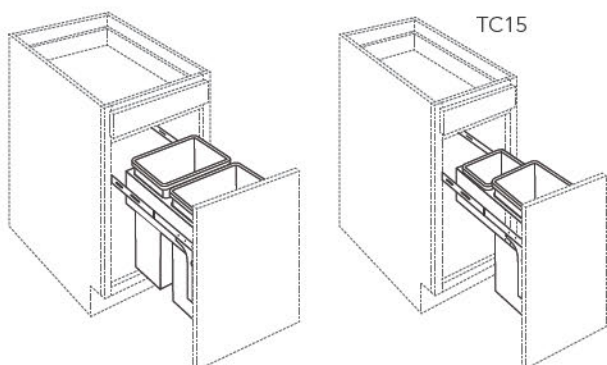

### TRASH CAN

ITEM	B	E
TC15*	441	441
TC18	657	657
TC21	708	708

- Cabinet not included, cabinet must be ordered separately
- Full extension slides (not soft-close)
- 35 qt. Can(s) included - 17¾" high
- Wooden can holder is 3½" high
- Includes installation
- \* One garbage can and one bags bin

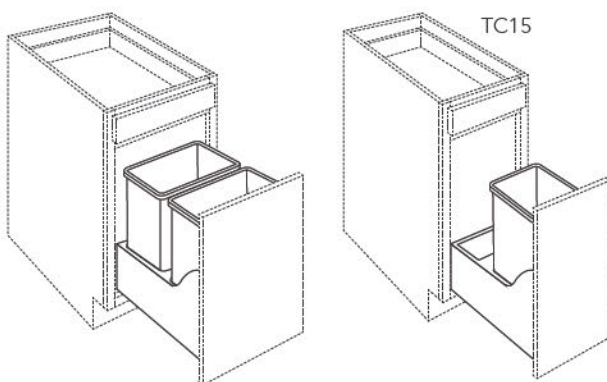

### TRASH CAN (W/ BLUM SLIDES)

ITEM	B	E
TC15 BLUM*	831	831
TC18 BLUM	891	891
TC21 BLUM	982	982
TCV15 BLUM♦	755	755

- Tandem plus Blumotion full extension concealed drawer runners
- Cabinet not included, cabinet must be ordered separately
- 2 - 35 qt. cans included
- Includes installation
- Not for ADA cabinet use
- \* Single 35 qt. can + one bags bin
- ♦ Smaller depth for vanity cabinets

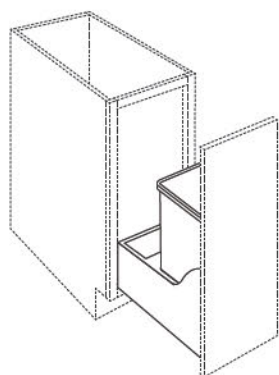

### TRASH CAN FULL HEIGHT DOOR (W/ BLUM SLIDES)

ITEM	B	E
TC15FHD BLUM*	831	831
TC21FHD BLUM	982	982

- Tandem plus Blumotion full extension concealed drawer runners
- Cabinet not included, cabinet must be ordered separately
- 2 - 50 qt. can included
- Includes installation
- Not for ADA cabinet use
- FULL-DOORS modification is required
- \* Single 50 qt. can + one bags bin

## Pull Outs

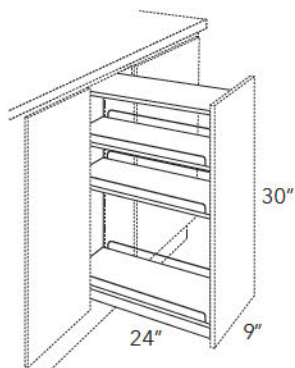

### SPICE PULL OUT BASE 9"

ITEM	B	E
SPO-B9*	580	580
SPO-B9 BLUM	861	861

- Cabinet not included, cabinet must be ordered separately
- Chrome rails
- Adjustable shelves
- UV coated maple wood
- Includes installation
- Not for ADA cabinet use
- \* Full extension ball-bearing slides (not soft-close)

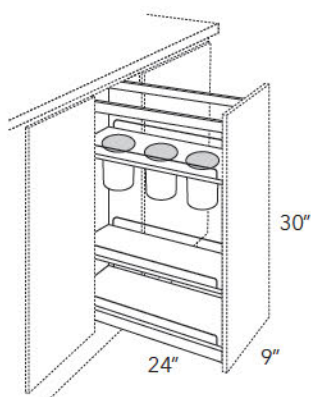

### UTENSIL PULL OUT BASE 9" (W/ BLUM SLIDES)

ITEM	B	E
UPO-B9 BLUM	937	937

- Cabinet not included, cabinet must be ordered separately
- Chrome rails
- Adjustable shelves
- UV coated maple wood
- Includes installation
- Not for ADA cabinet use
- Features Blumotion soft-close drawer slides

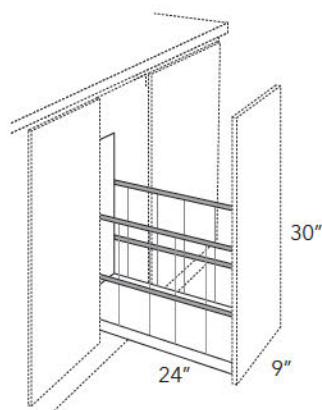

### TRAY DIVIDER PULL OUT BASE 9" (W/ BLUM SLIDES)

ITEM	B	E
TDPO-B9 BLUM	710	710

- Cabinet not included, cabinet must be ordered separately
- UV coated maple wood
- Includes installation
- Not for ADA cabinet use
- Features Blumotion soft-close drawer slides



## Pull outs & Tilt outs

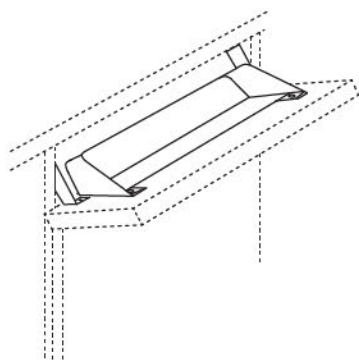
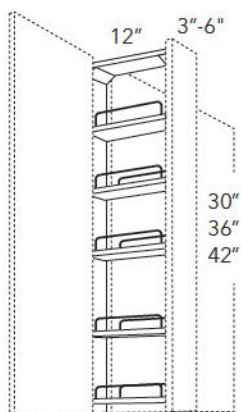
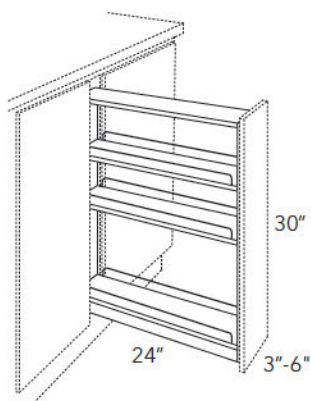

### SPICE PULL OUT BASE FILLER

ITEM	B	E
SPO-BF3*	354	354
SPO-BF6*	403	403
SPO-BF3 BLUM	620	620
SPO-BF6 BLUM	740	740

- Filler & Overlay Filler not included - must be ordered separately
- Chrome rails
- Adjustable shelves
- UV coated maple wood
- Installed on site
- Installed between two cabinets
- Not for ADA cabinet use
- \* Full extension ball-bearing slides (not soft-close)

### SPICE PULL OUT WALL FILLER

ITEM	B	E
SPO-WF330	403	403
SPO-WF336	428	428
SPO-WF342	457	457
SPO-WF630	460	460
SPO-WF636	499	499
SPO-WF642	531	531

- Filler & Overlay Filler not included - must be ordered separately
- Chrome rails
- Full extension ball-bearing slides (not soft-close - BLUM slides not available)
- Adjustable shelves
- UV coated maple wood
- Installed on site
- Installed between two cabinets

### TILT OUT

ITEM	B	E
TILTOUT 11"	161	161
TILTOUT 14"	161	161
TILTOUT 24"	161	161

- White plastic tray
- Includes installation

## Cutlery Organizers

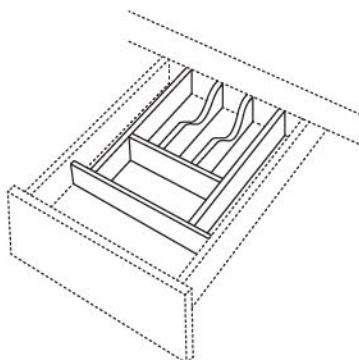

- UV coated maple wood
- $\frac{3}{8}$ " dividers
- $2\frac{1}{2}$ " interior height
- $\frac{3}{8}$ " plywood bottom
- Includes installation

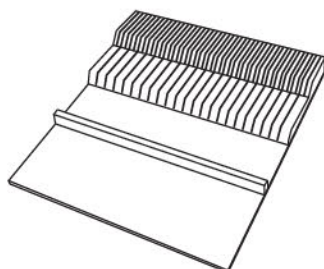
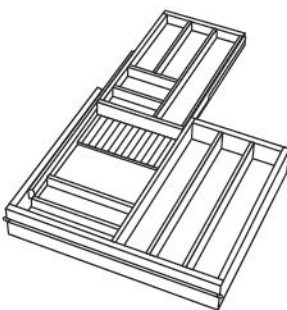
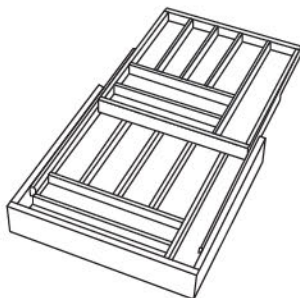

### TRIMMABLE CUTLERY DIVIDER

ITEM	B	E
CD-S	216	216
CD-L	284	284

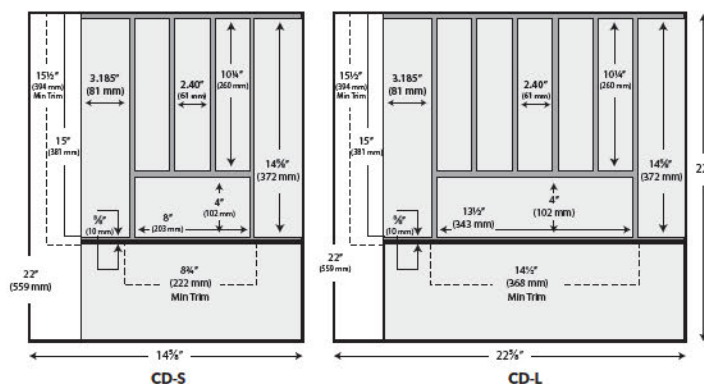

### 2-TIER CUTLERY DRAWER

ITEM	B	E
DCD-15 BLUM	375	375
DCD-18 BLUM	451	451
DCD-21 BLUM	498	498
DCD-24 BLUM	527	527

- UV coated maple wood
- Includes complete  $3\frac{3}{4}$ " high drawer box
- Features Blum soft-close slides

### 2-TIER CUTLERY COMBO DRAWER

ITEM	B	E
DCD-30 BLUM	616	616
DCD-36 BLUM*	710	710

- UV coated maple wood
- Includes complete  $3\frac{3}{4}$ " high drawer box
- Features Blum soft-close slides

\* For DB36 only

### TRIMMABLE KNIFE DIVIDER

ITEM	B	E
DKI-18/24	222	222

- UV coated maple wood
- Total height: 2"
- Includes installation
- $\frac{3}{8}$ " plywood bottom

## Accessories

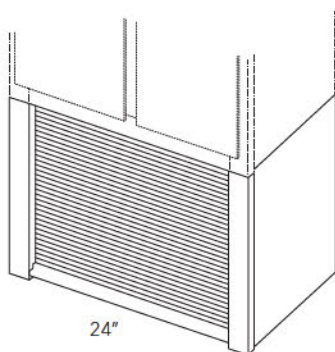
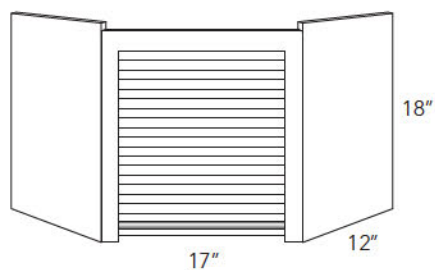
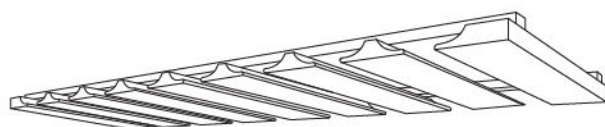
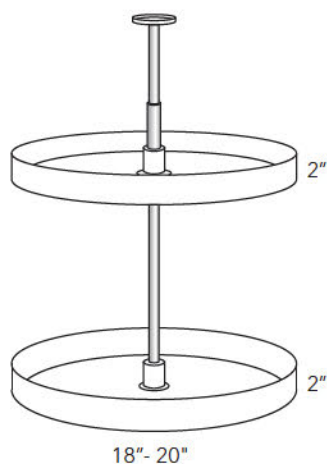

### LAZY SUSAN

	ITEM	B	E
WOOD	LSW24 30	451	451
	LSW24 42♦	708	708
	LSW27 30*	580	580
	LSW27 42*♦	908	908
PLASTIC	LSP24 30	232	232
	LSP24 36/42	361	361

- Adjustable metal post
- 42" lazy susan has 3 trays
- To install inside Diagonal Corner Wall cabinets
- Includes installation
- ♦ 42" poles can be cut to fit 36" high cabinet
- \* 20" trays

### STEMWARE RACK

ITEM	B	E
STEMWARE 30	425	425
STEMWARE 36	450	450

- Comes unfinished. Product finished per order. May have extended ETA.

### CORNER APPLIANCE GARAGE

ITEM	B	E
APPLIANCE GARAGE	805	805

- Comes unfinished. Product finished per order. May have extended ETA.
- Designed to be installed under a diagonal corner wall 24".

### STRAIGHT APPLIANCE GARAGE

ITEM	B	E
APPLIANCE GARAGE 24"	1036	1036

- Comes unfinished. Product finished per order. May have extended ETA.
- Designed to be placed under a 24" wide wall cabinet.

## Accessories

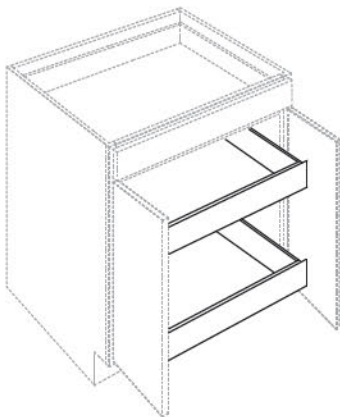
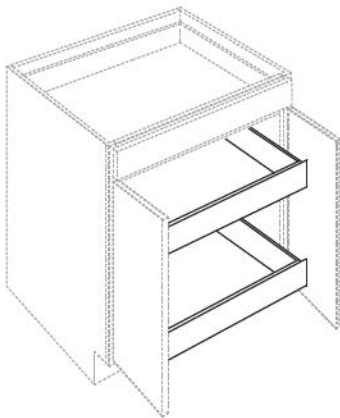

### ROLL OUT

ITEM	B	E
ROD-B15	123	123
ROD-B18	135	135
ROD-B21	141	141
ROD-B24	150	150
ROD-B27	156	156
ROD-B30	162	162
ROD-B33	168	168
ROD-B36	175	175

- Cabinet not included
- Per drawer, sold separately (includes installation)
- Full extension ball-bearing slides
- Drawers are adjustable
- Can be used for pantries

### ROLL OUT (W/ BLUM SLIDES)

ITEM	B	E
ROD-B15 BLUM	248	248
ROD-B18 BLUM	260	260
ROD-B21 BLUM	266	266
ROD-B24 BLUM	275	275
ROD-B27 BLUM	281	281
ROD-B30 BLUM	287	287
ROD-B33 BLUM	293	293
ROD-B36 BLUM	300	300

- Cabinet not included
- Per drawer, sold separately (includes installation)
- Sold assembled, not KD
- Blumotion full extension concealed drawer runners
- Drawers are adjustable
- Can be used for pantries

### TOUCH UP KIT

ITEM	B	E
TOUCH UP KIT	65	65

- Includes stick, marker, & scraper



## Fillers

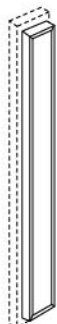
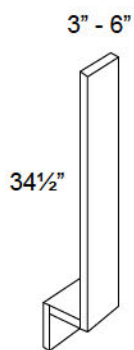
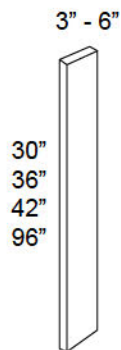

### WALL & TALL

ITEM	B	E
WF330	21	26
WF630	42	50
WF336	30	35
WF636	57	68
WF342	36	42
WF642	68	79
TF396	72	84
TF696	134	158

- 2 sides of filler are finished
- Spice Pullout available on pg. 28

### BASE

ITEM	B	E
BF3	28	33
BF6	53	62

- 2 sides of filler are finished
- Spice Pullout available on pg. 28

### OVERLAY

ITEM	B	E
OLF330	69	73
OLF334	78	83
OLF336	78	83
OLF342	91	97
OLF384	202	216
OLF390	216	229
OLF396	225	240

- Sides of filler are finished
- Actual width: 2 1/2"
- Back filler to be ordered separately

## Fillers

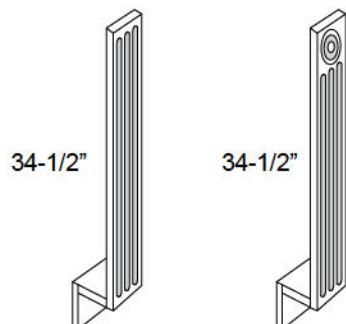
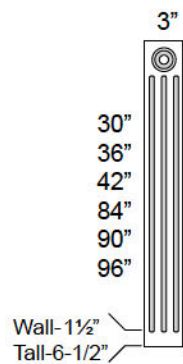
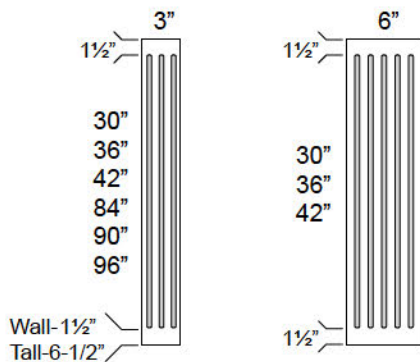

### FLUTED

ITEM	B	E
FF330	83	89
FF336	90	95
FF342	95	101
FF384	155	165
FF390	166	178
FF396	179	191
FF630	154	165
FF636	165	176
FF642	176	187

### FLUTED WITH ROSETTE

ITEM	B	E
FFR330	83	89
FFR336	90	95
FFR342	95	101
FFR384	155	165
FFR390	166	178
FFR396	179	191

### BASE FLUTED

ITEM	B	E
BFF3	95	101
BFFR3	108	114

## Valances

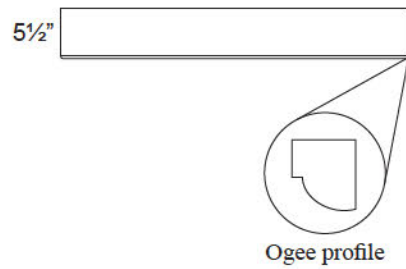

### STRAIGHT

ITEM	B	E
VST96	179	191

- Ogee edge

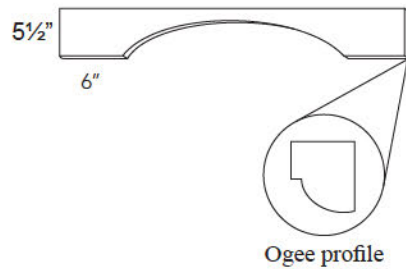

### ARCHED

ITEM	B	E
VAR54	95	101

- Ogee edge

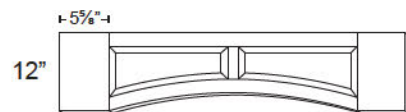

### ARCHED - RAISED PANEL

ITEM	B	E
VARP-42	234	279
VARP-54	249	294

- Can be trimmed up to 3" on each side



### FREEZE

ITEM	B	E
VFZ36/30	187	200
VFZ42/36	205	219
VFZ48/42	223	239

- Can be trimmed up to 3" on each side

## Posts & Pilasters

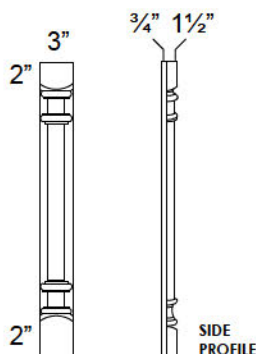
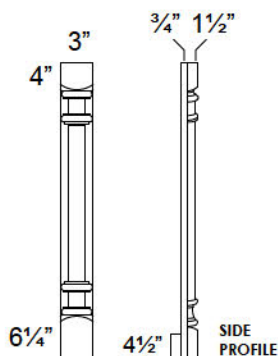
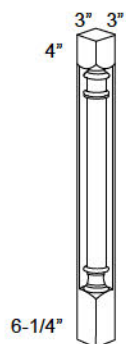
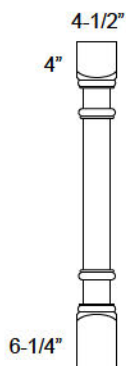

### STANDARD POST

ITEM	B	E
SP36	422	450
SP42	507	540

- Must trim 2" from top or bottom

*Disclaimer: Posts are handmade and may therefore feature inconsistencies in shape or form. These are in no way considered defects.*

### CORNER POST

ITEM	B	E
CP36	304	324

- Must trim 2" from top or bottom

*Disclaimer: Posts are handmade and may therefore feature inconsistencies in shape or form. These are in no way considered defects.*

### PLAIN PILASTER BASE & TALL

ITEM	B	E
PP-BASE*	219	234
PP-TP84	456	486
PP-TP90	459	491
PP-TP96	464	495

- \* Must trim 2" from top or bottom
- Features a toe kick block behind the pilaster

*Disclaimer: Pilasters are handmade and may therefore feature inconsistencies in shape or form. These are in no way considered defects.*

### PLAIN PILASTER WALL

ITEM	B	E
PP-W30	194	207
PP-W36	215	229
PP-W42	236	251

*Disclaimer: Pilasters are handmade and may therefore feature inconsistencies in shape or form. These are in no way considered defects.*



## Moldings (8')

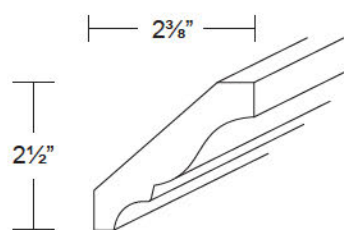

### SMALL CROWN

ITEM	B	E
CM-1	108	126

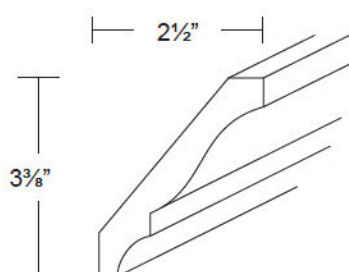

### LARGE CROWN

ITEM	B	E
CM-6	131	155

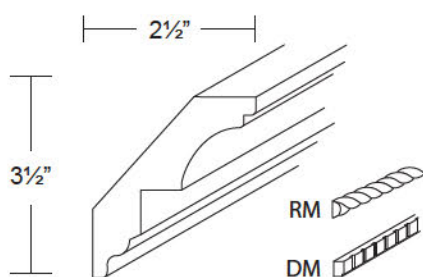

### ROYAL CROWN & INLAY

ITEM	B	E
TCM*	169	179
RM	69	74
DM	69	74

\* Back-mounting cleat included

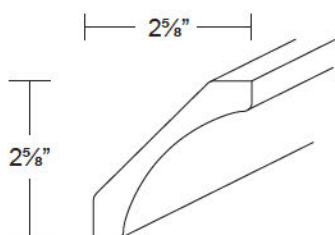
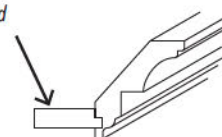

### COVE CROWN

ITEM	B	E
CM-4	116	137

## Moldings (8')

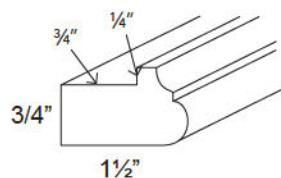

### LIGHT RAIL

ITEM	B	E
LRM	137	152

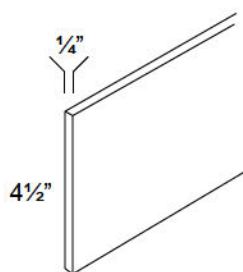

### TOE KICK

ITEM	B	E
TK8	49	58

- 1/4" Veneered plywood

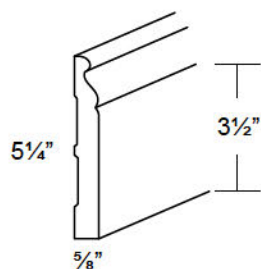

### BASE

ITEM	B	E
BBM	162	190

## Moldings (8')

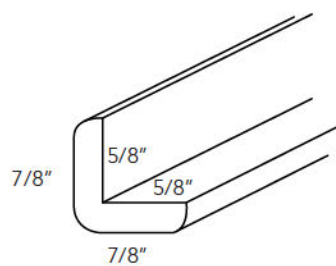

### OUTSIDE CORNER

ITEM	B	E
OCM8	53	62

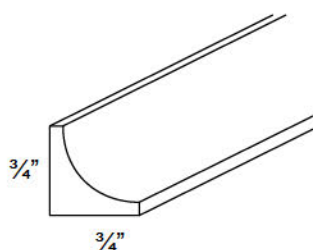

### INSIDE CORNER

ITEM	B	E
ICM8	53	62

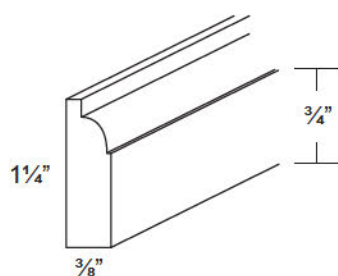

### DECORATIVE SCRIBE

ITEM	B	E
SM8-D	36	42

## Moldings (8')

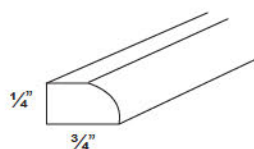

### SIMPLE SCRIBE

ITEM	B	E
SM8-S	36	40

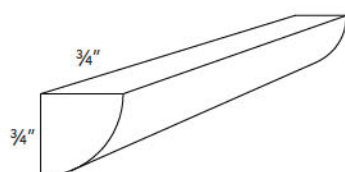

### QUARTER ROUND

ITEM	B	E
QRM	58	65

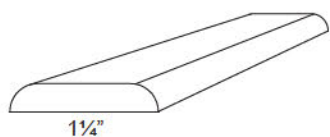
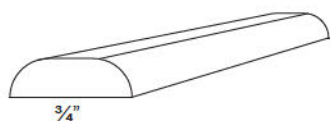

### BATTEN

ITEM	B	E
BM3/4	41	45
BM1 1/4	53	60



## Corbels & Panels

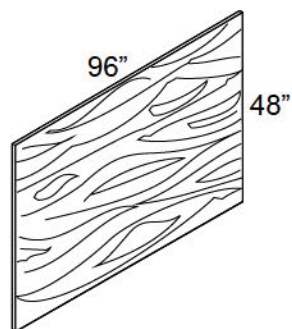
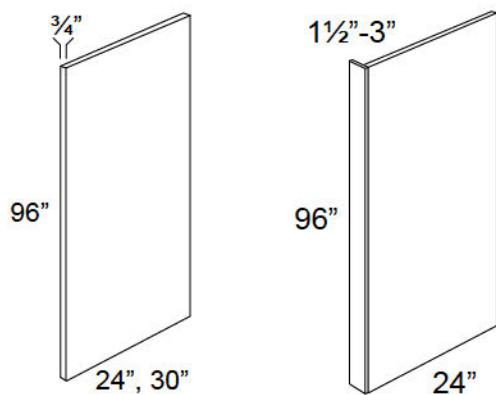
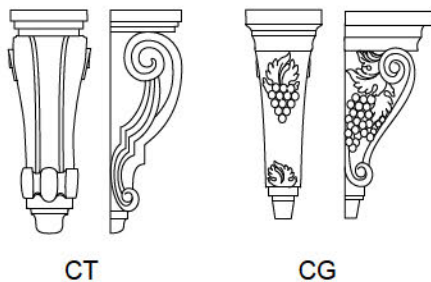

### CORBEL

ITEM	B	E
CTS	156	183
CTL	242	285
CGS	179	210
CGL	269	318

- CT - Traditional Corbel
- CG - Grape Corbel
- Dimensions:  
 CTS: (H6½"xW3¾"xD3½")  
 CTL: (H12½"xW5¼"xD4½")  
 CGS: (H10"xW4⅝"xD5¼")  
 CGL: (H13⅝"xW3½"xD7⅝")

*Disclaimer: Corbels are handmade and may therefore feature inconsistencies in shape or form. These are in no way considered defects.*

### REFRIGERATOR END PANEL

ITEM	B	E
REP2496*	197	231
REP3096*	215	253
REP1-1/2	192	209
REP3	N/A	N/A

- \* Both 96" sides are edge-banded
- To create a REP with a return, see modifications available on pg. X

### PLYWOOD PANEL

ITEM	B	E
PLY-1/4	232	273
PLY-1/2	452	473
PLY-3/4	465	546

## Panels

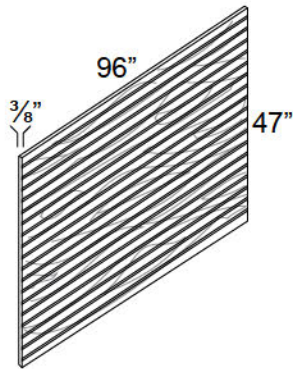

### BEADED PANEL

ITEM	B	E
BP4X8	617	659

- Beaded panel is designed with a 1" interlocking

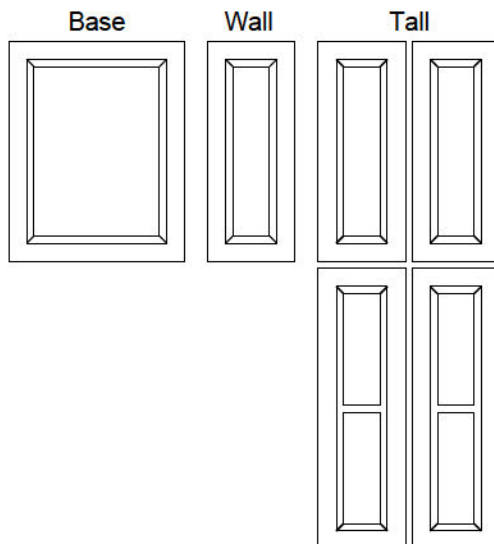

### WAINSCOT PANEL

ITEM	B	E
WP-BASE	209	223
WP-W30	111	118
WP-W36	138	147
WP-W42	165	177
WP-T84	500	534
WP-T90	550	586
WP-T96	615	656

- Same profile as cabinet door
- Base: 23½"W x 29½"H
- Wall: 11½"W x 29½" / 35½" / 41½"H
- 4 pc. Tall: 11¾"W/each door. Height is same as pantry  
Can be used for 12" deep pantry

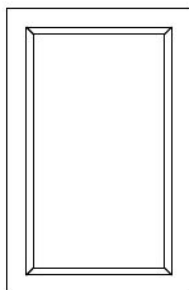

### DECORATIVE DOOR

ITEM	B	E
DD W0930 DOOR	65	79
DD W1230 DOOR	76	90
DD W1530 DOOR	96	113
DD W1830 DOOR	116	136
DD W2130 DOOR	135	159

- Size of door is same as door on cabinet
- May have extended ETA
- Comes pre-drilled for hinges

## Panels

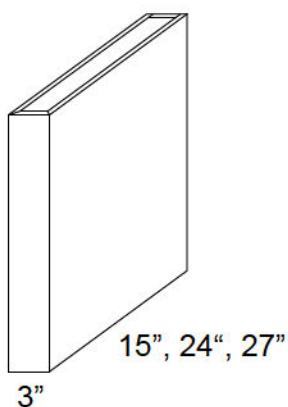
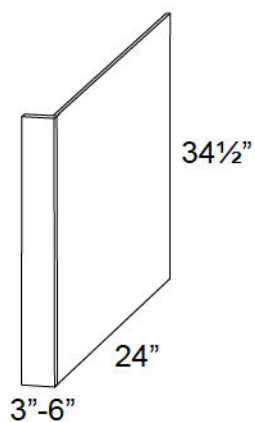

### DISHWASHER END PANEL

ITEM	B	E
DWR3	119	119
DWR6	179	210

- For custom size return, see modifications available on pg. X

### COLUMNS

ITEM	B	E
CLM-BASE	262	280
CLM-30	111	118
CLM-36	129	137
CLM-42	151	160
CLM-96	687	732

- Base: 24" deep
- Tall: 27" deep
- Wall: 15" deep
- To cut column see modifications available on pg. X
- Any size custom column can be created for additional charge

# Order Form

## DOOR STYLE:

### WELLINGTON

- ☐ IVORY  
☐ CINNAMON

## ORDER TYPE:

- ☐ DELIVERY      ☐ ASSEMBLED  
☐ PICK UP      ☐ KNOCK DOWN

## ACCOUNT INFO:

COMPANY NAME:

CONTACT:

PURCHASE ORDER #:

DATE:

REQUESTED SHIP DATE:

PHONE:

FAX:

E-MAIL:

SHIP TO:

SPECIAL INSTRUCTIONS:

☐ I WOULD LIKE THIS ORDER TO BE READY LATER THAN THE  
REGULAR ESD: \_\_\_\_\_ (DATE)

ORDERS THAT HAVE NOT BEEN ACCEPTED AFTER 4 WEEKS WILL BE STORED  
AT DEALERS EXPENSE.

If more than 35% of cabinet sides on the order are selected as  
exposed, a \$25 fee will be applied to each exposed side from the  
6th cabinet onward (fee does not apply to the first five cabinets)

	QTY	ITEM CODE	PRICE	HINGE		FINISH	
				L	R	L	R
1							
2							
3							
4							
5							
6							
7							
8							
9							
10							
11							
12							
13							
14							
15							
16							
17							
18							
19							
20							
21							
22							
23							
24							
25							
26							
27							
28							
29							
30							
31							
32							
33							
34							
35							
36							

TOTAL PIECE COUNT

TOTAL LIST

\$

MULTIPLIER

%

TOTAL COST

\$



[illegible]