

Value

Specifications Guide / Valid thru May 2022

Please Note: Items are subject to change without prior notice. This spec book is missing some updated information, so to stay up to date with product specifications and modification options please use our new digital spec book which can be found at <https://ezpricing.fabuwood.com/specbook>

Construction Specifications

Doors and Drawer Fronts:

Doors and drawer fronts are made of solid wood rails with a MDF center panel to reduce the possibility of shrinkage.

The 5 piece Hallmark modified full overlay door has a 1/2" thick MDF center panel captured in a 3/4" x 2 1/4" mortise and tenon solid wood frame and is complimented with a 5 piece recessed panel drawer front. The overlay on top of all wall cabinets has been modified to accept a crown moulding.

Hinges:

Compact Blumotion soft close hinges (Blum model #39C355B.20).

Drawers:

5/8" thick solid wood dovetail drawer box with a 3/8" plywood bottom attached to Tandem plus Blumotion concealed drawer runners (Blum model #563H)

Shelving:

15mm (5/8") thick select veneered wood with matching wood edge-banding is used on all wall and base cabinetry where applicable. The adjustable shelves are supported by plastic self locking shelf clip.

Backs, Tops and Bottoms:

1/2" thick veneered plywood with natural finished interiors. The backs are stapled and screwed into place for additional support.

Face Frame:

3/4" x 1 1/2" solid wood stiles and rails jointed with glue and dowels. Back of face frames are grooved to accept side panels. The Hallmark face frame is engineered so that the bottom of all base and wall cabinets are flushed with the top inside edge of the face frame creating a custom look.

Toe Kick:

3/4" x 4 1/2" select unfinished plywood toe kick is added to each assembled cabinet. Additional 1/4" 8-foot lengths of toe kicks are available in matching colors to our cabinetry.

Panel Beams:

A panel beam is fastened into a dovetail groove at the top of each base cabinet to ensure a straight fully integrated side, and for use of support and mounting of a countertop.

Construction Specifications

- 1 Solid wood door and drawer front stiles and rails are constructed with mortise and tenon joints.
- 2 Compact Blumotion soft-close mechanism integrated in concealed six-way adjustable hinges. Hinges open at 110°
- 3 5/8" solid wood dovetail drawer with a 3/8" plywood bottom features Tandem plus Blumotion full-extension concealed drawer runners
- 4 2 1/2" interior drawer height.
- 5 3/4" x 1 1/2" solid wood face frame.
- 6 1/2" select veneered plywood back with a natural finished interior.
- 7 1/2" select unfinished plywood side panels grooved into face frame.
- 8 15mm (5/8") select veneered plywood adjustable shelving with matching wood veneer edge banding.
- 9 3/4" x 4 1/2" unfinished plywood toe kick attached to cabinet. Matching 1/4" toe kick cover to be ordered separately.
- 10 2 1/2" x 1/2" plywood panel beams dovetailed into the side panels for strength and stability.
- 11 Base cabinet has 11 7/8" deep shelf.
- 12 Base has a full overlay door.
- 13 When placing an order, need to select exposed sides; Right, Left or Both.
A 1/4" select medium-density fiberboard panel will be applied to the selected side(s), and the side will be near flush finished.
- 14 Wall cabinet has a modified overlay door. Crown can be mounted on the face frame.

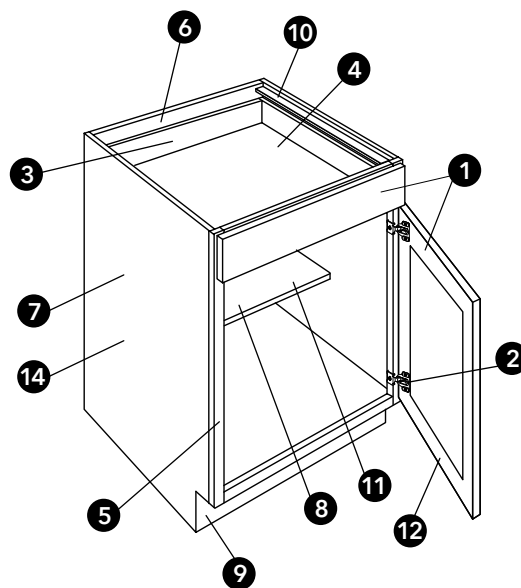
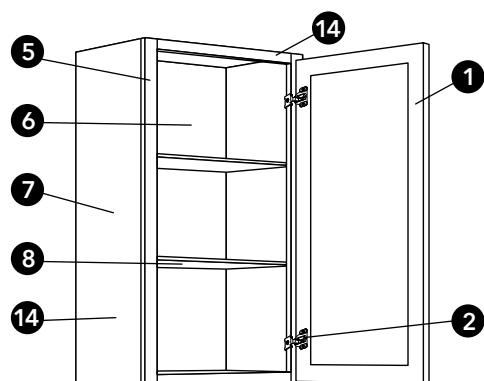

Featuring
blum®

5 Year Limited Warranty

COVERAGE OF WARRANTY

Fabuwood Cabinetry Corp ("Fabuwood") is pleased to provide the following limited warranty on all cabinets imported to and assembled and sold in the United States by Fabuwood. This warranty does not cover cabinets sold or shipped outside of the United States. This limited warranty is subject to all limitations, exclusions, disclaimers and procedures set forth herein. Fabuwood warrants to the original purchasing consumer that all cabinets purchased from Fabuwood will be free from all unnatural defects in material and workmanship in accordance with the Fabuwood quality standards sheet under normal residential use for 5 years from the date of the original purchase or as long as the original purchasing consumer owns the home in which such cabinets are installed, whichever is less. This warranty is non transferable to subsequent owners of the home.

EXCLUSIONS

THIS WARRANTY SUPERSEDES ANY AND ALL PREVIOUS WARRANTIES BY FABUWOOD AND CONSTITUTES THE EXCLUSIVE REMEDY AGAINST FABUWOOD FOR ALL DEFECTS, DAMAGES AND WORKMANSHIP. THERE ARE NO IMPLIED WARRANTIES EXTENDING BEYOND THE TERMS OF THIS WARRANTY. FABUWOOD SHALL NOT BE LIABLE FOR ANY INDIRECT, SPECIAL, PUNITIVE, INCIDENTAL OR CONSEQUENTIAL COSTS, EXPENSES OR DAMAGES. THIS WARRANTY GIVES YOU SPECIFIC LEGAL RIGHTS, AND YOU MAY ALSO HAVE OTHER RIGHTS, WHICH VARY FROM STATE TO STATE. IT IS POSSIBLE THAT ONE OR MORE OF THE LIMITATIONS AND EXCLUSIONS IN THIS WARRANTY MAY NOT APPLY TO YOU. THIS WARRANTY APPLIES ONLY TO FABUWOOD PRODUCTS PURCHASED ON OR AFTER MARCH 15, 2014

LIMITATIONS

This warranty shall become void if the cabinets, cabinetwork, drawer slides or hinges are modified from its original form, improperly installed or damaged prior to or during the installation, or used in any way other than for residential purposes. This warranty covers only parts and materials of the cabinets as supplied by Fabuwood. This warranty does not cover any products used or installed in connection with cabinets, such as gas or electric appliances, countertops, or plumbing fixtures. This warranty does not apply to products installed in locations that do not maintain year-round environmental controls. This warranty shall not apply to damages caused by transportation, storage, dirt, chemicals, exposure to moisture, humidity or excessive heat or cold, nor does it cover defects arising from normal wear and tear, misuse, neglect, accidents, alterations, improper use or failure to maintain properly, house settling, or acts of God. No installer, retailer, distributor, agent or employee of Fabuwood has the authority to alter the obligations or limitations in this warranty.

QUALITY STANDARDS

This warranty covers all damages and unnatural defects that are deemed as such under the current Fabuwood Quality Standards sheet. The current Fabuwood Quality Standards sheet is available for download in the dealer login section of the Fabuwood website (www.fabuwood.com), which should be reviewed at each time a claim for warranty service is being considered. Fabuwood reserves the right to modify or change the Fabuwood Quality Standards sheet at any time without notice.

DISCLAIMERS

The following is a brief recap of some of the characteristics of the wood and finishes on the cabinets you are about to purchase. Please read them carefully. If some of these characteristics concern you, please choose something else. We bring these characteristics to your attention so you will realize that Fabuwood will not be held responsible for these variations in your cabinetry. It is important

to note that wood products claimed as defective are most often the result of atmospheric conditions such as excess moisture and humidity. Fabuwood strongly recommends testing the intended location of the products for such conditions prior to installation.

WOOD AND COLOR VARIATIONS: Wood is a product of nature, and since no two trees are alike, cabinets may vary in color, texture and grain. Wood characteristics naturally occurring such as variations in color, grain, mineral streaks, pinholes and knots are not considered defects. Color variations in cabinets are also a natural occurrence due to species, age, character of cabinets, and exposure to UV light and sunlight. For these reasons, new and/or replacement cabinets may not match display samples and/or existing cabinets. This may result in overall color variations, but is not considered a defect.

WOOD DOORS: Wood by nature will undergo expansion and contraction movements year after year as it compensates and adjusts to ever changing atmospheric humidity and temperature conditions. It is very common for center panels on doors to shrink, expand or move during these transitions. Typically, the panel will return to its normal position within a year once it has adjusted to seasonal changes. It is for these same reasons that it is very common for doors to warp during these periods. Doors that are warped up to 1/4" are not considered defective. Note: It is advisable to check if the door was properly installed, since doors that appear warped are very often the result of improper installation.

PAINTED FINISHES: Plywood is a non-porous, smooth grained wood. Additionally, wood by nature undergoes periods of expansion and contraction while it adjusts to atmospheric conditions mentioned above. As such, finish stress lines may become visible on painted cabinets especially at the joints. Any such occurrence is not considered a defect.

GLAZED FINISHES: A glazed finish by character is an uneven finish. Some edges and profiles will have heavier hang up than others and glazing may vary cabinet to cabinet, door to drawer and item to item. This may result in overall color variations but is not considered a defect.

WARRANTY PERFORMANCE

If a defect does occur within the terms and conditions of this warranty such defective part will be repaired or replaced by Fabuwood at its sole discretion. Fabuwood will not provide or pay for the cost of removal of defective product, transportation of defective, repaired or replaced product or installation of repaired or replaced product. Fabuwood will not be responsible for any shipping damages to the defective, replaced or repaired product. If defective item has been discontinued or is not available at the time, Fabuwood reserves the right to replace the item with the most similar item available in Fabuwood's inventory at that time. Fabuwood cannot guarantee that the finish of any replacement will exactly match the finish and appearance of the defective item due to the natural ageing process of the wood and finishes of the cabinets. Fabuwood may require at its discretion that the customer submit a clear photo, or that a company representative view the item being claimed before honoring this warranty.

CLAIMS

To submit a claim covered under this warranty, the original proof of purchase and full payment or copies thereof must be provided. Please email all documents to customerservice@fabuwood.com. Your dealer will contact you once your claim has been reviewed.

NOTE

Please do not send back any items to Fabuwood prior to receiving proper authorization from customer service. Fabuwood takes no responsibility on any items sent back to Fabuwood without proper return authorization.

Door Style

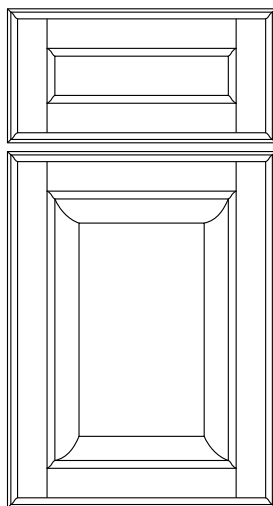

HALLMARK

COLOR	FINISH	PRICE COLUMN
Frost	Paint	N

- Full overlay door with modified overlay on wall cabinets.
- Stiles and rails are solid wood ¾" thick and 2¼" wide.
- Constructed with mortise and tenon joints.
- ½" thick MDF raised center panel.
- 5-piece recessed panel drawer front matches door design.
- Compact Blumotion Soft Close Hinges (Blum Model #39C355B.20)
- Tandem Plus Blumotion Concealed Drawer Runners (Blum Model #563H)

Sales Tools

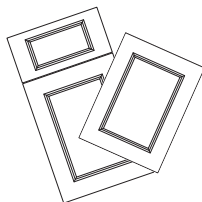
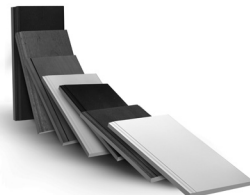
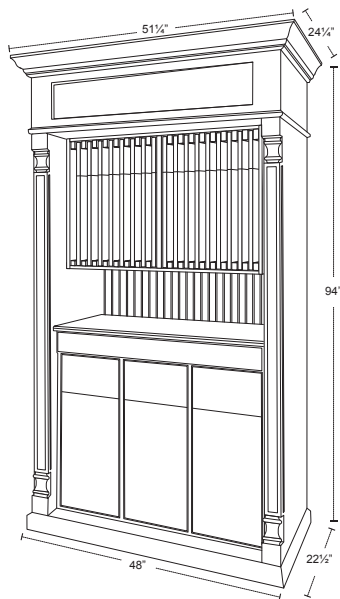
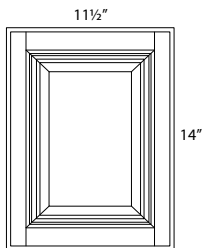
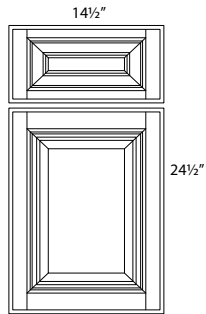

DOOR SAMPLES WITH DRAWER FRONT

ITEM	DESCRIPTION	NET PRICE
SDHF	HALLMARK FROST	30

SMALL DOOR SAMPLES

ITEM	DESCRIPTION	NET PRICE
SDHF-2	HALLMARK FROST	23

SELLING CENTER

ITEM	DESCRIPTION	NET PRICE
DEALER SELLING CENTER	FABUWOOD SELLING CENTER	1700

COLOR BLOCKS

ITEM	DESCRIPTION	NET PRICE
COLOR BLOCK	BOX OF COLOR BLOCKS	35

SAMPLE PACKAGES

ITEM	DESCRIPTION	NET PRICE
SMALL SAMPLE PACKAGE	SMALL SAMPLE PACKAGE	570
DEALER PACKAGE	LITERATURE AND ACCESSORIES	795

Modifications

CUT ITEMS

ITEM	DESCRIPTION	LIST
CUT-BASE	Reduce depth of base cabinet (min. depth 12")	370
CUT-DBASE	Reduce depth of drawer base cabinet (min. depth 12")	510
CUT-SBASE	Reduce depth of sink base cabinet (no min.)	245
CUT-WALL	Reduce depth of wall cabinet (no min.)	310
CUT-TALL	Reduce depth of tall cabinet (no min.)	710
CUT-DOOR	Cut out center panel of door for glass insert (per door, glass not included)	210
CUT-COLUMN	Reduce depth of column (specify depth)	265
CUT-BASE HEIGHT	Reduce height of base cabinet by cutting off top drawer (total base height: 28½")	310
CUT-TK	Reduce toe kick height (no min.)	120
CUT-PANEL	Cut down a panel to any size	83/pc.
CUT-ROD	Reduce depth of rollout drawer (specify depth of cabinet)	125

PIPE CHASE

ITEM	DESCRIPTION	LIST
CHASE-BASE	Make chase in base cabinet	605
CHASE-DBASE	Make chase in drawer base cabinet	875
CHASE-WALL	Make chase in wall cabinet	325
CHASE-TALL	Make chase in tall cabinet	910
CHASE-CORNER	Make chase in corner cabinet (WDC, WPC & ERB only)	1205

Must supply a drawing for all chase modifications.

CUSTOMIZATIONS

ITEM	DESCRIPTION	LIST
CREATE-ERB	Remove tray, install bottom panel on top, to create easy reach	
CREATE-RETURN WALL*	Create a return wall filler up to 6"W x 15"D x 42"H (materials incl.)	470
CREATE-RETURN TALL*	Create a return tall filler up to 6"W x 30"D x 96"H (materials incl.)	865
CREATE-COLUMN BASE*	Create a 3" column up to 30"D by 34½"H	805
CREATE-COLUMN TALL*	Create an oversized column	1455
CREATE-COLUMN WALL*	Create a 3" column up to 15"D x 42"H	605
HAMPER	Install door mounted pull out wood hamper in cabinet (cabinet not incl.)	710
CUSTOM DOOR	Order any custom size door	Quote*

* Email orders@fabuwood.com for quote

MODIFICATIONS

ITEM	DESCRIPTION	LIST
REMOVE-DRAWER	Remove cabinet drawer to create false drawer front	63
CLOSE-BLIND	Close open section of a blind wall or base cabinet	103
ATTACH-TK	Attach toe kick on wall cabinet	120
RECESS-TK	Recess toe kick of base cabinet (must supply a drawing)	210

Modifications

MODIFICATIONS CONT.

ITEM	DESCRIPTION	LIST
EDGE-BAND	Additional edge banding (price per linear foot)	10
PEN-CABINET	Create a peninsula cabinet from 2 cabinets (cabinets not incl.)	415
INCREASE-BASE	Increase depth on base cabinet	110
INCREASE-WALL	Increase depth on wall cabinet	110
INCREASE-TALL	Increase depth on tall cabinet	110
MATCH-INTERIOR	Stain interior of cabinet to match exterior	67
CREATE- SQ BOTTOM	Square bottom shelf for wall open end to enable light rail molding	103
FLUSH-WALL BOTTOM	Flush the bottom of a wall cabinet	310
FLUSH-TOE KICK	Flush toe kick of base cabinet to face frame (sides not finished)	185
FULL-DOORS	Create full height door base cabinet from 2 cabinets (cabinets not incl.)	125
OE6	Cut OE12 to 6"	0

* Email orders@fabuwood.com for quote

UPGRADES

ITEM	DESCRIPTION	LIST
INSTALL-ACCES	Install any accessory in a cabinet (accessories not incl.)	Quote*
GLAZE	Custom glazes available for a charge	20%
CUSTOM COLOR PAINT	Refinish to custom color paint	Quote*

* Email orders@fabuwood.com for quote

LOOSE PARTS

ITEM	DESCRIPTION	LIST
SHELF BASE	Loose 24" deep shelf (specify cabinet size)	
SHELF WALL	Loose 12" deep shelf (specify cabinet size)	
SHELF TALL	Loose 24" deep shelf (specify cabinet size)	
SHELF-DSB	Loose shelf (specify cabinet size)	315
SK BASE	Skin for base cabinet with adhesion	83
SK MC	Skin for microwave wall cabinet with adhesion	66
SK TALL	Skin for tall cabinet with adhesion	220
SK W30	Skin for 30" high wall cabinet with adhesion	66
SK W36	Skin for 36" high wall cabinet with adhesion	66
SK W42	Skin for 42" high wall cabinet with adhesion	66

Many more modifications available- please contact your customer service rep.

12"-18" High Wall Cabinets

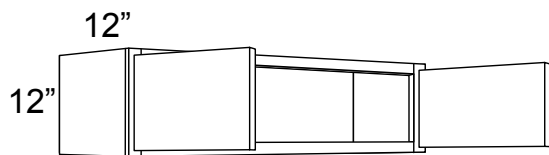

12" HIGH

ITEM	N
W3012	310
W3612	340

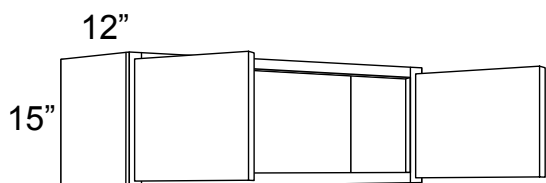

15" HIGH

ITEM	N
W2115*	275
W2415	295
W3015	300
W3315	340
W3615	355

* One door only

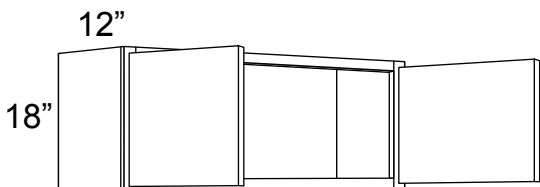

18" HIGH

ITEM	N
W2118*	315
W2418	325
W3018	325
W3318	370
W3618	385

* One door only

15"- 24" High & 24" Deep Wall Cabinets

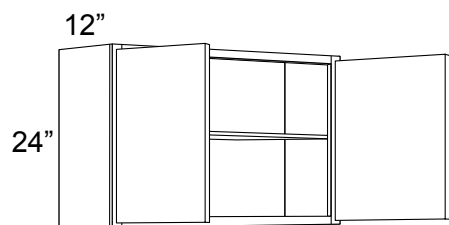

24" HIGH

ITEM	N
W2424	365
W3024	400
W3324	435
W3624	475

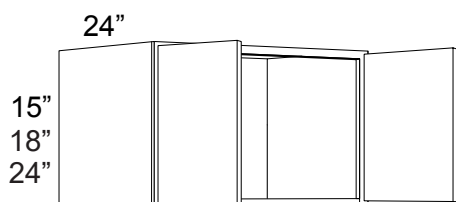

24" DEEP

ITEM	N
W301524	395
W331524	645
W361524	510
W301824	465
W331824	755
W361824	560
W302424*	505
W332424*	690
W362424*	590

* Has 1 shelf

30" High Wall Cabinets

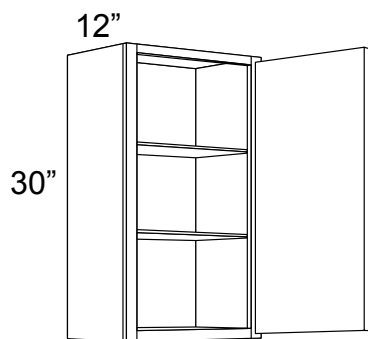

30" HIGH

ITEM	N
W0930	245
W1230	255
W1530	295
W1830	325
W2130	365

- Peninsula cabinet modification pg. VIII

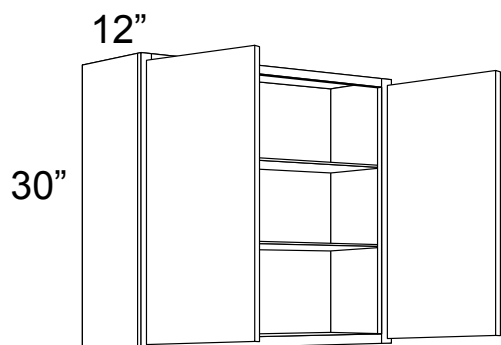

30" HIGH

ITEM	N
W2430	390
W2730	445
W3030	455
W3330	495
W3630	510

- Peninsula cabinet modification pg. VIII

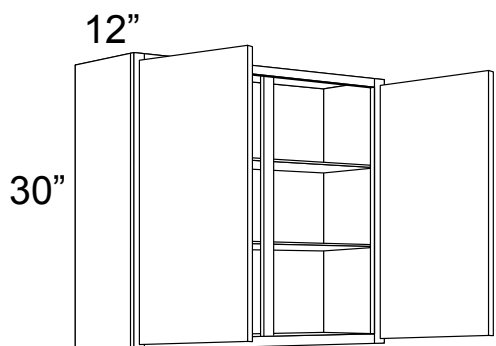

30" HIGH

ITEM	N
W3930	555
W4230	630

- 1½" center stile
- Peninsula cabinet modification pg. VIII

30" High Wall Cabinets

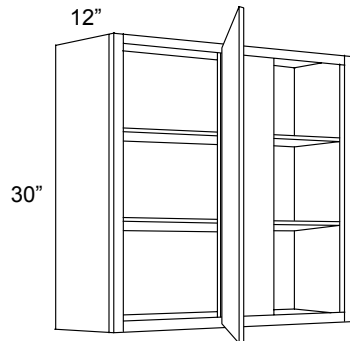

30" SINGLE DOOR BLIND

ITEM	N
WBC2430	450
WBC3030	525
WBC3630	625

- Must use filler on adjacent side (not supplied)
- Measurements are rounded off to closest 1/8"

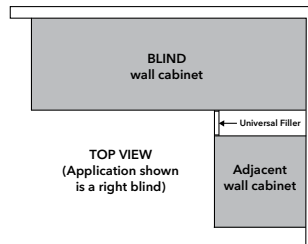

	Act.	Max	Door	Stile	Open (door side)
WBC2430	24"	27"	10 3/8"	6"	7 3/4"
WBC3030	30"	33"	16 3/8"	6"	13 3/4"
WBC3630	36"	39"	22 3/8"	6"	19 3/4"

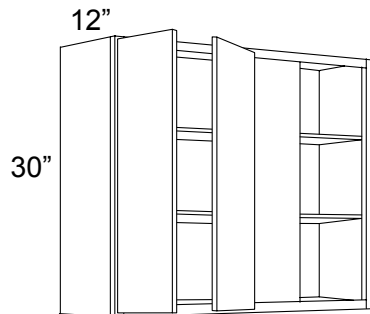

30" DOUBLE DOOR BLIND

ITEM	N
WBC4230	725

- Must use filler on adjacent side (not supplied)
- Measurements are rounded off to closest 1/8"

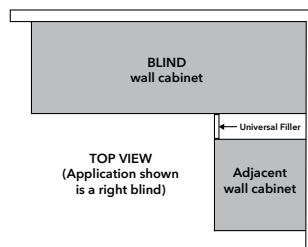

	Act.	Max	Door	Stile	Open (door side)
WBC4230	42"	45"	14 1/8"	6"	25 1/8"

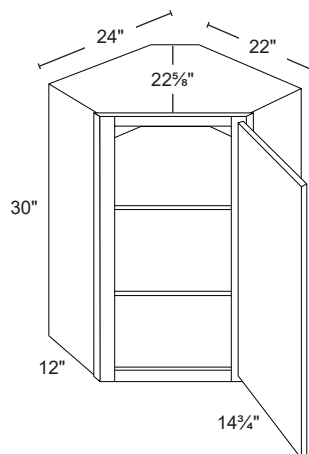

30" DIAGONAL CORNER

ITEM	N
WDC2430	580

- Uses 3/8" overlay hinge
- For Lazy Susan see accessories on pg. 22

30" High Wall Cabinets

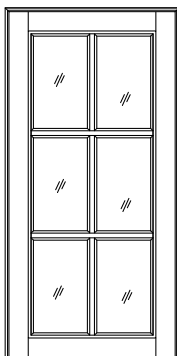

30" GLASS DOOR

ITEM	N
GD1230	140
GD1530	160
GD1830	185
GD2430♦	155
GDD2430*	165
GD3030♦	165
GD3630♦	195

* 14¾" wide for WDC2430 only

♦ Cost is for a single door - must order quantity of 2 doors per cabinet

• Glass doors are pre-installed with clear glass only

36" High Wall Cabinets

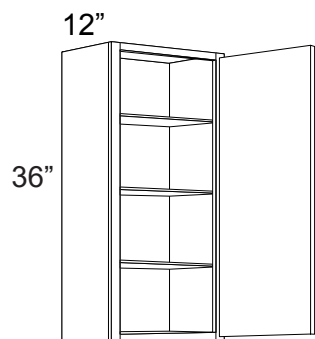

36" HIGH

ITEM	N
W0936	260
W1236	300
W1536	345
W1836	390
W2136	435

- Peninsula cabinet modification pg. VIII

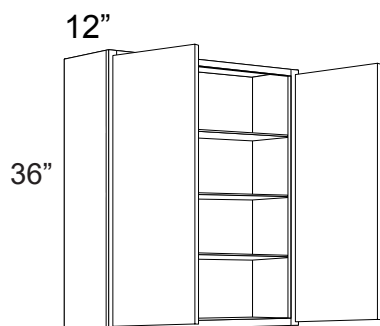

36" HIGH

ITEM	N
W2436	495
W2736	535
W3036	560
W3336	605
W3636	650

- Peninsula cabinet modification pg. VIII

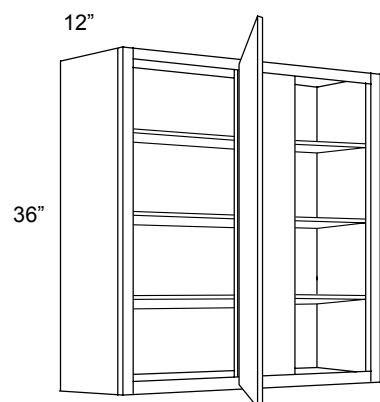

36" SINGLE DOOR BLIND

ITEM	N
WBC2436	600
WBC3636	690

- Must use filler on adjacent side (not supplied)
- Measurements are rounded off to closest 1/8"

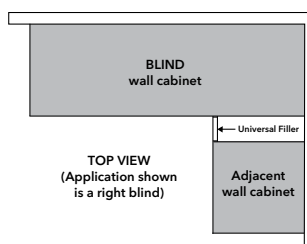

	Act.	Max	Door	Stile	Open (door side)
WBC2436	24"	27"	10 7/8"	6"	7 3/4"
WBC3636	36"	39"	22 3/8"	6"	19 3/4"

36" High Wall Cabinets

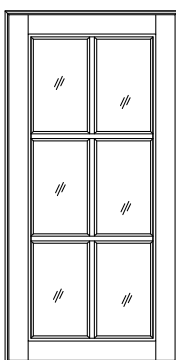
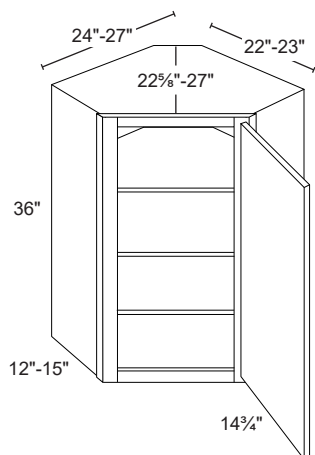

36" DIAGONAL CORNER

ITEM	N
WDC2436	710
WDC2736	825

- Uses 3/8" overlay hinge
- Lazy Susan pg. 25

36" GLASS DOOR

ITEM	N
GD1236	170
GD1536	185
GD1836	220
GD2436♦	185
GDD2436*	210
GD3036♦	210
GD3636♦	230

* 14 3/4" wide for WDC2436 & WDC2736

- ♦ Cost is for a single door - must order quantity of 2 doors per cabinet
- Glass doors are pre-installed with clear glass only

42" High Wall Cabinets

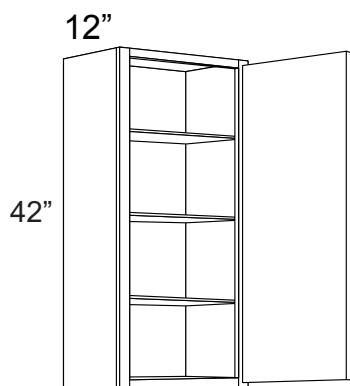

42" HIGH

ITEM	N
W0942	275
W1242	335
W1542	370
W1842	430
W2142	465

- Peninsula cabinet modification pg. VIII

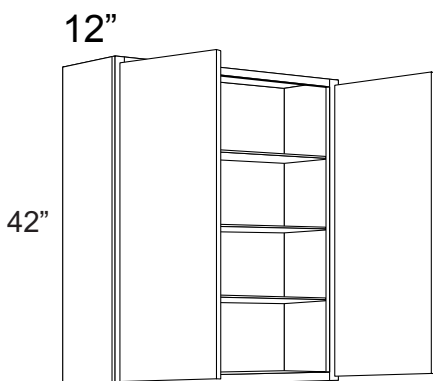

42" HIGH

ITEM	N
W2442	570
W2742	595
W3042	625
W3342	685
W3642	745

- Peninsula cabinet modification pg. VIII

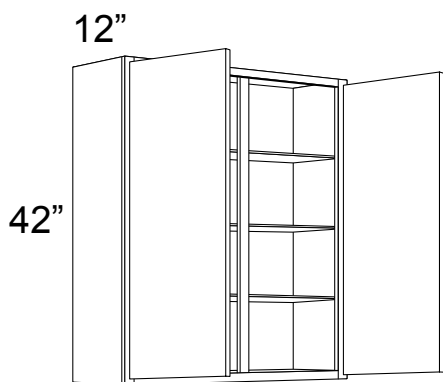

42" HIGH

ITEM	N
W3942	865

- 1½" center stile
- Peninsula cabinet modification pg. VIII

42" High Wall Cabinets

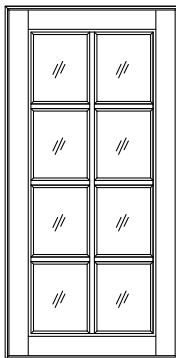
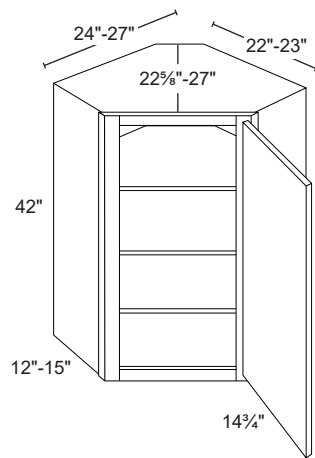
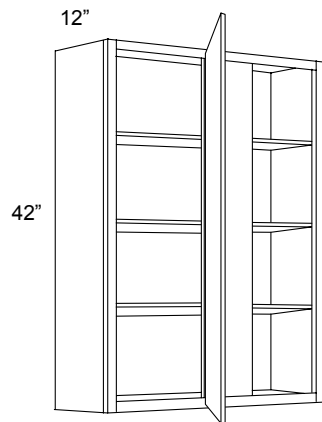

42" SINGLE DOOR BLIND

ITEM	N
WBC2442	700
WBC3642	735

- Must use filler on adjacent side (not supplied)
- Measurements are rounded off to closest 1/8"

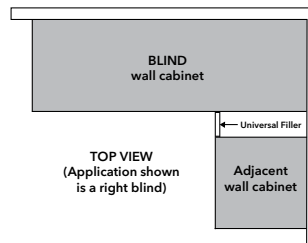

	Act.	Max	Door	Stile	Open (door side)
WBC2442	24"	27"	10 5/8"	6"	7 3/4"
WBC3642	36"	39"	22 3/8"	6"	19 3/4"

42" DIAGONAL CORNER

ITEM	N
WDC2442	800
WDC2742	950

- Uses 3/8" overlay hinge
- Lazy Susan pg. 25

42" GLASS DOOR

ITEM	N
GD1242	215
GD1542	230
GD1842	250
GD2442♦	220
GDD2442*	225
GD3042♦	225
GD3642♦	255

- * 14 3/4" wide for WDC2442 & WDC2742
- ♦ Cost is for a single door - must order quantity of 2 doors per cabinet
- Glass doors are pre-installed with clear glass only

Specialty Wall Cabinets

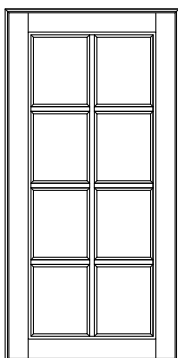

DOOR PREPPED FOR GLASS

ITEM	N
DFG1230	115
DFG1236	140
DFG1242	175
DFG1530	130
DFG1536	155
DFG1542	195
DFG1830	155
DFG1836	180
DFG1842	210
DFG2430*	125
DFG2436*	155
DFG2442*	180
DFG3030*	135
DFG3036*	170
DFG3042*	185
DFG3630*	160
DFG3636*	195
DFG3642*	215

- Glass not included
 - Comes with the center panel removed; vinyl gasket is included for easy installation of glass in the field.
- * Cost is for a single door, need to order quantity of 2 doors per cabinet

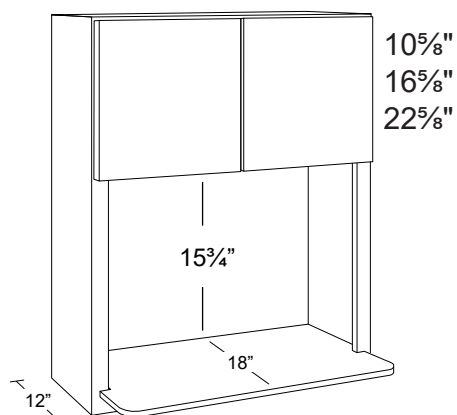

MICROWAVE

ITEM	N
MW3030	695
MW3036	715
MW3042	725

Specialty Wall Cabinets

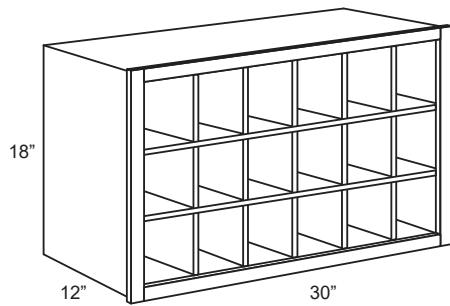

NOTE: DESIGN CHANGE

WINE RACK

ITEM	N
WR3018	765

- Finished interior
- 1-½" Framed cabinet construction
- Fits 18 bottles

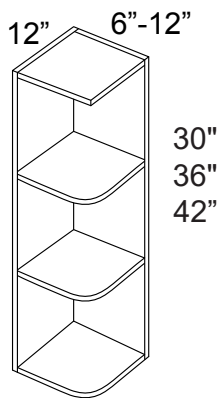

OPEN END

ITEM	N
OE1230	480
OE1236	565
OE1242*	605

- Comes as 12" (Fabuwood will cut to 6" at no charge)
- * Has three shelves

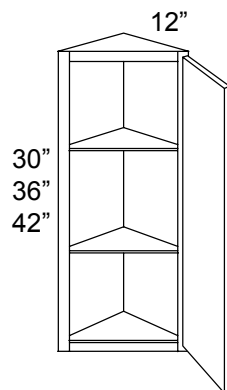

ANGLE END

ITEM	N
WAE1230	380
WAE1236*	435
WAE1242*	495

- Can use glass door from a Diagonal Corner Wall cabinet - will require a 1" overlay hinge
- Adjustable shelves
- * Has three shelves

Base Cabinets

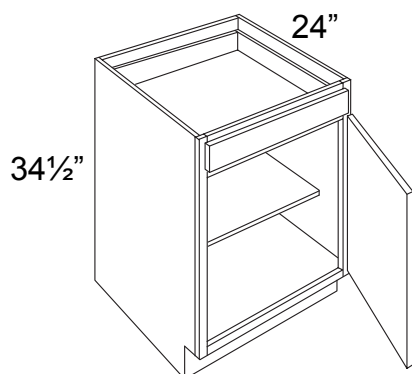

SINGLE DOOR

ITEM	N
B09	345
B12	385
B15	400
B18	430
B21	475

- B09 accessories pg. 23
- Peninsula cabinet modification pg. VIII
- Roll Outs pg. 21

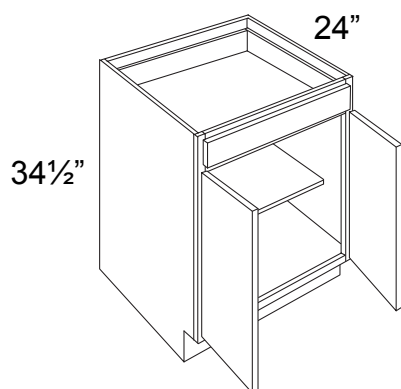

DOUBLE DOOR

ITEM	N
B24	520
B27	580
B30	625

- Peninsula cabinet modification pg. VIII
- Roll Outs pg. 21

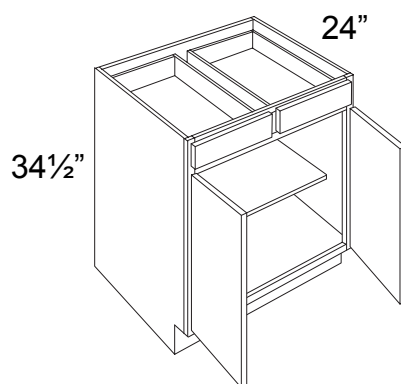

DOUBLE DOOR & DRAWER

ITEM	N
B33	660
B36	695
B39*	730
B42*	805

- * Has 3" center stile
- Roll Outs pg. 21

Base Cabinets

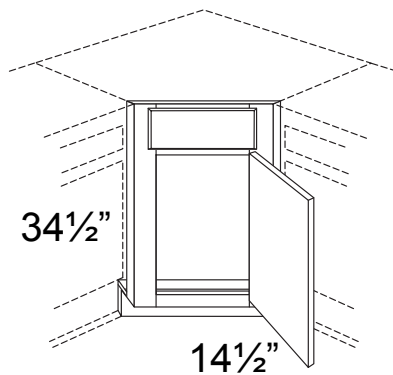
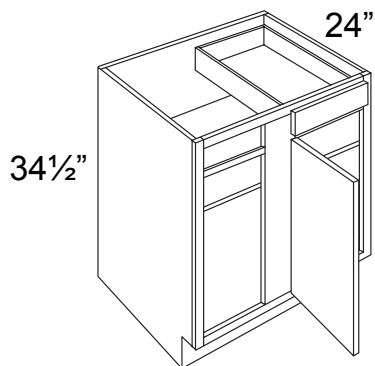
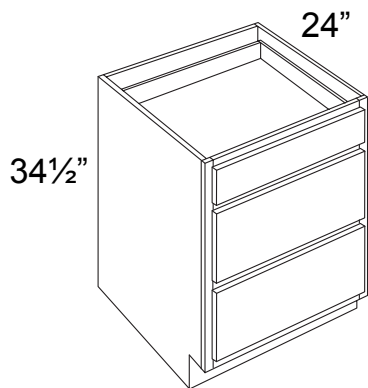

DRAWER

ITEM	N
DB12	585
DB15	600
DB18	635
DB24	685
DB30	1085
DB36	1135

BLIND

ITEM	N
BLB36/39	650
BLB42/45	735
BLB48/51	835

- Must use filler on adjacent side (not supplied)
- Measurements are rounded off to closest 1/8"

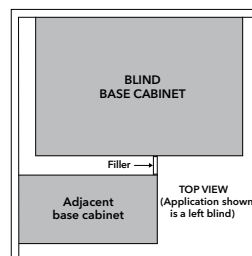

	Act.	Min.	Max	Door	Stile	Open
BLB36/39	27"	36"	41 1/4"	10 1/2"	8"	8"
BLB42/45	39"	42"	47 1/4"	15 1/4"	9"	14"
BLB48/51	48"	48"	52"	21 1/4"	7 1/4"	18 3/4"

DIAGONAL SINK FRONT

ITEM	N
DSF36*	225
DSFL36**	130

- Uses 3/8" overlay hinge
- Tilt Out pg. 27
- * DSF36 The sink front has a 17" face dimension.
- ** DSFL36 The floor must be ordered separately

Base Cabinets

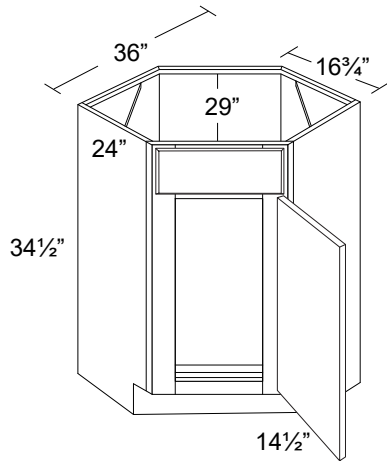

DIAGONAL SINK

ITEM	N
DSB36	930

- Uses $\frac{3}{8}$ " overlay hinge
- Tilt Out pg. 27

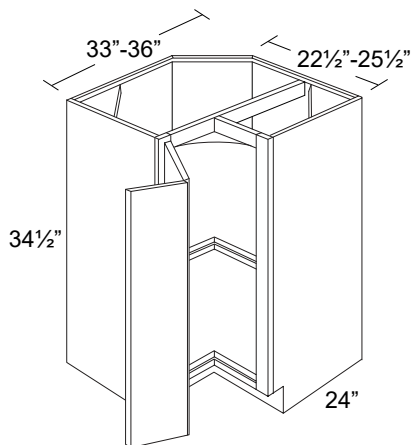

LAZY SUSAN

ITEM	N
LSB33	1070
LSB36	1160

- Once assembled, door cannot be reversed
- Both wooden Lazy Susan trays rotate independently
- Center tray is mounted on 15mm ($\frac{9}{16}$ ") adjustable shelf

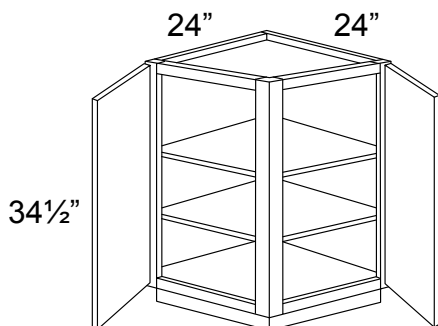

RETURN ANGLE

ITEM	N
BRA24	620

- Door width: 17 1/2"
- Adjustable shelving

Base Cabinets

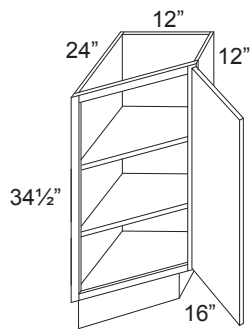

BASE TRANSITIONAL RIGHT
SHOWN

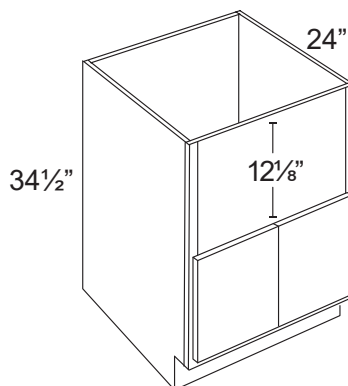
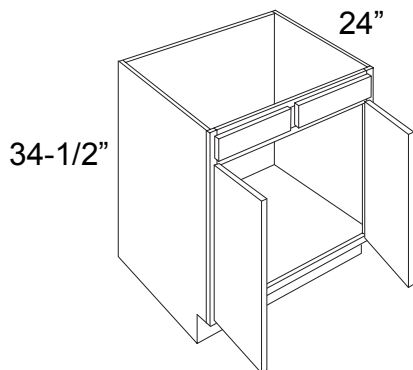
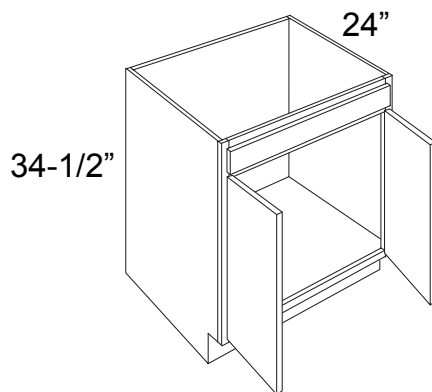

TRANSITIONAL

ITEM	N
BTR12	440
BTL12	440

SINK

ITEM	N
SB24	510
SB27	530
SB30	560

- Tilt Out pg. 27

SINK

ITEM	N
SB33	585
SB36	595
SB39*	615
SB42*	625

- Tilt Out pg. 27
- * Has a 3" center stile

FARM SINK

ITEM	N
FS30	1400
FS33	1420
FS36	1435

- Cut opening on job site
- Frame has a full closed top panel Maximum cutout height 12"
- Maximum cutout width 1 1/2" less than the cabinet size

Note: To avoid damage please apply extra care when cutting the front panel.

Tall Pantry Cabinets

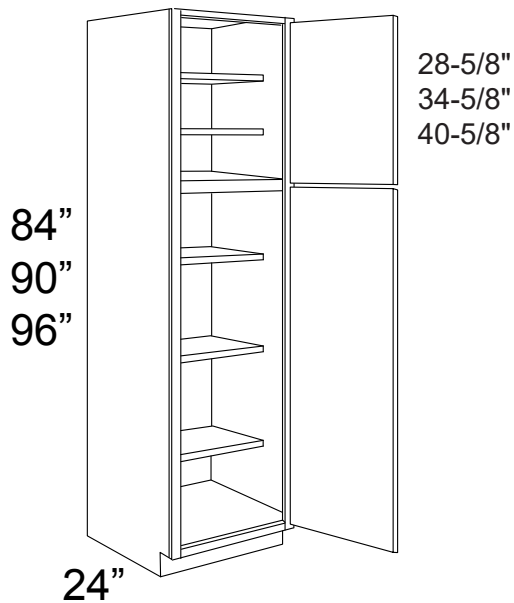

SINGLE DOOR

ITEM	N
TP152484	1185
TP182484	1285
TP152490	1280
TP182490	1350
TP152496	1340
TP182496	1410

- 84" high - 5 shelves
- 90" & 96" high - 6 shelves
- 18" deep shelves
- Roll Outs pg. 21

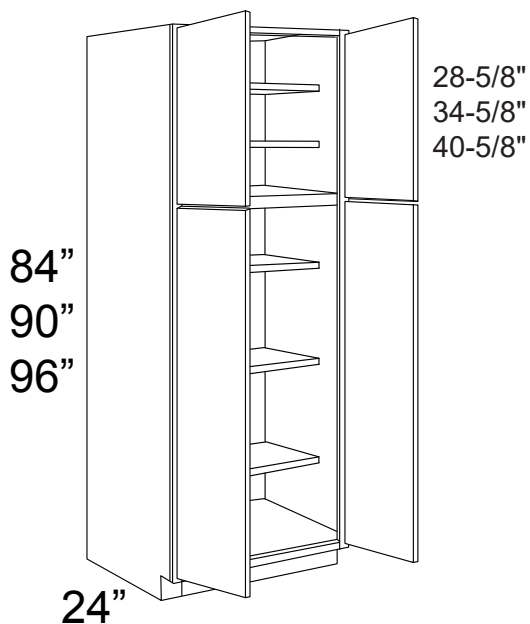

DOUBLE DOOR

ITEM	N
TP242484	1350
TP302484	1445
TP242490	1435
TP302490	1540
TP242496	1490
TP302496	1600

- 84" high - 5 shelves
- 90" & 96" high - 6 shelves
- 18" deep shelves
- Roll Outs pg. 21

Oven Cabinets

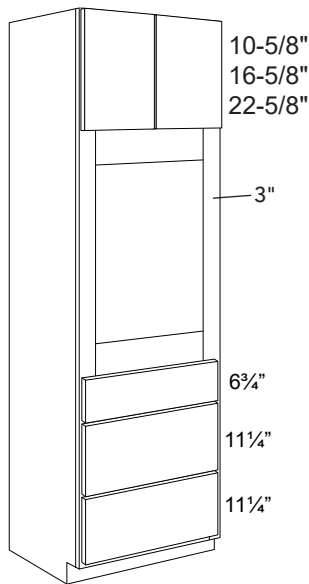

OVEN CABINET

ITEM	N
OC3384	2175
OC3390	2215
OC3396	2240

* Has one shelf in top cabinet.

When using a Single Oven:

- Wide rails face frame to be trimmed on side
- Minimum Width opening 27"
- Maximum **cut out** width 31"
- Minimum Height opening 28 1/2"
- Maximum **cut out** height is 37"
- Maximum **overall** oven Height 37 1/2"

When using a Combo Oven:

- Wide rails face frame to be trimmed on side
- Minimum Width opening 27"
- Maximum **cut out** width 31"
- Minimum **cut out** height 39 3/8"
- Maximum **cut out** height is 44"
- Maximum **overall** oven Height 44 5/8"

When using a Double Oven:

- Wide rails face frame to be trimmed on side
- Minimum Width opening 27"
- Maximum **cut out** width 31"
- Minimum **cut out** height is 50 3/4"
- Maximum **cut out** height is 55 1/2"
- Maximum **overall** oven Height 56"

When using two appliances:

- Will need to insert a filler and fixed shelf to support top appliance, filler and shelf to be purchased separately

Please include size of oven cut out in your order.
Full panel face frame to be trimmed on site (not by Fabuwood).

Note: To avoid damage to the frame & side panels, please apply extra care when cutting the front panel.

SPECIFICATION FOR OVEN CABINET

Tall Oven Cabinets come with single fixed shelf above top drawer.
Fixed shelf will be located above the uppermost drawer; location is based on the selected configurations: Single, Combo, Double.
Frame is to be trimmed on site to accommodate configuration & appliance needs.

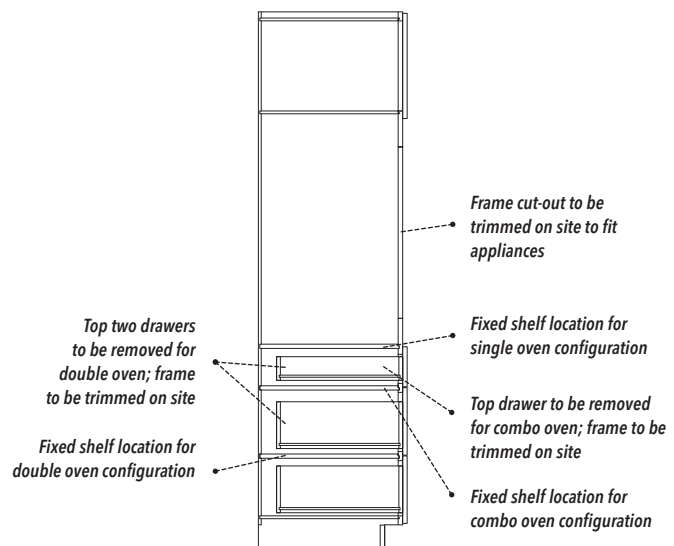

Vanities

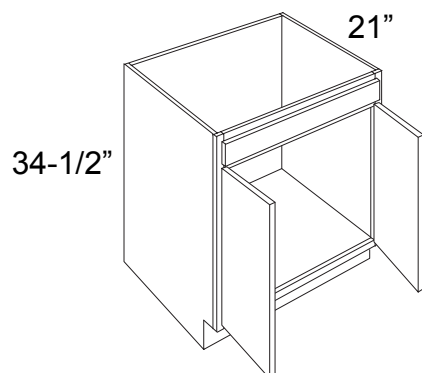

34 1/2" HIGH VANITY SINK BASE

ITEM	N
VSB24-34	500
VSB30-34	530

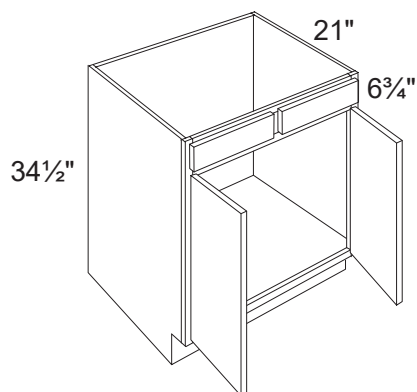

34 1/2" HIGH VANITY SINK BASE

ITEM	N
VSB36-34	570

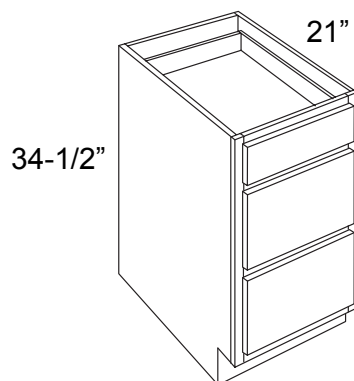

34 1/2" HIGH VANITY DRAWER BASE

ITEM	N
VDB12-34	535
VDB15-34	560

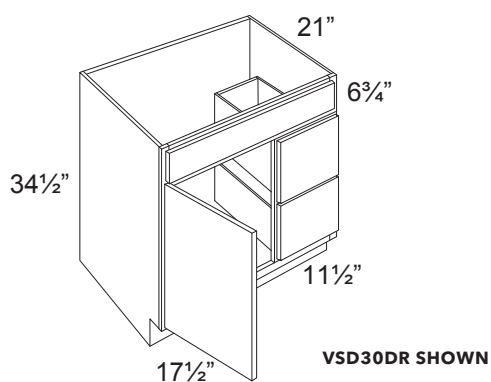

VANITY SINK BASE COMBO

ITEM	N
VSD30DR	785
VSD30DL	785

Need to select drawer on right or left side, cabinet can't be reversed R/L after assembled.

Vanities

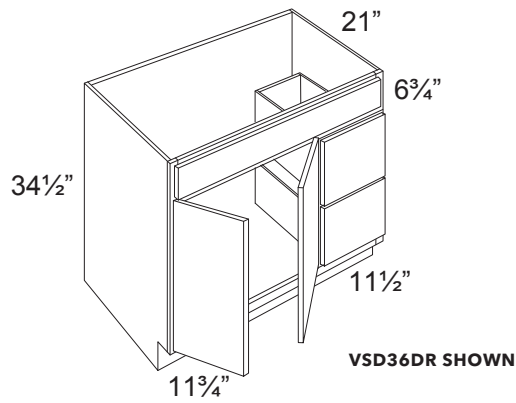

VANITY SINK BASE COMBO

ITEM	N
VSD36DR	840
VSD36DL	840

Need to select drawer on right or left side, cabinet can't be reversed R/L after assembled.

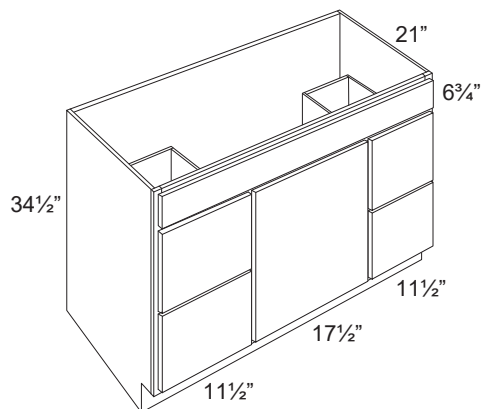

VANITY SINK BASE COMBO

ITEM	N
VSD42 (34" high)	910

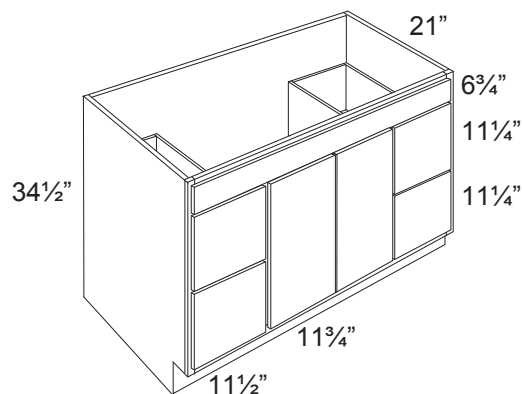

VANITY SINK BASE COMBO

ITEM	N
VSD48 (34" high)	1035

Waste Solutions / Accessories

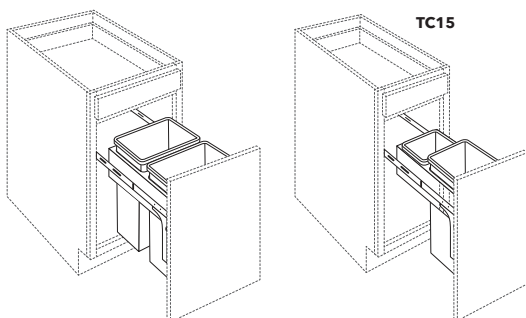

TRASH CAN

ITEM	N
TC15	560
TC18	825
TC21	890

- Cabinet not included, cabinet must be ordered separately
- Full extension slides (not soft-close)
- 35 qt. can(s) included
- * One garbage can and one bags bin

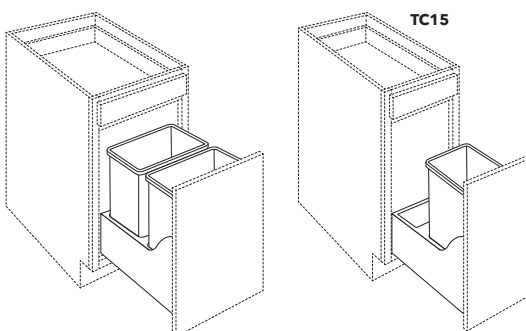

TRASH CAN (W/ BLUM SLIDES)

ITEM	N
TC15 BLUM	1040
TC18 BLUM	1120
TC21 BLUM	1235
TCV15 BLUM♦	945

- Tandem plus Blumotion full extension concealed drawer runners
- Cabinet not included, cabinet must be ordered separately
- 2 - 35 qt. cans included
- * Single 35 qt. can + one bags bin
- ♦ Smaller depth for vanity cabinets 21" deep

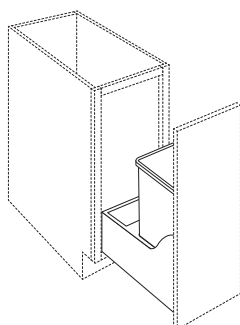

TRASH CAN FULL HEIGHT DOOR (W/ BLUM SLIDES)

ITEM	N
TC15FHD BLUM	1040
TC21FHD BLUM	1235

- Tandem plus Blumotion full extension concealed drawer runners
- Cabinet not included, cabinet must be ordered separately
- 2 - 50 qt. can included
- Includes installation
- Not for ADA cabinet use
- FULL-DOORS modification is required
- * Single 50 qt. can + one bags bin

Base / Accessories

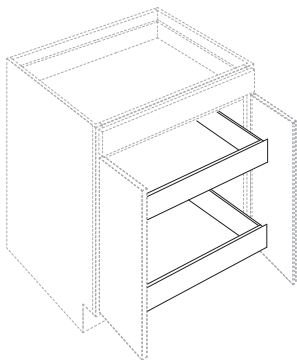

ROLL OUT (PARTIAL EXTENSION BLUM SLIDES)

ITEM	N
ROD-B15 BLUM E	245
ROD-B18 BLUM E	260
ROD-B21 BLUM E	265
ROD-B24 BLUM E	280
ROD-B27 BLUM E	285
ROD-B30 BLUM E	300
ROD-B33 BLUM E	305
ROD-B36 BLUM E	315

- Cabinet not included
- Price is for a single Roll Out drawer
- Blumotion partial extension concealed drawer runners
- Drawers are adjustable
- Can be used for pantries

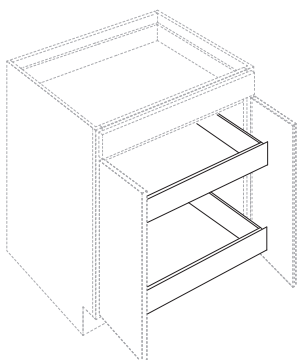

ROLL OUT (FULL EXTENSION BLUM SLIDES)

ITEM	N
ROD-B15 BLUM H	315
ROD-B18 BLUM H	330
ROD-B21 BLUM H	335
ROD-B24 BLUM H	350
ROD-B27 BLUM H	355
ROD-B30 BLUM H	365
ROD-B33 BLUM H	370
ROD-B36 BLUM H	375

- Cabinet not included
- Price is for a single Roll Out drawer
- Blumotion full extension concealed drawer runners
- Drawers are adjustable
- Can be used for pantries

Base / Accessories



TWO-TIER COOKWARE ORGANIZER

ITEM	N
CWO-B18 BLUM	1435
CWO-B24 BLUM	1660

- Cabinet not included
- Full-extension Blum slides
- Pegboard bottoms
- 4 Press-in pegs included



3" TOWEL BAR PULL OUT

ITEM	N
TBPO-BF3	575

- Filler & Overlay Filler are required and need to be ordered separately
- 2 Towel bars
- Single static shelf with chrome wire accents
- UV coated maple wood
- Installed on site
- Installed between two cabinets
- Full-extension, ball-bearing slides with soft-close

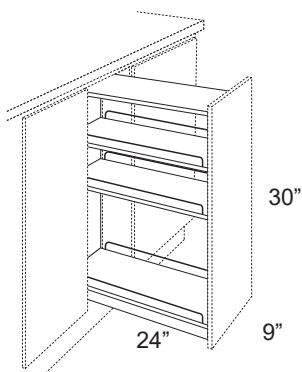

SPICE PULL OUT BASE 9"

ITEM	N
SPO-B9	725
SPO-B9 BLUM	1075

- Cabinet not included, cabinet must be ordered separately
- FULL-DOORS modification is required
- Chrome rails
- Adjustable shelves
- UV coated maple wood
- * Full extension ball-bearing slides (not soft-close)

Storage / Accessories

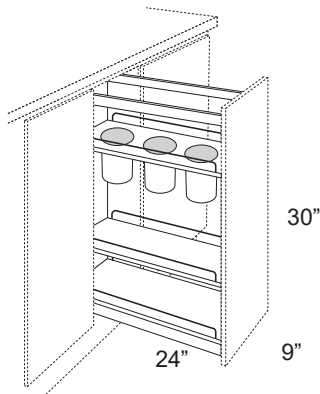

UTENSIL PULL OUT BASE 9" (W/ BLUM SLIDES)

ITEM	N
UPO-B9 BLUM	1175

- Cabinet not included, cabinet must be ordered separately
- FULL-DOORS modification is required
- Chrome rails
- Adjustable shelves
- UV coated maple wood
- Features Blumotion soft-close drawer slides



UTENSIL & KNIFE PULL OUT

ITEM	N
UKBPO-B12 BLUM	1615

- Cabinet not included, cabinet must be ordered separately
- FULL-DOORS modification required
- Knife block features flex rod technology that adjust to securely hold knives
- Chrome rails
- Adjustable top shelf
- 2 qt. removable stainless steel bin included
- 4 flexible plastic cutting mats included
- UV coated maple wood
- Features Blumotion soft-close drawer slides

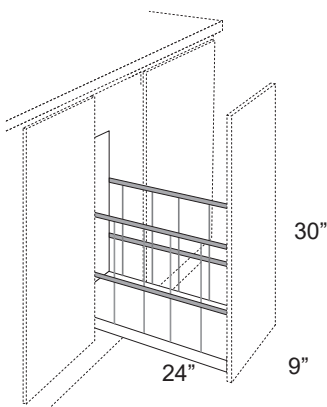

TRAY DIVIDER PULL OUT BASE 9" (W/ BLUM SLIDES)

ITEM	N
TDPO-B9 BLUM	895

- Cabinet not included, cabinet must be ordered separately
- FULL-DOORS modification is required
- UV coated maple wood
- Features Blumotion soft-close drawer slides

Base & Wall / Accessories

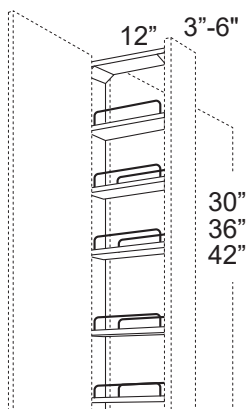
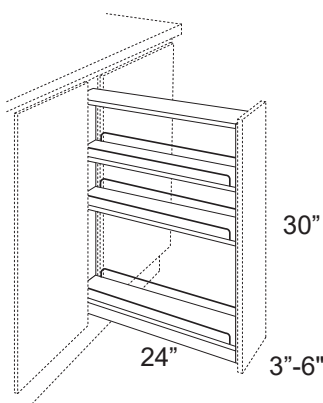

SPICE PULL OUT BASE FILLER

ITEM	N
SPO-BF3*	445
SPO-BF6*	505
SPO-BF3 BLUM	780
SPO-BF6 BLUM	925

- Filler & Overlay Filler are required and need to be ordered separately
- Chrome rails
- Adjustable shelves
- UV coated maple wood
- Installed on site
- Installed between two cabinets
- Not for ADA cabinet use
- Wall filler 30" high is recommended instead of a base filler, requires to build toe kick separately

* Full extension ball-bearing slides (not soft-close)

SPICE PULL OUT WALL FILLER

ITEM	N
SPO-WF330	505
SPO-WF336	540
SPO-WF342	575
SPO-WF630	580
SPO-WF636	625
SPO-WF642	665

- Filler & Overlay Filler are required and need to be ordered separately
- Chrome rails
- Full extension ball-bearing slides (BLUM soft-close slides not available)
- Adjustable shelves
- UV coated maple wood
- Installed on site
- Installed between two cabinets
- Wall filler 30" high is recommended instead of a base filler, requires to build toe kick separately

Wall / Accessories

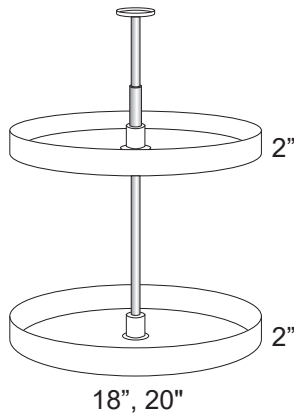

LAZY SUSAN

	ITEM	N
PLASTIC	LSP24 30	300
	LSP24 36/42	455
WOOD	LSW24 30	570
	LSW24 42	890
	LSW27 30*	725
	LSW27 42*	1135

- Adjustable metal post
- 42" lazy susan has 3 trays
- Prepared for installation at job site
- 42" poles can be cut to fit 36" high cabinet
- * 20" trays

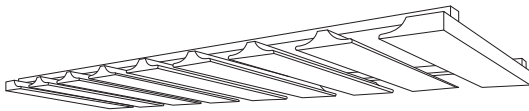

STEMWARE RACK

ITEM	N
STEMWARE 30	535
STEMWARE 36	565

- Comes unfinished. Product finished per order. May have extended ETA.

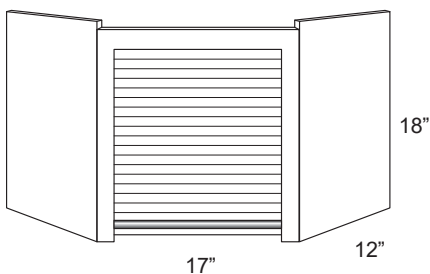

CORNER APPLIANCE GARAGE

ITEM	N
APPLIANCE GARAGE	1010

- Comes unfinished. Product finished per order. May have extended ETA.
- Designed to be installed under a diagonal corner wall 24".

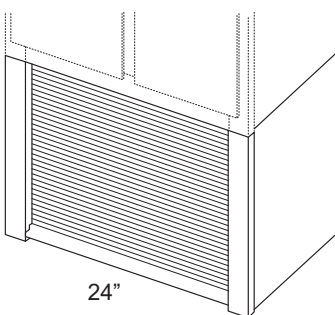

STRAIGHT APPLIANCE GARAGE

ITEM	N
APPLIANCE GARAGE 24"	1295

- Comes unfinished. Product finished per order. May have extended ETA.
- Designed to be placed under a 24" wide wall cabinet.
- Stiles are 2" wide

Wall / Accessories

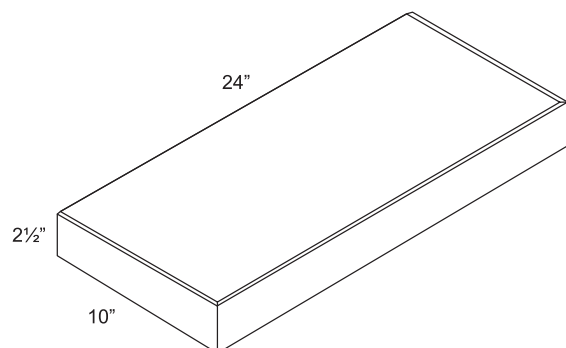

STAINLESS STEEL FLOATING SHELF

ITEM	N
SSFLS24	580
SSFLS30	630
SSFLS36	740

- *Hanging bracket included*
- *Dimensions:*
Width: 24", 30", 36"
Height - 2½"
Depth - 10"

Sink / Accessories

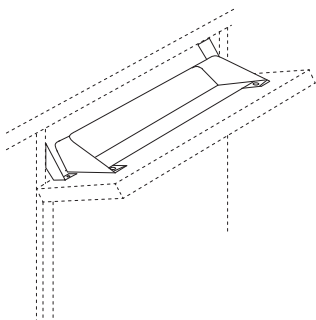

TILT OUT

ITEM	N
TILTOUT 11"	210
TILTOUT 14"	210
TILTOUT 24"	210

- *White plastic tray*

Drawer / Accessories



TIERED DEEP DRAWER

ITEM	N
DTD-DB30 BLUM	1180
DTD-DB36 BLUM	1250

- For DB30 & DB36 only
- Replaces the original drawer box of cabinet
- UV coated maple wood
- Drawer front not included
- 3 drawer compartments
- Blumotion full extension concealed drawer runners



CUTTING BOARD & KNIFE DRAWER

ITEM	N
CBKD-B18 BLUM	895

- For 18" cabinet drawer only
- Replaces the original drawer box of cabinet
- UV coated maple wood
- Up to 4 compartments and built-in knife organizer
- 1 wooden cutting board
- Blumotion full extension concealed drawer runners



CHARGING DRAWER

ITEM	N
CHD-B18 BLUM	1485

- For 18" cabinet drawer only
- Replaces the original drawer box of cabinet
- UV coated maple wood
- Blumotion full extension concealed drawer runners
- (2) 120V plugs and (2) 201 amp USB ports
- Tamper resistant outlets
- Max current: AC: 12 amps @ 120VAC; USB 2.1 amp & 5 VDC
- Power cord with NEMA 5 - 15 plug
- Integrated cord guide to ensure safe operation
- Shock absorbent mat, black
- Overall safety of this product is determined by its end use

Drawer / Accessories

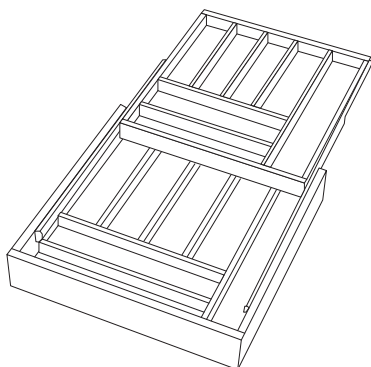

2-TIER CUTLERY DRAWER

ITEM	N
DCD-15 BLUM	470
DCD-18 BLUM	570
DCD-21 BLUM	625
DCD-24 BLUM	660

- UV coated maple wood
- Includes complete 3¾" high drawer box
- Blumotion full extension concealed drawer runners

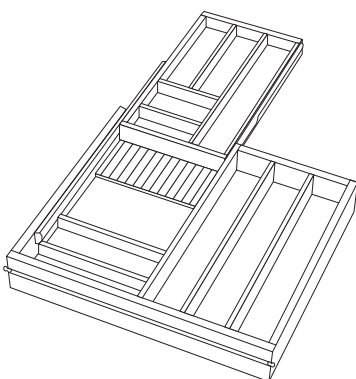

2-TIER CUTLERY COMBO DRAWER

ITEM	N
DCD-30 BLUM	775
DCD-36 BLUM*	900

- UV coated maple wood
- Includes complete 3¾" high drawer box
- * For DB36 only

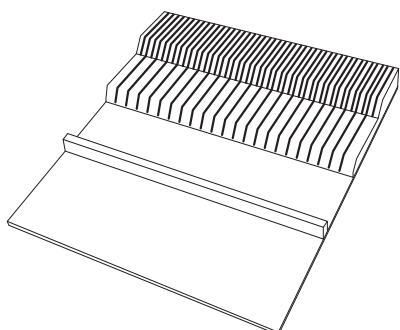

TRIMMABLE KNIFE DIVIDER

ITEM	N
DKI-18/24	280

- UV coated maple wood
- Total height: 2"
- ¾" plywood bottom

Vanity / Accessories



VANITY OUTLET GROOMING ORGANIZER

ITEM	N
VGO12FD BLUM	2085

- Cabinet not included, cabinet must be ordered separately
- FULL-DOORS modification required
- 2 removable stainless steel bins included
- 2 shelves with non-skid vinyl lining and acrylic accents
- In-drawer receptacle with (2) 120V plugs
- Tamper-resistant outlets
- Max Current: AC: 12 amps @ 120VAC
- Power cord with NEMA 5 - 15 plug
- Integrated cord guide ensures safe operation
- Drawer stop prevents items from being stored "ON" inside the cabinet
- Its end-use determines the overall safety of this product
- UV coated maple wood
- Not for ADA cabinet use
- Blumotion full extension concealed drawer runners



TRIMMABLE VANITY DRAWER ORGANIZER INSERT

ITEM	N
VDO	565

- Designed for 21" or smaller vanity base drawers
- Anti-skid vinyl lining
- Up to 13 compartments
- 2 clear acrylic lids
- UV coated maple wood



VANITY APPLIANCE STORAGE RACK

ITEM	N
VASR-30	315

- Designed for 30" vanity base cabinet
- Mounts to inside of right or left door
- Non-skid lining on lower level shelf
- (2) 1.25 qt. stainless steel bins
- UV coated maple wood

Vanity / Accessories



VANITY ORGANIZER PULL OUT

ITEM	N
VOPO-24 BLUM	885

- Tandem plus Blumotion full extension drawer runners
- Designed for 24"-30" Vanity Sink Base
- Reversible
- 6 Acrylic bins included



U-SHAPED VANITY SINK BASE PULL OUT

ITEM	N
UVTCPO-30 BLUM	865

- Tandem plus Blumotion full extension drawer runners
- Designed for 30" Vanity Sink Base, but works great in standard depth base cabinets as well
- Non-skid vinyl lining
- 4 adjustable dividers
- 8 qt. waste container included

Any accessories can be ordered and installed through Fabuwood

Fillers / Accessories

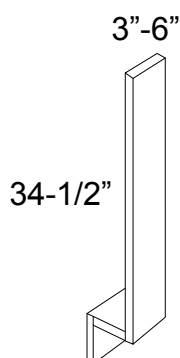
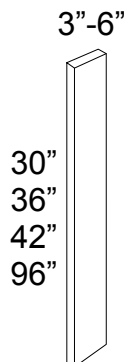

WALL & TALL

ITEM	N
WF330	34
WF336	45
WF342	54
WF630	63
WF636	86
WF642	100
TF396	106
TF696	200

- 2 sides of filler are finished

BASE

ITEM	N
BF3	43
BF6	79

- 2 sides of filler are finished

OVERLAY

ITEM	N
OLFBF3	101
OLFBF6	165
OLF330♦	92
OLF336	105
OLF342	120
OLF630♦	150
OLF636	190
OLF642	225

- Overlay Base Filler is 29½" high
- Sides of filler are finished
- ♦ Will not fit for a base cabinet

Valances / Accessories

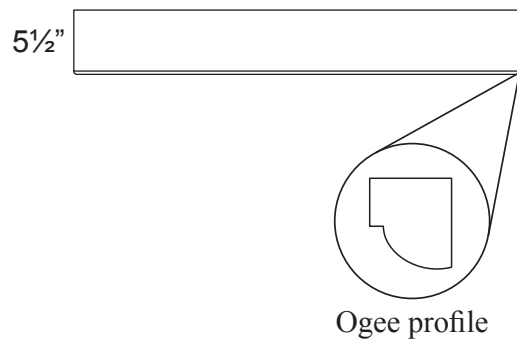

STRAIGHT

ITEM	N
VST96	245

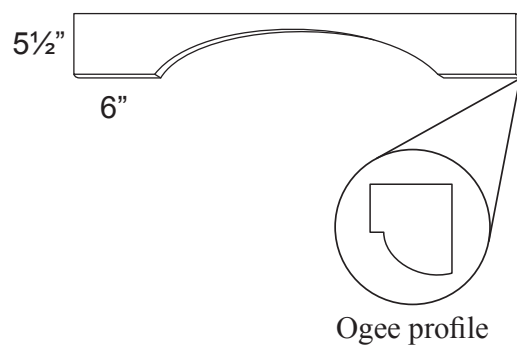

ARCHED

ITEM	N
VAR54	130

Posts & Pilasters / Accessories

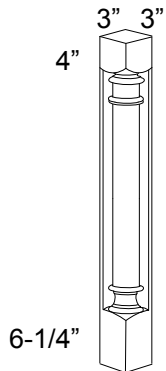

CORNER POST

ITEM	N
CP36	415

- Must trim 2" from top or bottom

Disclaimer: Pilasters are handmade and may therefore feature inconsistencies in shape or form. These are in no way considered defects.

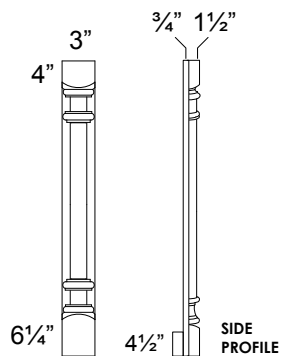

PILASTER BASE

ITEM	N
PP-BASE	300

- Must trim 2" from top or bottom
- Features a toe kick block behind the pilaster

Disclaimer: Posts are handmade and may therefore feature inconsistencies in shape or form. These are in no way considered defects.

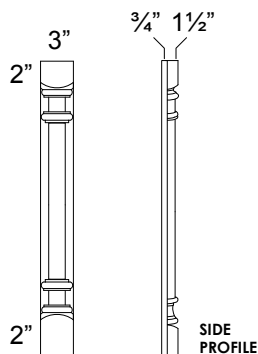

PILASTER WALL

ITEM	N
PP-W30	260
PP-W36	290
PP-W42	320

Disclaimer: Posts are handmade and may therefore feature inconsistencies in shape or form. These are in no way considered defects.

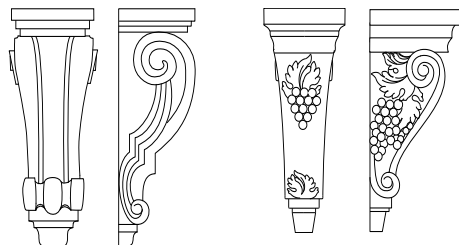

CT
(H6 1/2" x W3 3/4" x D3 1/2")

CG
(H10" x W4 5/8" x D5 1/4")

CORBELS

ITEM	N
CTS	220
CGS	255

Disclaimer: Corbels are handmade and may therefore feature inconsistencies in shape or form. These are in no way considered defects.

Moldings (8') / Accessories

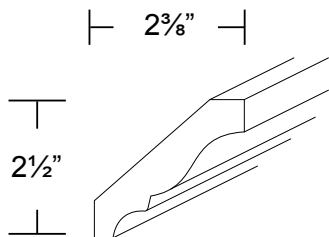

SMALL CROWN

ITEM	N
CM-1	160

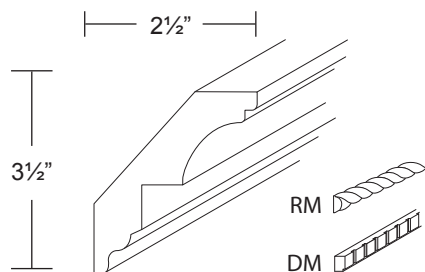

ROYAL CROWN & INLAY

ITEM	N
TCM*	230
RM	94
DM	94

* Back-mounting cleat included

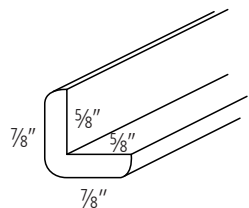
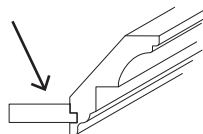

OUTSIDE CORNER

ITEM	N
OCM8	83

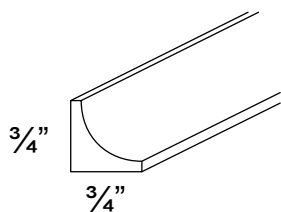

INSIDE CORNER

ITEM	N
ICM8	79

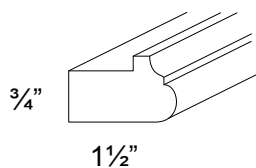

LIGHT RAIL

ITEM	N
LRM	195

Moldings (8') / Accessories

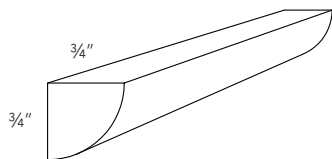

QUARTER ROUND

ITEM	N
QRM	83

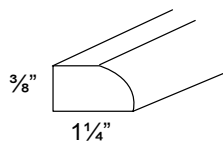

SCRIBE

ITEM	N
SM8	51

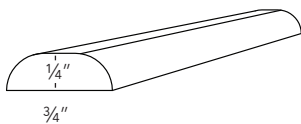

BATTEN

ITEM	N
BM3/4	58

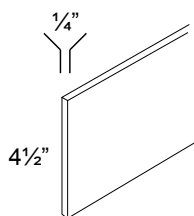

TOE KICK

ITEM	N
TK8	73

- Matching color medium-density fiberboard toe kick

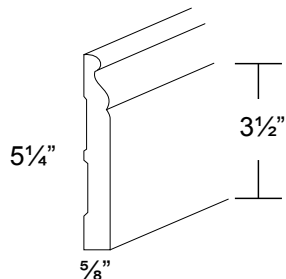

BASE

ITEM	N
BBM	245

Panels / Accessories

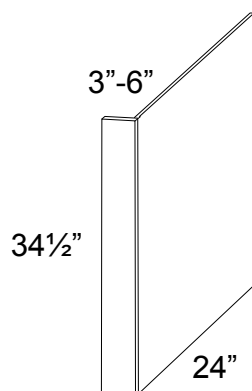

DISHWASHER END PANEL

ITEM	N
DWR3	170
DWR6	260

- Sides are flush finished (no 1/4" reveal)

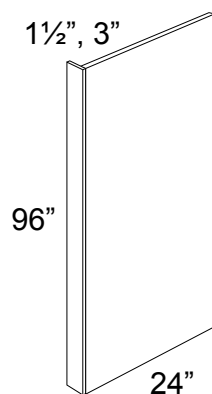

REFRIGERATOR END PANEL WITH RETURN

ITEM	N
REP1-1/2	330
REP3	430

- Sides are flush finished (no 1/4" reveal)

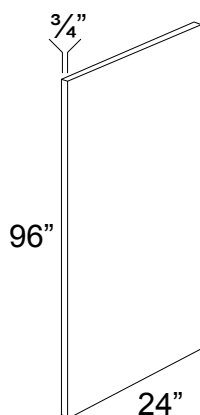

REFRIGERATOR END PANEL

ITEM	N
REP2496	390

- Edge banded on both 96" sides.

Panels / Accessories

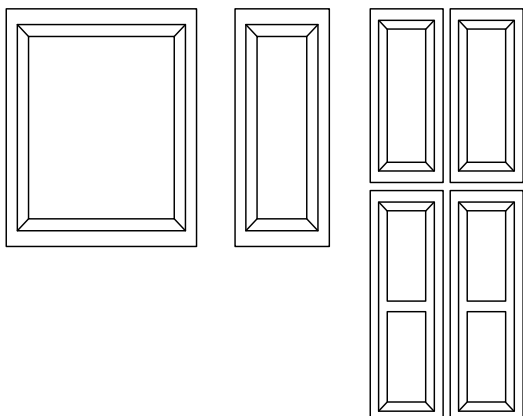

WAINSCOT

ITEM	N
WP-BASE	365
WP-W30	140
WP-W36	175
WP-W42	210
WP-T84	630
WP-T90	690
WP-T96	770

- BASE - 23-1/2" X 29-1/2"
- W30 - 11-1/2" X 28-5/8"
- W36 - 11-1/2" X 34-5/8"
- W42 - 11-1/2" X 40-5/8"
- TALL WIDTH - 11-3/4" each door
- TALL BOTTOM DOORS ARE 49-1/4"H

Tall panels can be used for 12"D Pantry by using 2 pieces from the set of 4.

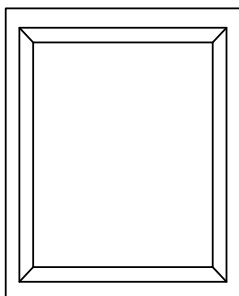

DECO DOOR

ITEM	N
DD B09FD	125
DD B12FD	165
DD B15FD	200
DD B18FD	225
DD B21FD	255

- Door height is 29-1/2"
- Door width is same as door on cabinet

Wainscot Panels may come with hinge holes pre-drilled on the back of the door

Panels / Accessories

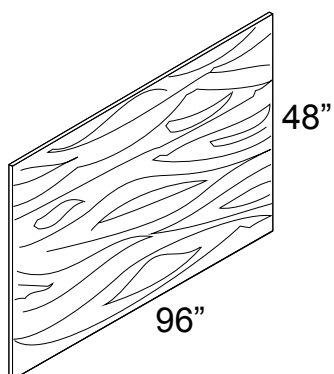

PLYWOOD

ITEM	N
PAN-1/4	350
PLY-1/2	595
PLY-3/4	690



TOUCH UP KIT

ITEM	N
TOUCH UP KIT	83

This image shows a single sheet of white paper with horizontal ruling lines. The lines are evenly spaced and run across the width of the page. There are no margins, text, or other markings on the paper.

This image shows a single sheet of white paper with horizontal ruling lines. The lines are evenly spaced and run across the width of the page. There are no margins, text, or other markings on the paper.

Copyright © 2022 by Fabuwood Cabinetry Corp.

All rights reserved.

No part of this publication may be reproduced, distributed, or transmitted in any form or by any means, including photocopying, scanning, or other electronic or mechanical methods, including online sharing, without the prior written permission of Fabuwood Cabinetry Corp.



69 Blanchard Street | Newark, NJ 07105 | T: (201) 432-6555 | F: (201) 432-6055 | www.fabuwood.com

