



Quest

Specifications Guide / Valid thru May 2022

Please Note: Items are subject to change without prior notice. This spec book is missing some updated information, so to stay up to date with product specifications and modification options please use our new digital spec book which can be found at <https://ezpricing.fabuwood.com/specbook>

Construction Specifications

Quest Doors and Drawer Fronts:

The 5 piece Quest traditional overlay door has an MDF recessed center panel captured in a $\frac{3}{4}$ " solid frame and is complimented with 5-piece matching drawer front.

Hinges:

Compact Blumotion (#38N355B.06) soft-close mechanism integrated in concealed six-way adjustable hinges.

Drawers:

The Quest line includes a $\frac{5}{8}$ " thick solid wood dovetail drawer box with a $\frac{3}{8}$ " plywood bottom. Tandem plus Blumotion (#554H5330B01) 80% extension concealed drawer runners.

Shelving:

15mm ($\frac{5}{8}$ ") thick select veneered plywood with matching wood edge-banding is used on all wall and base cabinetry where applicable. The adjustable shelves are supported by plastic self locking shelf clip.

Backs, Tops and Bottoms:

$\frac{1}{2}$ " thick veneered plywood with natural finished interiors. The backs are stapled and screwed into place for additional support.

Face Frame:

$\frac{3}{4}$ " x $1\frac{1}{2}$ " solid wood stiles and rails jointed with glue and dowels. Back of face frames are grooved to accept side panels.

Toe Kick:

$\frac{3}{4}$ " x $4\frac{1}{2}$ " select unfinished plywood toe kick is added to each assembled cabinet. Additional 8-foot lengths of $\frac{1}{4}$ " toe kicks are available in matching colors to our cabinetry.

Panel Beams:

Panel beam is fastened into a dovetail groove at the top of each base cabinet to ensure a straight fully integrated side, and for the mounting of the countertop.

Construction Specifications

- 1 Solid wood door and drawer front frames are mortise and tenon.
- 2 Door and drawer fronts are standard overlay.
- 3 Compact Blumotion (#38N355B.06) soft-close mechanism integrated in concealed six-way adjustable hinges.
- 4 5/8" solid wood dovetail drawer with 3/8" plywood bottom. Tandem plus Blumotion (#554H5330B01) 80% extension concealed drawer runners.
- 5 2 1/2" interior drawer height.
- 6 3/4" x 1 1/2" solid wood face frame.
- 7 1/2" select veneered plywood back with a natural finished interior.
- 8 1/2" unfinished plywood side panels grooved into face frame.
- 9 15mm (5/8") select veneered plywood adjustable shelving with matching wood veneer edge banding.
- 10 Base and tall cabinets are constructed with 3/4" x 4 1/2" plywood toe kick.
- Additional 8-foot lengths of 1/4" toe kicks are available in matching colors to our cabinetry.
- 11 Panel beam is fastened into a dovetail groove at the top of each base cabinet to ensure a straight fully integrated side, and for mounting of the countertop.
- 12 Base cabinet has 11 7/8" deep shelf.
- 13 When placing an order, need to select exposed sides; Right, Left or Both.
A 1/4" select medium-density fiberboard panel will be applied to the selected side(s), and the side will be near flush finished.

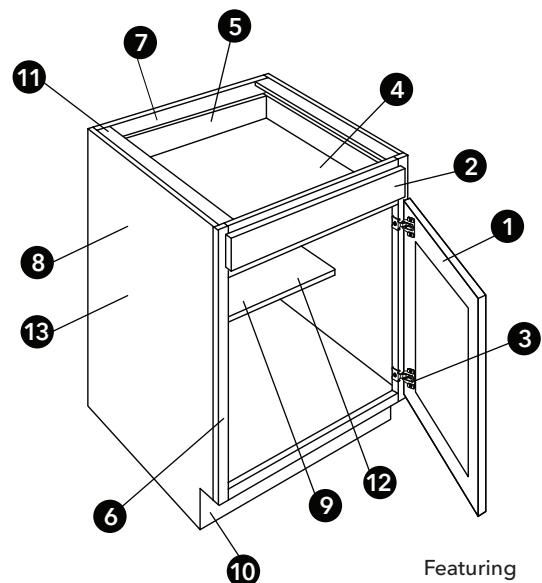
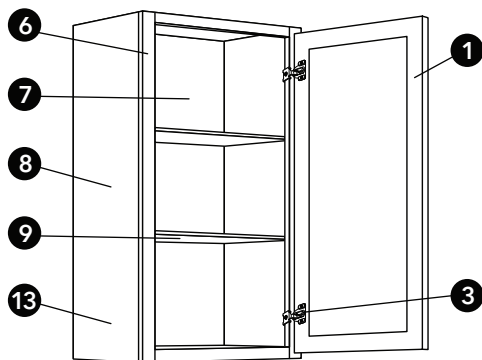

Featuring
blum®

Door Style

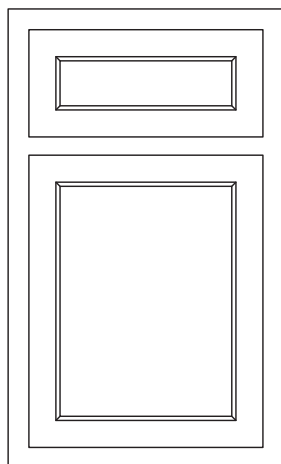

METRO

COLOR	FINISH
Frost	Paint
Mist	Stain
Java	Stain

- Traditional overlay door
- Rails are solid wood 3/4" thick and 2" wide
- Constructed with mortise and tenon joints
- MDF center panel captured into solid birch rails 6mm thick
- 5-piece recessed panel drawer front matches door edge design
- Door & drawer stiles and rails are 3/4" thick

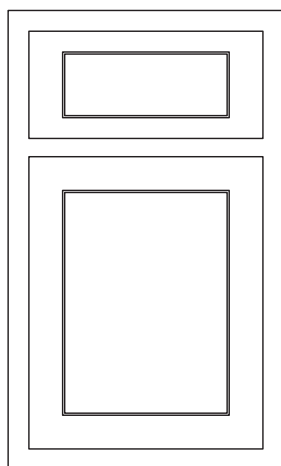

DISCOVERY

COLOR	FINISH
Frost	Paint

- Traditional overlay door
- Rails are solid wood 3/4" thick and 2 1/4" wide
- Constructed with mortise and tenon joints
- MDF center panel is 5mm thick
- 5-piece recessed panel drawer front matches door edge design

Sales Tools

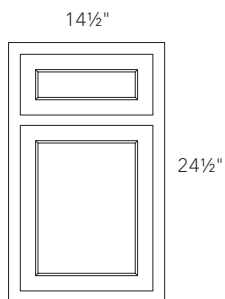

DOOR SAMPLES WITH DRAWER FRONT

ITEM	DESCRIPTION	NET PRICE
SDMF	METRO FROST	30
SDMM	METRO MIST	30
SDMJ	METRO JAVA	30
SDDF	DISCOVERY FROST	30

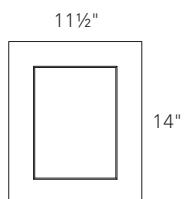

SMALL DOOR SAMPLES

ITEM	DESCRIPTION	NET PRICE
SDMF-2	METRO FROST	23
SDMM-2	METRO MIST	23
SDMJ-2	METRO JAVA	23
SDDF-2	DISCOVERY FROST	23

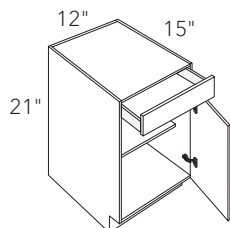

MINI BASE SAMPLE

ITEM	DESCRIPTION	NET PRICE
MM MBS	BASE SAMPLE 12"W X 21"H X 15"D	115

- Available in Allure Galaxy Frost and Quest Metro Mist finish only.

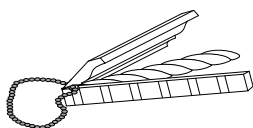

MOLDING CHAIN

ITEM	DESCRIPTION	NET PRICE
MLK-QUEST	COMPLETE CHAIN OF ALLURE MOLDINGS	46

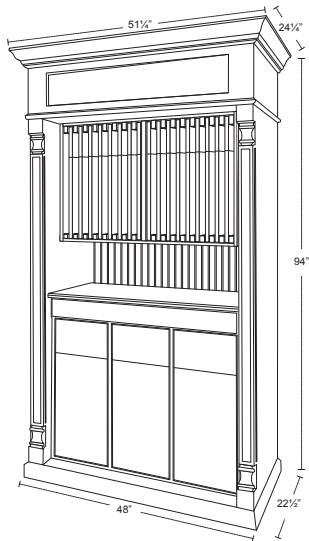

SELLING CENTER

ITEM	DESCRIPTION	NET PRICE
DEALER SELLING CENTER	FABUWOOD SELLING CENTER	1700

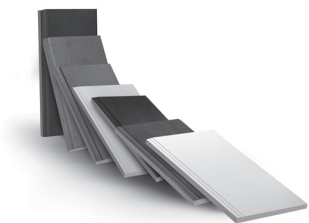

COLOR BLOCKS

ITEM	DESCRIPTION	NET PRICE
COLOR BLOCK	BOX OF COLOR BLOCKS	35

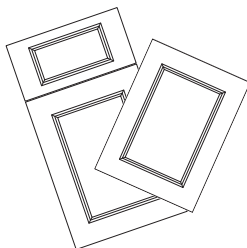

SAMPLE PACKAGES

ITEM	DESCRIPTION	NET PRICE
SMALL SAMPLE PACKAGE	SMALL SAMPLE PACKAGE	570
DEALER PACKAGE	LITERATURE AND ACCESSORIES	795



DIGITAL BROCHURE

ITEM	DESCRIPTION	NET PRICE
DIGITAL BROCHURE QR	QR CODE KEY RING	23

Modifications

CUT ITEMS

ITEM	DESCRIPTION	LIST
CUT-BASE	Reduce depth of base cabinet (min. depth 12")	370
CUT-DBASE	Reduce depth of drawer base cabinet (min. depth 12")	510
CUT-SBASE	Reduce depth of sink base cabinet (no min.)	245
CUT-WALL	Reduce depth of wall cabinet (no min.)	310
CUT-TALL	Reduce depth of tall cabinet (no min.)	710
CUT-DOOR	Cut out center panel of door for glass insert (per door, glass not included)	210
CUT-COLUMN	Reduce depth of column (specify depth)	265
CUT-BASE HEIGHT	Reduce height of base cabinet by cutting off top drawer (total base height: 28½")	310
CUT-TK	Reduce toe kick height (no min.)	120
CUT-PANEL	Cut down a panel to any size	83/pc.
CUT-ROD	Reduce depth of rollout drawer (specify depth of cabinet)	125

PIPE CHASE

ITEM	DESCRIPTION	LIST
CHASE-BASE	Make chase in base cabinet	605
CHASE-DBASE	Make chase in drawer base cabinet	875
CHASE-WALL	Make chase in wall cabinet	325
CHASE-TALL	Make chase in tall cabinet	910
CHASE-CORNER	Make chase in corner cabinet (WDC, WPC & ERB only)	1205

Must supply a drawing for all chase modifications.

CUSTOMIZATIONS

ITEM	DESCRIPTION	LIST
CREATE-ERB	Remove tray, install bottom panel on top, to create easy reach	
CREATE-RETURN WALL*	Create a return wall filler up to 6"W x 15"D x 42"H (materials incl.)	470
CREATE-RETURN TALL*	Create a return tall filler up to 6"W x 30"D x 96"H (materials incl.)	865
CREATE-COLUMN BASE*	Create a 3" column up to 30"D by 34½"H	805
CREATE-COLUMN TALL*	Create an oversized column	1455
CREATE-COLUMN WALL*	Create a 3" column up to 15"D x 42"H	605
HAMPER	Install door mounted pull out wood hamper in cabinet (cabinet not incl.)	710

* Email orders@fabuwood.com for quote

MODIFICATIONS

ITEM	DESCRIPTION	LIST
BMC24	Create a 24" base microwave cabinet from a DB24 with a closed front	
REMOVE-DRAWER	Remove cabinet drawer to create false drawer front	63
CLOSE-BLIND	Close open section of a blind wall or base cabinet	103
ATTACH-TK	Attach toe kick on wall cabinet	120

Modifications

MODIFICATIONS CONT.

ITEM	DESCRIPTION	LIST
RECESS-TK	Recess toe kick of base cabinet (must supply a drawing)	210
EDGE-BAND	Additional edge banding (price per linear foot)	10
PEN-CABINET	Create a peninsula cabinet from 2 cabinets (cabinets not incl.)	415
INCREASE-BASE	Increase depth on base cabinet	110
INCREASE-WALL	Increase depth on wall cabinet	110
INCREASE-TALL	Increase depth on tall cabinet	110
MATCH-INTERIOR	Stain interior of cabinet to match exterior	67
CREATE- SQ BOTTOM	Square bottom shelf for wall open end to enable light rail molding	103
FLUSH-WALL BOTTOM	Flush the bottom of a wall cabinet	310
FLUSH-TOE KICK	Flush toe kick of base cabinet to face frame (sides not finished)	185
FULL-DOORS	Create full height door base cabinet from 2 cabinets (cabinets not incl.)	125
OE6	Cut OE12 to 6"	0

* Email orders@fabuwood.com for quote

UPGRADES

ITEM	DESCRIPTION	LIST
INSTALL-ACCES	Install any accessory in a cabinet (accessories not incl.)	Quote*

* Email orders@fabuwood.com for quote

LOOSE PARTS

ITEM	DESCRIPTION	LIST
SHELF BASE	Loose 24" deep shelf (specify cabinet size)	
SHELF WALL	Loose 12" deep shelf (specify cabinet size)	
SHELF TALL	Loose 24" deep shelf (specify cabinet size)	
SHELF-DSB	Loose shelf (specify cabinet size)	315
SK BASE	Skin for base cabinet with adhesion	83
SK MC	Skin for microwave wall cabinet with adhesion	66
SK TALL	Skin for tall cabinet with adhesion	220
SK W30	Skin for 30" high wall cabinet with adhesion	66
SK W36	Skin for 36" high wall cabinet with adhesion	66
SK W42	Skin for 42" high wall cabinet with adhesion	66

Many more modifications available- please contact your customer service rep.

12", 15" & 18" High Wall Cabinets

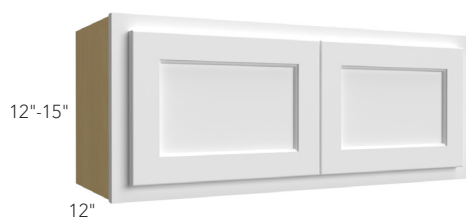

12" - 15" HIGH

ITEM	LIST
W3012	270
W3612	300
W2415	265
W3015	265
W3315	300
W3615	320

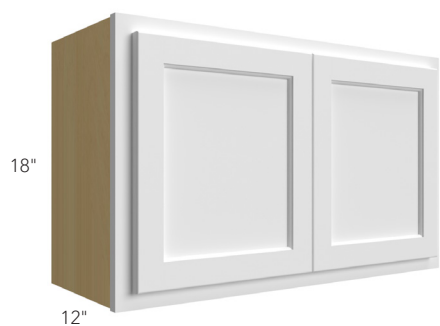

18" HIGH

ITEM	LIST
W2118*♦	
W2418	290
W3018	290
W3318	335
W3618	345

* One door only

♦ Discontinued items are available in limited quantities while supplies last.

24" High & 24" Deep Wall Cabinets

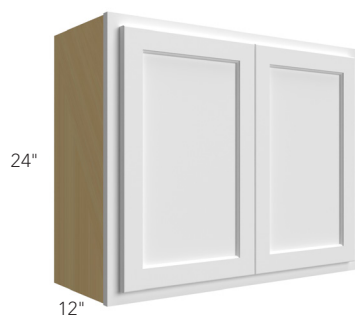

24" HIGH

ITEM	LIST
W2424	325
W3024	355
W3324	385
W3624	430

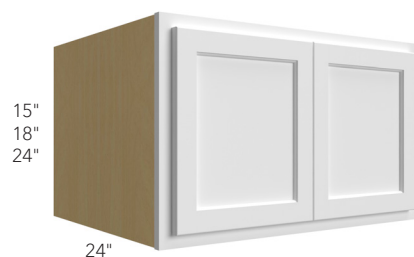

24" DEEP

ITEM	LIST
W301524	355
W331524	620
W361524	455
W301824	410
W331824	675
W361824	500
W302424*	455
W332424*	710
W362424*	525

* Has 1 shelf

30" High Wall Cabinets



SINGLE DOOR

ITEM	LIST
W0930	215
W1230	230
W1530	260
W1830	290
W2130	325

- Peninsula modification available on pg. VIII

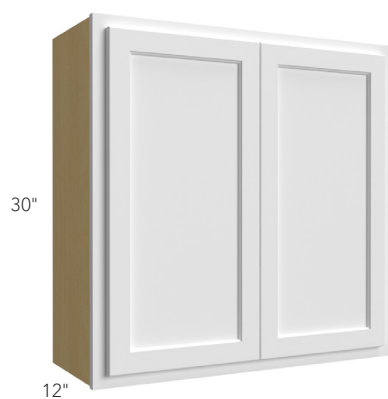

DOUBLE DOOR

ITEM	LIST
W2430	350
W2730	395
W3030	405
W3330	445
W3630	460

- Peninsula modification available on pg. VIII

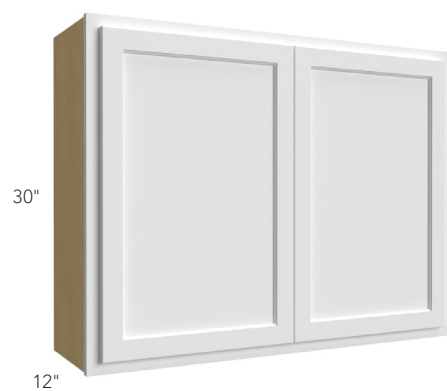

DOUBLE DOOR

ITEM	LIST
W3930	495
W4230	560

- 1½" center stile
- Peninsula modification available on pg. VIII

30" High Wall Cabinets



60" WIDE COMBINATION

ITEM	LIST
W6030	745

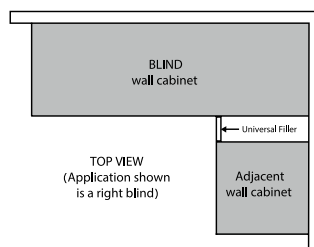

SINGLE DOOR BLIND

ITEM	LIST
WBC2430	400
WBC3030	475
WBC3630	555

- Must use filler on adjacent side (not supplied)
- Measurements are rounded off to closest 1/8"

	Act.	Max	Door	Stile	Open (door side)
WBC2430	24"	27"	8 3/4"	6"	7 3/4"
WBC3030	30"	33"	14 1/2"	6"	13 3/4"
WBC3630	36"	39"	20 1/2"	6"	19 3/4"

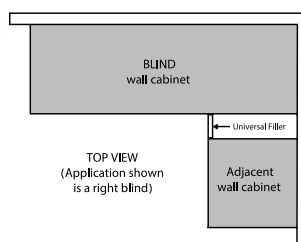

DOUBLE DOOR BLIND

ITEM	LIST
WBC4230	645

- Must use filler on adjacent side (not supplied)
- Measurements are rounded off to closest 1/8"

	Act.	Max	Door	Stile	Open (door side)
WBC4230	42"	45"	13 3/4"	6"	25 3/8"

30" High Wall Cabinet & Glass Doors

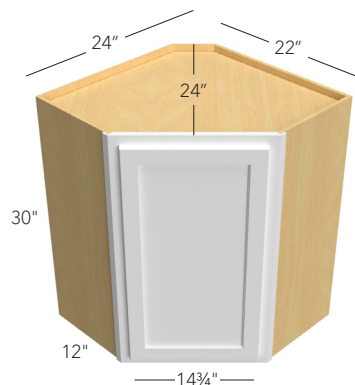

DIAGONAL CORNER

ITEM	LIST
WDC2430	520

- For Lazy Susan see accessories on pg. 25

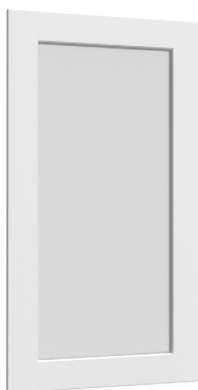
METRO

DISCOVERY

GLASS DOOR

ITEM	LIST
GDD2430*	140
GD3030♦	155
GD3630♦	170

- Glass doors are pre-installed with clear glass only
- * 14 3/4" wide for WDC2430
- ♦ Cost is for a single door - need to order quantity of 2 doors per cabinet

36" High Wall Cabinets



SINGLE DOOR

ITEM	LIST
W0936	240
W1236	265
W1536	310
W1836	350
W2136	385

- Peninsula modification available on pg. VIII



DOUBLE DOOR

ITEM	LIST
W2436	445
W2736	480
W3036	500
W3336	545
W3636	585

- Peninsula modification available on pg. VIII

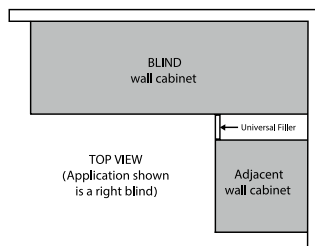

SINGLE DOOR BLIND

ITEM	LIST
WBC2436	535
WBC3636	620

- Must use filler on adjacent side (not supplied)
- Measurements are rounded off to closest 1/8"

	Act.	Max	Door	Stile	Open (door side)
WBC2436	24"	27"	8 3/4"	6"	7 3/4"
WBC3636	36"	39"	20 1/2"	6"	19 3/4"

36" High Wall Cabinets & Glass Doors

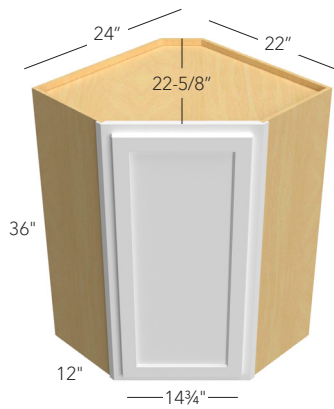

DIAGONAL CORNER

ITEM	LIST
WDC2436	630

- For Lazy Susan see accessories on pg. 25

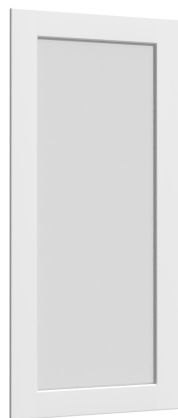

METRO

DISCOVERY

GLASS DOOR

ITEM	LIST
GDD2436*	175
GD3036♦	185
GD3636♦	210

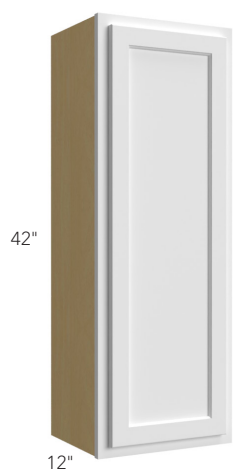
- Glass doors are pre-installed with clear glass only
- * 14 3/4" wide for WDC2436
- ♦ Cost is for a single door - need to order quantity of 2 doors per cabinet

42" High Wall Cabinets



SINGLE DOOR

ITEM	LIST
W0942	250
W1242	295
W1542	340
W1842	385
W2142	415

- Peninsula modification available on pg. VIII



DOUBLE DOOR

ITEM	LIST
W2442	505
W2742	535
W3042	560
W3342	615
W3642	670

- Peninsula modification available on pg. VIII



DOUBLE DOOR

ITEM	LIST
W3942	770

- 1½" center stile
- Peninsula modification available on pg. VIII

42" High Wall Cabinets & Glass Doors

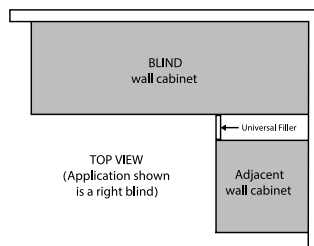
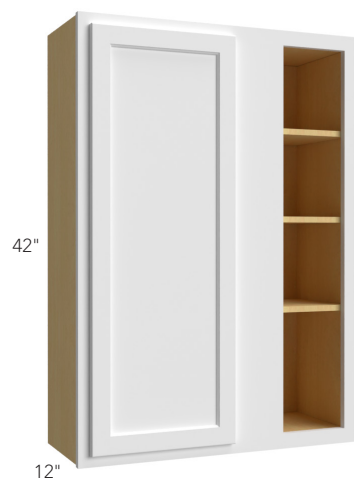

SINGLE DOOR BLIND

ITEM	LIST
WBC2442	625
WBC3642	650

- Must use filler on adjacent side (not supplied)
- Measurements are rounded off to closest 1/8"

	Act.	Max	Door	Stile	Open (door side)
WBC2442	24"	27"	8 3/4"	6"	7 3/4"
WBC3642	36"	39"	20 1/2"	6"	19 3/4"

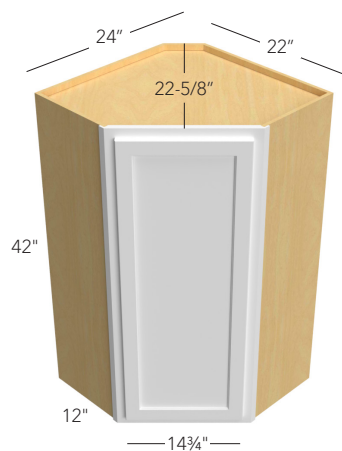

DIAGONAL CORNER

ITEM	LIST
WDC2442	715

- For Lazy Susan see accessories on pg. 25



METRO

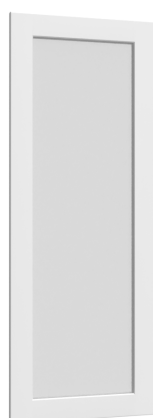

DISCOVERY

GLASS DOOR

ITEM	LIST
GDD2442*	200
GD3042♦	200
GD3642♦	230

- Glass doors are pre-installed with clear glass only
- * 14 3/4" wide for WDC2442
- ♦ Cost is for a single door - need to order quantity of 2 doors per cabinet

Specialty Wall Cabinets

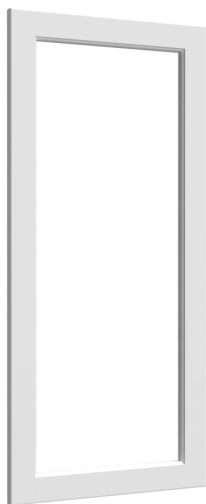

DOOR PREPPED FOR GLASS

ITEM	LIST
DFG3030*	125
DFG3036*	155
DFG3042*	165
DFG3630*	140
DFG3636*	170
DFG3642*	195
DFGD2430	120
DFGD2436	150
DFGD2442	165

- Glass not included
- Comes with the center panel removed; vinyl gasket is included for easy installation of glass in the field.
- * Cost is for a single door, need to order quantity of 2 doors per cabinet

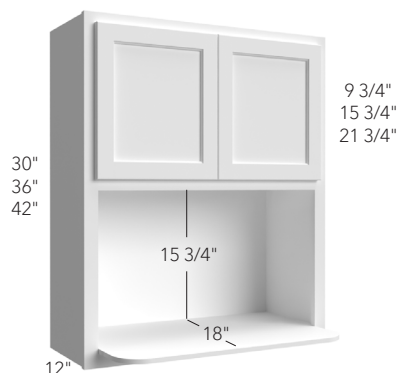

MICROWAVE

ITEM	LIST
MW3030	620
MW3036	635
MW3042	645

- Microwave Wall cabinets have been discontinued from Quest. Items are available in limited quantities while supplies last.

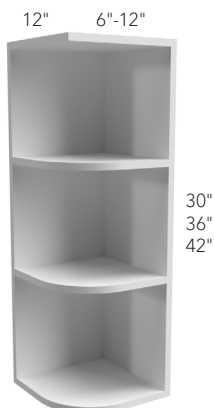

OPEN END

ITEM	LIST
OE1230	480
OE1236	565
OE1242*	605

- Comes as 12" (Fabuwood will cut to 6" at no charge)
- * Has 3 shelves

Full Height Door Base Cabinets



FULL HEIGHT SINGLE DOOR

ITEM	LIST
B09FD	260
B12FD	295
B15FD	315
B18FD	335
B21FD	370



FULL HEIGHT DOUBLE DOOR

ITEM	LIST
B24FD	415
B27FD	480
B30FD	500
B33FD	520
B36FD	530
B39FD	550
B42FD	560

Base Cabinets



SINGLE DOOR

ITEM	LIST
B09	310
B12	345
B15	360
B18	380
B21	415

- B09 accessories available on pg. 23
- Peninsula modification available on pg. VIII
- Roll Outs available on pg. 21



DOUBLE DOOR

ITEM	LIST
B24	465
B27	520
B30	560

- Peninsula modification available on pg. VIII
- Roll Outs available on pg. 21



DOUBLE DOOR & DRAWER

ITEM	LIST
B33	590
B36	620
B39*	650
B42*	715

- Roll Outs available on pg. 21
- * Has 3" center stile

Base Cabinets



DRAWER

ITEM	LIST
DB12	520
DB15	535
DB18	570
DB24	605

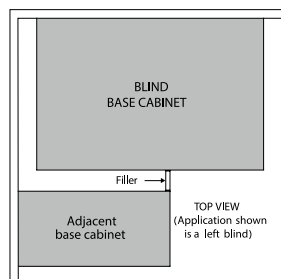

BLIND

ITEM	LIST
BLB36/39	585
BLB42/45	660
BLB48/51	745

- *Must use filler on adjacent side (not supplied)*
- *Measurements are rounded off to closest 1/8"*

	Act.	Min.	Max	Door	Stile	Open
BLB36/39	27"	36"	41 1/4"	8 3/4"	8"	8"
BLB42/45	39"	42"	47 1/4"	14 7/8"	9"	14"
BLB48/51	48"	48"	52"	19 1/2"	7 1/4"	18 3/4"



DIAGONAL SINK FRONT

ITEM	LIST
DSF36*	205
DSFL36-Q♦	81

- *Tilt Out available on pg. 26*
- *The sink front has a 17" face dimension.*
- ♦ *DSFL36 - The floor must be ordered separately*

Base Cabinets

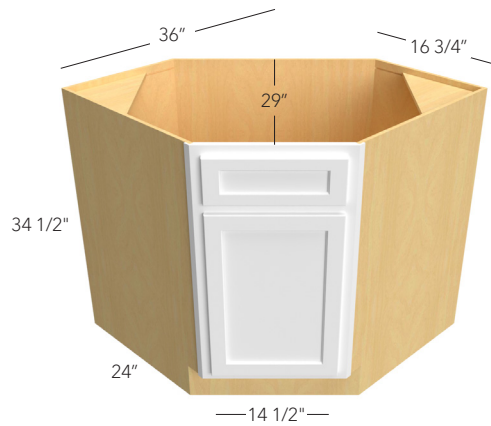

DIAGONAL SINK

ITEM	LIST
DSB36	835
DSB36FD	835

- *Tilt Out available on pg. 26*

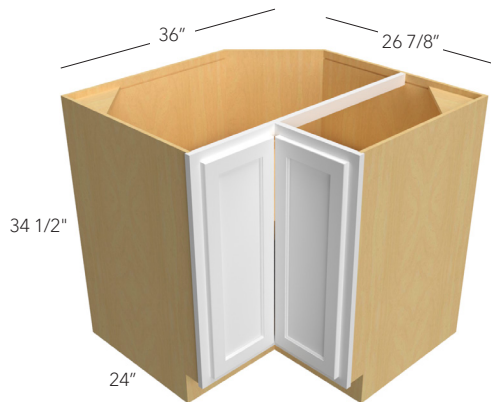

LAZY SUSAN

ITEM	LIST
LSB36	1040

- *Both wooden Lazy Susan trays rotate independently*
- *Center tray is mounted on 15mm (5/8") adjustable shelf*

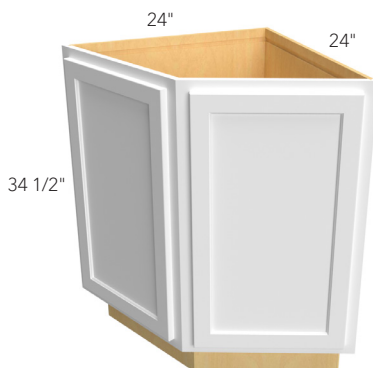

RETURN ANGLE

ITEM	LIST
BRA24	

- *Discontinued items are available in limited quantities while supplies last.*
- *Door width: 15 5/8"*
- *Adjustable shelving*

Base Cabinets



SINK

ITEM	LIST
SB27	480
SB30	500

- *Tilt Out available on pg. 26*



SINK

ITEM	LIST
SB33	520
SB36	530
SB39*	550
SB42*	560

- *Tilt Out available on pg. 26*
- * *Has 3" center stile*



COMBINATION SINK

ITEM	LIST
SB60	800

- *Tilt Out available on pg. 26*

Tall Pantry Cabinets



SINGLE DOOR

ITEM	LIST
TP152484	1055
TP182484	1150
TP152490	1145
TP182490	1210
TP152496	1195
TP182496	1250

- 84" high - 5 shelves
- 90" & 96" high - 6 shelves
- Shelves are 18" deep
- Roll Outs available on pg. 21



DOUBLE DOOR

ITEM	LIST
TP242484	1210
TP242490	1285
TP242496	1335

- 84" high - 5 shelves
- 90" & 96" high - 6 shelves
- Shelves are 18" deep
- Roll Outs available on pg. 21

Vanities



FULL HEIGHT DOOR VANITY BASE

ITEM	LIST
VB24FD	450
VB30FD	480
VB36FD	505



VANITY SINK BASE

ITEM	LIST
VSB24-34	450
VSB30-34	480



VANITY SINK BASE

ITEM	LIST
VSB36-34	505



VANITY DRAWER BASE

ITEM	LIST
VDB12-34	485
VDB15-34	500

ADA Cabinets

* All ADA cabinets have a 4½" toe kick

Discontinuation Notice: ADA Cabinets have been discontinued from Discovery Frost. Limited quantities available while supplies last.

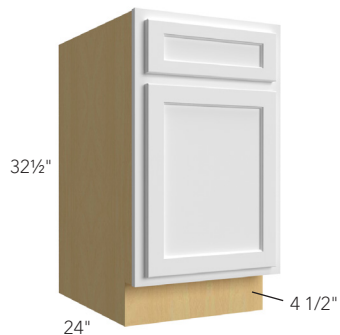

SINGLE DOOR BASE

ITEM	LIST
ADA-B12	395
ADA-B15	410
ADA-B18	440

- Peninsula modification available on pg. VIII
- Roll Outs available on pg. 21

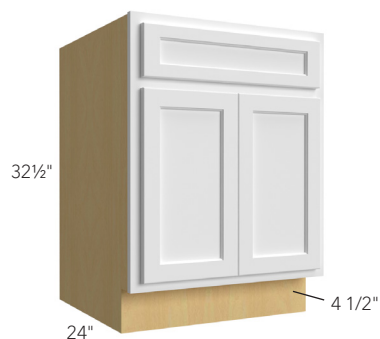

DOUBLE DOOR BASE

ITEM	LIST
ADA-B24	535
ADA-B30	640

- Peninsula modification available on pg. VIII
- Roll Outs available on pg. 21



DOUBLE DOOR & DRAWER BASE

ITEM	LIST
ADA-B36	715

- Peninsula modification available on pg. VIII
- Roll Outs available on pg. 21

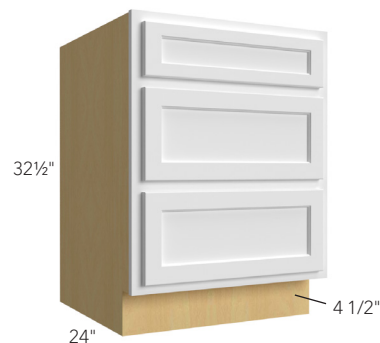

DRAWER BASE

ITEM	LIST
ADA-DB15	620
ADA-DB24	700

ADA Cabinets

* All ADA cabinets have a 4½" toe kick

Discontinuation Notice: ADA Cabinets have been discontinued from Discovery Frost. Limited quantities available while supplies last.



SINK BASE - REMOVABLE FRONT

ITEM	LIST
ADA-SB30-R	645
ADA-SB36-R	695

- Matching interior



VANITY DRAWER BASE

ITEM	LIST
ADA-VDB15	580



VANITY SINK BASE - REMOVABLE FRONT

ITEM	LIST
ADA-VSB30-R	620
ADA-VSB36-R	660

- Matching interior

Waste Solutions / Accessories



TRASH CAN

ITEM	LIST
TC15*	560
TC18	825
TC21	890

- Cabinet not included, cabinet must be ordered separately
 - Full extension slides (not soft-close)
 - 35 qt. can(s) included
 - Not for ADA cabinet use
- * One garbage can and one bags bin



TRASH CAN (W/ BLUM SLIDES)

ITEM	LIST
TC15 BLUM*	1040
TC18 BLUM	1120
TC21 BLUM	1235
TCV15 BLUM♦	945

- Cabinet not included, cabinet must be ordered separately
 - Tandem plus Blumotion full extension concealed drawer runners
 - 2 - 35 qt. cans included
 - Not for ADA cabinet use
- * Single 35 qt. can + one bags bin
♦ Smaller depth for vanity cabinets 21" deep



TRASH CAN FULL HEIGHT DOOR (W/ BLUM SLIDES)

ITEM	LIST
TC15FHD BLUM*	1040
TC21FHD BLUM	1235

- Cabinet not included, cabinet must be ordered separately
 - Tandem plus Blumotion full extension concealed drawer runners
 - 2 - 50 qt. can included
 - Not for ADA cabinet use
 - FULL-DOORS modification is required
- * Single 50 qt. can + one bags bin

Base / Accessories



ROLL OUT (PARTIAL EXTENSION BLUM SLIDES)

ITEM	LIST
ROD-B15 BLUM E	245
ROD-B18 BLUM E	260
ROD-B21 BLUM E	265
ROD-B24 BLUM E	280
ROD-B27 BLUM E	285
ROD-B30 BLUM E	300
ROD-B33 BLUM E	305
ROD-B36 BLUM E	315

- Cabinet not included
 - Price is for a single Roll Out drawer
 - Blumotion partial extension concealed drawer runners
 - Drawers are adjustable
- * Can be used for pantries

Base / Accessories



TWO-TIER COOKWARE ORGANIZER

ITEM	LIST
CWO-B18 BLUM	1435
CWO-B24 BLUM	1660

- Cabinet not included
- Full-extension Blum slides
- Pegboard bottoms
- 4 Press-in pegs included



3" TOWEL BAR PULL OUT

ITEM	LIST
TBPO-BF3	575

- Filler & Overlay Filler are required and need to be ordered separately
- 2 Towel bars
- Single static shelf with chrome wire accents
- UV coated maple wood
- Installed on site
- Installed between two cabinets
- Full-extension, ball-bearing slides with soft-close



SPICE PULL OUT BASE 9"

ITEM	LIST
SPO-B9*	725
SPO-B9 BLUM	1075

- Cabinet not included, cabinet must be ordered separately
- FULL-DOORS modification is required
- Chrome rails
- Adjustable shelves
- UV coated maple wood
- Not for ADA cabinet use
- * Full extension ball-bearing slides (not soft-close)

Base / Accessories



UTENSIL PULL OUT BASE 9" (W/ BLUM SLIDES)

ITEM	LIST
UPO-B9 BLUM	1175

- Cabinet not included, cabinet must be ordered separately
- FULL-DOORS modification is required
- Chrome rails
- Adjustable shelves
- UV coated maple wood
- Not for ADA cabinet use
- Features Blumotion soft-close drawer slides



UTENSIL & KNIFE PULL OUT

ITEM	LIST
UKBPO-B12 BLUM	1615

- Cabinet not included, cabinet must be ordered separately
- FULL-DOORS modification required
- Knife block features flex rod technology that adjust to securely hold knives
- Chrome rails
- Adjustable top shelf
- 2 qt. removable stainless steel bin included
- 4 flexible plastic cutting mats included
- UV coated maple wood
- Not for ADA cabinet use
- Features Blumotion soft-close drawer slides



TRAY DIVIDER PULL OUT BASE 9" (W/ BLUM SLIDES)

ITEM	LIST
TDPO-B9 BLUM	895

- Cabinet not included, cabinet must be ordered separately
- FULL-DOORS modification is required
- UV coated maple wood
- Not for ADA cabinet use
- Features Blumotion soft-close drawer slides

Base & Wall / Accessories



SPICE PULL OUT BASE FILLER

ITEM	LIST
SPO-BF3*	445
SPO-BF6*	505
SPO-BF3 BLUM	780
SPO-BF6 BLUM	925

- Filler required - must be ordered separately
- 30" high Wall Filler recommended instead of Base Filler. Requires toe kick to be built separately.
- Chrome rails
- Adjustable shelves
- UV coated maple wood
- Installed on site
- Installed between two cabinets
- Not for ADA cabinet use

* Full extension ball-bearing slides (not soft-close)

SPICE PULL OUT WALL FILLER

ITEM	LIST
SPO-WF330	505
SPO-WF336	540
SPO-WF342	575
SPO-WF630	580
SPO-WF636	625
SPO-WF642	665

- Filler required - must be ordered separately
- Chrome rails
- Full extension ball-bearing slides (not soft-close - BLUM slides not available)
- Adjustable shelves
- UV coated maple wood
- Installed on-site
- Installed between two cabinets

Wall / Accessories

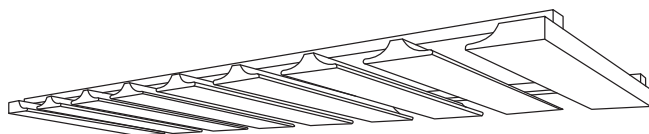

LAZY SUSAN

	ITEM	LIST
PLASTIC	LSP24 30	300
	LSP24 36/42	455
WOOD	LSW24 30	570
	LSW24 36/42	890

- Adjustable metal post
- 42" lazy susan has 3 trays
- 42" poles can be cut to fit 36" high cabinet
- Prepared for installation at job site

STEMWARE RACK

ITEM	LIST
STEMWARE 30	535
STEMWARE 36	565

- Comes unfinished. Product finished per order. May have extended ETA.

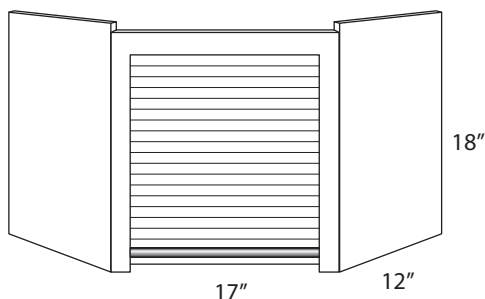

CORNER APPLIANCE GARAGE

ITEM	LIST
APPLIANCE GARAGE	1010

- Comes unfinished. Product finished per order. May have extended ETA.
- Designed to be installed under a diagonal corner wall 24".

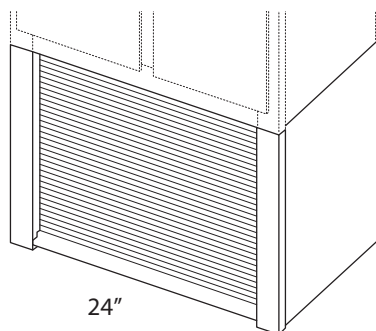

STRAIGHT APPLIANCE GARAGE

ITEM	LIST
APPLIANCE GARAGE 24"	1295

- Product finished per order. May have extended ETA.
- Designed to be placed under a 24" wide wall cabinet.
- Stiles are 2" wide

Sink / Accessories



TILT OUT

ITEM	LIST
TILTOUT 11"	210
TILTOUT 14"	210
TILTOUT 24"	210

- *White plastic tray*

Drawer / Accessories



CUTTING BOARD & KNIFE DRAWER

ITEM	LIST
CBKD-B18 BLUM	895

- For 18" cabinet drawer only
- Replaces the original drawer box of cabinet
- UV coated maple wood
- Up to 4 compartments and built-in knife organizer
- 1 wooden cutting board
- Blumotion full extension concealed drawer runners



CHARGING DRAWER

ITEM	LIST
CHD-B18 BLUM	1485

- For 18" cabinet drawer only
- Replaces the original drawer box of cabinet
- UV coated maple wood
- Blumotion full extension concealed drawer runners
- (2) 120V plugs and (2) 201 amp USB ports
- Tamper resistant outlets
- Max current: AC: 12 amps @ 120VAC; USB 2.1 amp & 5 VDC
- Power cord with NEMA 5 - 15 plug
- Integrated cord guide to ensure safe operation
- Shock absorbent mat, black
- Overall safety of this product is determined by its end use



2-TIER CUTLERY DRAWER

ITEM	LIST
DCD-15 BLUM	470
DCD-18 BLUM	570
DCD-21 BLUM	625
DCD-24 BLUM	660
DCD-30 BLUM	775
DCD-36 BLUM	900

- UV coated maple wood
- Includes complete 3¾" high drawer box
- Blumotion full-extension concealed drawer runners



TRIMMABLE KNIFE DIVIDER

ITEM	LIST
DKI-18/24	280

- UV coated maple wood
- Total height: 2"
- ¾" plywood bottom

Vanity / Accessories



VANITY OUTLET GROOMING ORGANIZER

ITEM	LIST
VGO12FD BLUM	2085

- Cabinet not included, cabinet must be ordered separately
- FULL-DOORS modification required
- 2 removable stainless steel bins included
- 2 shelves with non-skid vinyl lining and acrylic accents
- In-drawer receptacle with (2) 120V plugs
- Tamper-resistant outlets
- Max Current: AC: 12 amps @ 120VAC
- Power cord with NEMA 5 - 15 plug
- Integrated cord guide ensures safe operation
- Drawer stop prevents items from being stored "ON" inside the cabinet
- Its end-use determines the overall safety of this product
- UV coated maple wood
- Not for ADA cabinet use
- Blumotion full extension concealed drawer runners



TRIMMABLE VANITY DRAWER ORGANIZER INSERT

ITEM	LIST
VDO	565

- Designed for 21" or smaller vanity base drawers
- Anti-skid vinyl lining
- Up to 13 compartments
- 2 clear acrylic lids
- UV coated maple wood



VANITY APPLIANCE STORAGE RACK

ITEM	LIST
VASR-30	315

- Designed for 30" vanity base cabinet
- Mounts to inside of right or left door
- Non-skid lining on lower level shelf
- (2) 1.25 qt. stainless steel bins
- UV coated maple wood

Vanity / Accessories



VANITY ORGANIZER PULL OUT

ITEM	LIST
VOPO-24 BLUM	885

- Tandem plus Blumotion full extension drawer runners
- Designed for 24"-30" Vanity Sink Base
- Reversible
- 6 Acrylic bins included



U-SHAPED VANITY SINK BASE PULL OUT

ITEM	LIST
UVTCPO-30 BLUM	865

- Tandem plus Blumotion full extension drawer runners
- Designed for 30" Vanity Sink Base, but works great in standard depth base cabinets as well
- Non-skid vinyl lining
- 4 adjustable dividers
- 8 qt. waste container included

Any accessories can be ordered and installed through Fabuwood



TOUCH UP KIT

ITEM	LIST
TOUCH UP KIT	83

Fillers & Valance / Accessories

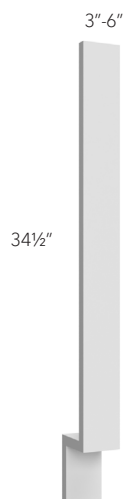
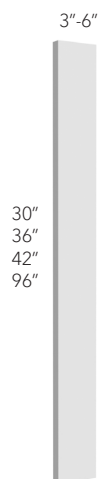

WALL & TALL FILLER

ITEM	LIST
WF330	34
WF336	45
WF342	54
WF630	63
WF636	86
WF642	100
TF396	106
TF696	200

- 2 sides of filler are finished

BASE FILLER

ITEM	LIST
BF3	43
BF6	79

- 2 sides of filler are finished

STRAIGHT VALANCE

ITEM	LIST
VST96	245

Moldings (8') / Accessories

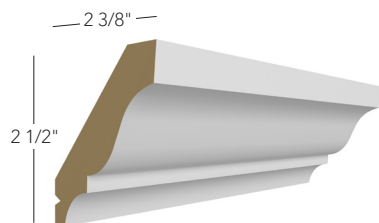

SMALL CROWN

ITEM	LIST
CM-1	160

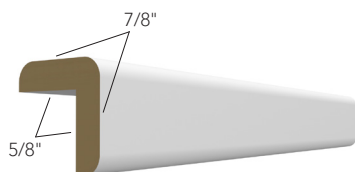

OUTSIDE CORNER

ITEM	LIST
OCM8	83

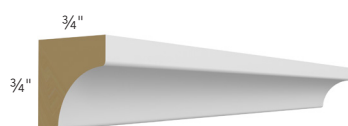

INSIDE CORNER

ITEM	LIST
ICM8	79

Moldings (8') / Accessories



QUARTER ROUND

ITEM	LIST
QRM	83

- Available in Discovery Frost only



SCRIBE

ITEM	LIST
SM8	51



BATTEN

ITEM	LIST
BM3/4	58

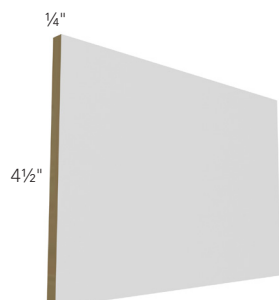

TOE KICK

ITEM	LIST
TK8	73

- Matching color medium-density fiberboard toe kick

Panels / Accessories

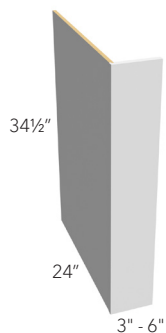

DISHWASHER END PANEL

ITEM	LIST
DWR3	170
DWR6	260

- Sides are flush finished (no 1/4" reveal)

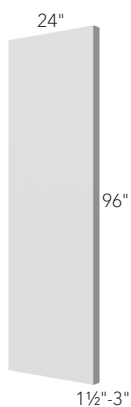

REFRIGERATOR END PANEL WITH RETURN

ITEM	LIST
REP1-1/2	330
REP3	430

- Sides are flush finished (no 1/4" reveal)

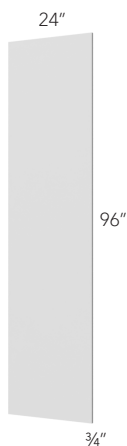

REFRIGERATOR END PANEL

ITEM	LIST
REP2496	390

- Edge banded on both 96" sides.

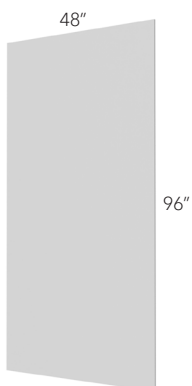

PLYWOOD

ITEM	LIST
PAN-1/4*	350
PLY-1/2	595
PLY-3/4	690

- * MDF panel

Copyright © 2022 by Fabuwood Cabinetry Corp.

All rights reserved.

No part of this publication may be reproduced, distributed, or transmitted in any form or by any means, including photocopying, scanning, or other electronic or mechanical methods, including online sharing, without the prior written permission of Fabuwood Cabinetry Corp.

